

## WallShield IT® Integrated Tape

a mechanically attached, water resistive vapor permeable membrane with integrated tape at the horizontal seams; Product No: 10208905

## WrapFlashing SA

Product No.: 46105590 / 46108090

### Product Description

WallShield IT Integrated Tape water resistive barrier (WRB) membrane protects the building envelope by allowing vapor and air to pass through but not liquid water mitigating costly moisture damage.

### BASIC USE

WallShield IT Integrated Tape is installed above grade behind rain screen wall cladding assemblies. WallShield IT can be also be used as temporary mass timber framework and beam protection

### MATERIALS

WallShield IT Integrated Tape consists of multiple layers of spun-bonded polypropylene fabric with clear integrated horizontal tape and a pre-marked lap template, ensuring accurate horizontal seam installation.

### WALL APPLICATION BENEFITS

**Exceptional building envelope protecting** – cutting-edge drying capacity (123 perms) allows building materials to dry-out, reducing the risk of damage from moisture infiltration, mold, mildew and rot for the life of the building.

**Factory installed clear integrated tape** – seals horizontal seams ensuring the upper layer shingles over the lower layer creating the 6" shingled effect.

**Pre-marked shingle template** – increases installation accuracy.

**Consistent millage thickness** – factory made rolled good ensures consistent properties and performance.

**Fully tested building envelope system** – rough opening flashing accessories eliminate the need for untested outside components.

**Mechanically attaches** – to multiple substrates using VaproCaps™.

**Simple installation** – requires only basic tools, no specialized mobilizations or protection gear are required.

**Install on dry and/or saturated substrates** – eliminates additional water accumulation by locking out liquid water, allowing vapor diffusive drying and helping to "dry-in" the build.

**Spans substrate joint gaps up to 7/8" (22.2mm)**, eliminates need for tapes and fillers.

**Phase construction ready**, install in all temperatures sustains up to 180 days UV and climate exposure prior to cladding installation.

**Emits zero VOCs, no primer required**, ensuring crew safety and a healthy building.

### MASS TIMBER PROTECTION BENEFITS

Temporary protection for framework and beams

**Protects against moisture infiltration**, reducing structural compromise from wetting

**Guards against UV damage**, mold, and wood discoloration

**Cutting-edge drying capacity**, 123 perms, promotes rapid drying

**Durable** and abrasion resistant

**Quickly installs** in all weather conditions

**Easily removed**, reused, or recycled

### Compatible Substrates

- OSB
- Exterior Gypsum Sheathing
- Rigid Insulation
- Precast Concrete
- Concrete Block
- Cast-in-place Concrete
- Plywood
- Pre-painted Steel
- Galvanized Metal
- Aluminum (Painted/Mill Finish)
- Anodized Aluminum
- Vinyl Window and Door Frames
- Fiberglass Window and Door Frames
- Mass Timber

Contact VaproShield Technical – if you have additional substrate questions.

### Technical Data & Environmental

Passed and tested to industry standards for Weather Resistive Barriers.

WallShield IT Integrated tape emits zero VOCs, making the membrane safe for work crews and occupants for the life of the building.

# PRODUCT DATA SHEET

WallShield IT Product No.: 10208905 / WrapFlashing SA, Product No.: 46105590 / 46108090

## Complete Building Envelope System

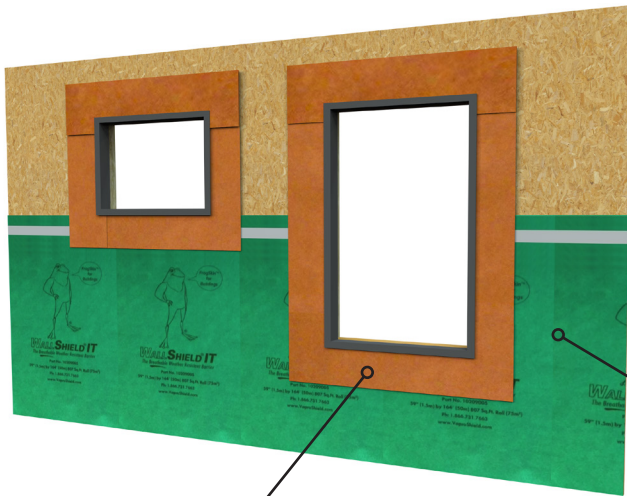

WRB WallShield IT Integrated Tape

### ROUGH OPENING FLASHING OPTIONS

The following rough opening flashing components can be used:

- VaproLiqui-Flash™
- BlockFlashing™ or WrapFlashing SA™
- VaproBond™

Reference individual data sheets for comprehensive information.

| Rough Opening Flashing Membranes   |          |   |  |
|--|----------|---|--|
| Product  | Part No. | Roll Sizes  |  |
|  WrapFlashing SA<br>Self-Adhered Roll | 46105590 | Roll Size: 11 3/4" x 164"<br>(298mm x 50m) 161 S/F (15 S/M) |  |
|  | 46108090 | Roll Size: 19 2/3" x 164"<br>(500mm x 50m) 269 S/F (25 S/M) |  |

### BEST PRACTICE INSTALLATION



Secure membrane with stainless steel staples **above** integrated tape. Align the bottom of the upper course with the dotted line for proper 6" (15 cm) overlap.

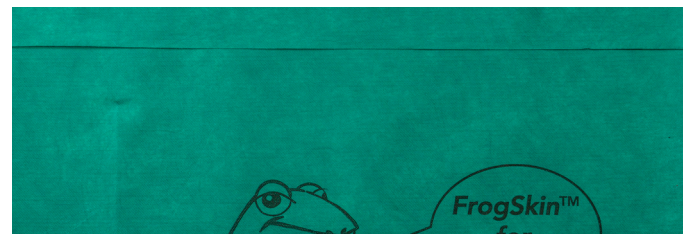

Tape seals horizontal seams. The upper course is properly shingled over the lower course, eliminating water concerns at the horizontal joints.

### BEST PRACTICE VERTICAL SEAMS



Overlap vertical seams by a min. 12". Apply 1/4" (6.4mm) bead of VaproBond adhesive to ensure water and air barrier seal. For complete installation instructions, visit VaproShield.com

### In conjunction with:

| Window and Rough Openings Flashing | VaproLiqui-Flash                   | BlockFlashing                   | VaproBond                         |
|------------------------------------|------------------------------------|---------------------------------|-----------------------------------|
| Application Temperature            | 35°F to 110°F<br>(1.7°C to 43°C)   | 0°F to 180°F<br>(-18°C to 82°C) | 20°F to 120°F<br>(-6.7°C to 49°C) |
| Drying Capacity                    | High                               | None                            | Low                               |
| Breathable Permeability            |                                    |                                 |                                   |
| Application Method                 | Sausage Gun / Putty Knife or Brush | Utility Knife / J-Roller        | Sausage Gun / Putty Knife         |

Visit VaproShield.com to review additional flashing options.



# PRODUCT DATA SHEET

WallShield IT Product No.: 10208905 / WrapFlashing SA, Product No.: 46105590 / 46108090

## Mass Timber Beam and Framework Protection



Durable and abrasion resistant, WallShield IT quickly installs in all weather conditions, and is easily removed, reused or recycled to showcase the beauty of the wood.

WallShield IT (green) protects the mass timber structure against moisture infiltration, reducing structural compromise from wetting.



With a drying capacity of 123 perms, the framework dries out quickly and is less susceptible to ongoing wetting issues from weather events.

### RELATED LEED CREDITS

VaproShield membranes qualify for LEED credits. Visit [VaproShield.com](http://VaproShield.com) for the latest sustainability and LEED information.

### Installation

#### STORAGE AND HANDLING

Store material rolls on end in original packaging. Protect rolls from direct sunlight and inclement weather until ready for use.

#### SAFETY

Work crews are safe around VaproShield membranes. WallShield IT Integrated Tape contains zero VOCs or toxins.

#### PREPARATION

Fill voids and gaps in substrate greater than 7/8 inch (22.2 mm) in width to provide an even surface.

#### WALL BEST PRACTICE INSTALLATION

**Install** WallShield IT with approved fasteners in a horizontal, shingle fashion.

**Horizontal overlaps must be 6"** (15 cm) to properly seal the integrated tape joint.

**Vertical overlaps must be minimum 12"** (30 cm) and require VaproBond adhesive sealant.

**Vertical overlaps are to be staggered** a minimum of 24" (61 cm) and should not occur directly above or below windows or doors.

Visit [VaproShield.com](http://VaproShield.com) to view full installation sequence

**Inside and outside corners can be continuous**, or if a vertical joint occurs within 24" horizontally, an overlap of 12" minimum in both directions is required, providing a double layer at the corner."

Visit [www.VaproShield.com](http://www.VaproShield.com) for complete installation instructions and instructional videos.

#### LIMITATIONS

WallShield IT Integrated Tape should be covered within 180 days of installation.

Do not contaminate WallShield IT Integrated Tape membrane with building site chemicals which make it more wettable (e.g., surfactants). This will adversely affect its water resistance and therefore its contribution to the water resistance of the overall wall system.

Flash fenestrations per window and door manufacturers' recommendations, local building code requirements, ASTM and AAMA guidelines.

If desired adhesion is not attained between membranes due to site conditions, VaproShield recommends applying a bead of VaproBond as an additional solution to pressure rolling.

### Availability

VaproShield products are available throughout North America, Central and South America, and New Zealand.

### Warranty

A 20-year material warranty is available.

# PRODUCT DATA SHEET

WallShield IT Product No.: 10208905 / WrapFlashing SA, Product No.: 46105590 / 46108090

## PHYSICAL PROPERTIES

| PROPERTY                        | RESULT   |
|---------------------------------|--|
| Color                           | Green (top), White (back)                          |
| Thickness                       | 0.56 mm (22 mil)                                   |
| Membrane Weight                 | 191.4 g/m <sup>2</sup> (0.627 oz/ft <sup>2</sup> ) |
| Roll Weight                     | 34 lbs (15 kg)                                     |
| Roll Dimensions                 | 59" x 164' (1.5m x 50m)                            |
| Roll Coverage                   | 807 sq. ft. (75 sq. m.)                            |
| Skid                            | 20 Rolls   |
| VOCs                            | None   |
| Ultra Violet Light Exposure     | 180 days maximum                                   |
| Minimum Application Temperature | Unlimited  |
| Warranty                        | 20 year material warranty                          |
| Service Temperature             | minus 40°F (-40°C) - 183°F (84°C)                  |

## TESTING DATA

| PROPERTY   | STANDARD   | RESULT  |
|--|--|---|
| <b>Strength</b>  |  |   |
| Dry Tensile Strength   | ASTM D882 Standard Test Method for Tensile Properties of Thin Plastic Sheeting   | MD - 6 N/mm (34 lb/in)<br>XMD - 4 N/mm (23 lb/in)                           |
| Dry Breaking Force (Grab method)<br>MD ≥40 XMD ≥35                                   | ASTM D5034 Standard Test Method for Breaking Strength and Elongation of Textile Fabrics (Grab Test)                              | MD – 423 N (95 lbf)<br>XMD – 344 N (77 lbf)                                 |
| Cold Mandrel Bend Test   | AC38 Section 3.3.4   | MD – no cracks PASS<br>XCD – no cracks PASS                                 |
| <b>Water Vapor Transmittance</b>   |  |   |
| Water Vapor Transmission<br>Desiccant Method, Procedure A,<br>24.4°C (76.0°F) 50 %RH | ASTM E96 Standard Test Methods for Water Vapor Transmission of Materials   | 82 Perm (grain/h•ft <sup>2</sup> •inchHg)<br>4692 ng/Pa•s•m <sup>2</sup>    |
| Water Vapor Transmission<br>Desiccant Method, Procedure B,<br>24.4°C (76.0°F) 50 %RH | ASTM E96 Standard Test Methods for Water Vapor Transmission of Materials   | 123 Perm (grains/hr•ft <sup>2</sup> •inchHg)<br>7037 ng/Pa•s•m <sup>2</sup> |
| Water Vapor Transmission<br>Dynamic Relative Humidity<br>Measurement (23°C 50 %RH)   | ASTM E398 Standard Test Method for Water Vapor Transmission Rate of Sheet Materials Using Dynamic Relative Humidity Measurement  | 161 Perm (grain/h•ft <sup>2</sup> •inchHg)<br>9211 ng/Pa•s•m <sup>2</sup>   |
| <b>Water Resistance Testing</b>  |  |   |
| Water Resistance<br>(Control after Weathering)                                       | AATCC 127 Hydrostatic pressure test (550 mm water column for 5 hours),<br>American Association of Textile Chemists and Colorists | Control - No leakage<br>Weathered - No Leakage                              |
| <b>Fire Testing</b>  |  |   |
| Flame Spread<br>Smoke Developed  | ASTM E84 Standard Test Method for Surface Burning Characteristics of Building Materials  | Flame Spread 5<br>Smoke Developed 70  |