

## SlopeShield® Plus Self-Adhered

a highly vapor permeable roofing underlayment Air Barrier (AB) material for use on steep slope roofs: Roll Size: 59" Product No.: 29309000/Roll Size: 29.5" Product No.: 41303400

## SlopeFlashing

Product No.: 41308000

### OVERVIEW

- SlopeShield Plus Self-Adhered roofing underlayment protects the roofing assembly by allowing vapor to pass through (breathable) but not air or liquid — mitigating costly moisture damage and saving energy for the life of the building
- SlopeShield Plus Self-Adhered is installed on steep slope roofs of 2:12 (9.46 degrees) or greater pitch.

### ROOFING SYSTEM COMPATIBILITY

SlopeShield Plus Self-Adhered roofing underlayment can be installed under a variety of roofing systems including:



**Standing Seam Metal Roof**  
*Optional use of VaproShim SA Self-Adhered under metal roof clips creates increased airflow under metal panels.*



**Cedar Shingles/Shakes**  
*With VaproMat™ Drainage Matrix*



**Slate Roof**



**High End Residential**

### COMPATIBLE ROOF DECK SUBSTRATES

- Gypsum/Fiber Roof Sheathing Boards
- Rigid Insulation
- Concrete
- Plywood
- Mass Timber
- Pre-painted Steel
- Galvanized Metal
- Aluminum (Painted/Mill Finish)

\*For OSB and OSB factory-coated products contact VaproShield Technical.

### SUBSTRATE INFORMATION

- Verify that surfaces and conditions are ready to accept the work of this section. Notify [engineer] [architect] [consultant] in writing of any discrepancies.
- Mechanical fasteners used to secure sheathing boards, insulation or penetrate roof deck shall be set flush with surface and fastened into solid backing.
- All surfaces must be clean and dry to the touch and in "as new condition;" sound, clean and free of oil, grease, dirt, or other contaminants.
- Do not install SlopeShield Plus Self-Adhered membrane when ambient temperatures are below 20°F (-6°C)

### DELIVERY, PACKAGING AND STORAGE

- Store roll materials vertically on end in original packaging at temperatures between 40°F and 120°F (4°C - 49°C).
- Protect materials from direct sunlight and inclement weather until ready for use.

# STEEP SLOPE INSTALLATION INSTRUCTIONS

SlopeShield Plus Self-Adhered - Full Width Roll Part No.: 29309000 / SlopeShield Plus Self-Adhered - Half Width Roll Part No.: 41303400

## INSTALLATION BEST PRACTICES

- Primer is NOT required or recommended
- Plan the installation and layout of SlopeShield Plus Self-Adhered PRIOR to application to minimize waste
- Ensure substrate fasteners are flush with surface and fastened into solid backing
- Roll out material with release film intact, check for proper alignment, reposition, and align as required
- Pre-cut SlopeShield Plus Self-Adhered membrane to desired manageable lengths prior to removing release film. At bottom of roof allow for excess material to accommodate wall WRB/AB connects.
- Snap chalk lines for alignment guidance
- Align and place exposed membrane into position use hand pressure to adhere membrane to substrate
- Re-roll material back to starting location with release film intact
- Keep SlopeShield Plus Self-Adhered membrane and release film in contact with deck as you pull the release film.
- Pull release film and smooth out air bubbles with soft bristle push broom
- **Roll underlayment with two-handed roller to ensure proper adhesion to substrate**
- On low slope roofs, below 2:12 (9.46 degrees), VaproShield requires all seams be covered with VaproShield's black, UV stable VaproTape™. VaproTape must be installed in a dry environment to protect against ponding water conditions that may occur in low or no-slope conditions. VaproTape must be rolled with a weighted roller to ensure proper adhesion.
- For all slope conditions, when SlopeShield Plus SA is installed in a vertical fashion—same direction as the slope—VaproTape is required on the vertical seams.
- For steep slope applications, 2:12 and greater pitch, SlopeShield Plus SA may be installed in a shingle fashion, perpendicular to the roof slope, without VaproTape.
- AVOID EXCESSIVE FOOT TRAFFIC on installed SlopeShield Plus Self-Adhered roof underlayment
- Avoid construction material storage on installed SlopeShield Plus Self-Adhered roof underlayment
- For Roofing Penetration Details and to ensure water and air tight details around penetrations (skylights, curbs etc.), refer to VaproShield.com.



### RIBBIT TIP:

To achieve air barrier continuity, review venting requirements for roofing assembly.

## LIMITATIONS

- SlopeShield Plus Self-Adhered should be covered within 180 days (6 months) of installation with permanent roofing material.
- SlopeShield Plus Self-Adhered Roofing Underlayment Sheet may be utilized as temporary water hold out based upon proper installation. Cover membrane as soon as practical with maximum exposure of 180 days (6 months).
- Minimum recommended application temperature of 20°F (- 6.0°C) and rising.
- For roof slopes **below** 2:12 (9.46 degrees) contact VaproShield Technical for required approval.
- If desired adhesion is not attained between membranes due to site conditions, VaproShield recommends applying a bead of VaproBond as an additional solution to pressure rolling.

## SAFETY

- Persons who access any roofs, involved with roof construction, repair or maintenance shall use appropriate personal protective equipment including, but not limited to, hard hats, eye protection, and leather gloves and must be trained on safe practices relevant to their work.
- Where the use of ladders, scaffolds, platforms, or temporary floors are utilized, safety lines and safety harnesses shall be used. Please access the OSHA Web site at [www.osha.gov](http://www.osha.gov), contact your local OSHA office, or visit the local federal bookstore to obtain the most current information on OSHA 29 CFR 1926.

**CAUTION:** Release liners are slippery. To prevent injury, liner should be removed from under foot as soon as membrane is installed and disposed of properly.

## STANDING SEAM METAL ROOF

### Best Practice HORIZONTAL Installation Instructions



1. Ensure sheathing is in "as-new" condition

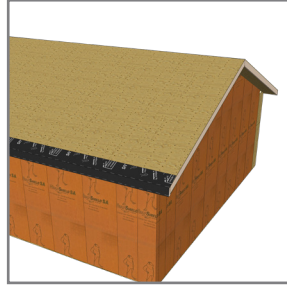

2. Install SlopeFlashing around eaves, extending underlayment down and shingling over wall membrane, if required for air barrier continuity

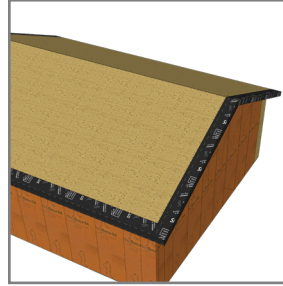

3. Install SlopeFlashing on roof gables, extending underlayment down and shingling over wall membrane, if required for air barrier continuity

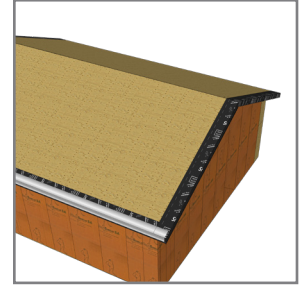

4. Install metal flashing (by others) over SlopeFlashing

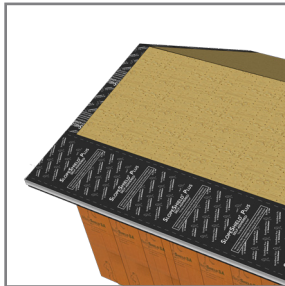

5H. Horizontally install SlopeShield Plus underlayment across roof span starting at the bottom of the roof

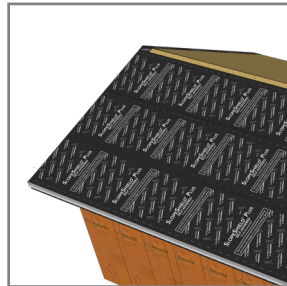

6H. Continue installation maintaining a minimum 3" shingle overlap between runs

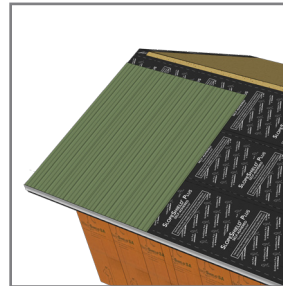

7H. Install roofing material according to manufacturer's installation guidelines



#### RIBBIT TIP:

Verify with the roofing manufacturer if VaproShim SA Self-Adhered (1/8" or 1/4" thick) can be used under metal roof clips to create:

- watertight gasketing
- extra depth for increased air flow within the roof system

Note: **Must be approved by roofing manufacturer.**

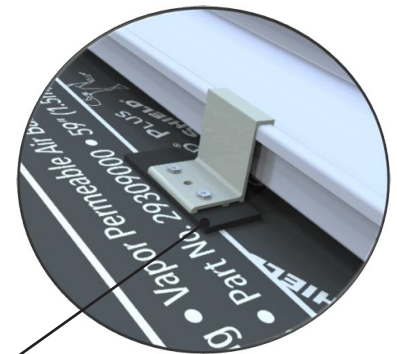

VaproShim SA creates drainage gap beneath roofing materials



## CEDAR SHINGLES/SHAKES WITH VAPROMAT™ DRAINAGE MATRIX

### Best Practice HORIZONTAL Installation Instructions

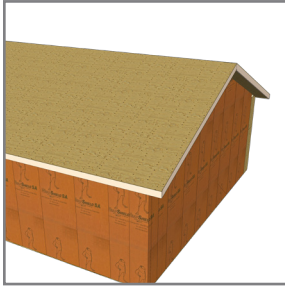

1. Ensure sheathing is in "as-new" condition

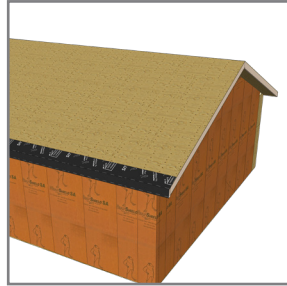

2. Install SlopeFlashing around eaves, extending underlayment down and shingling over wall membrane, if required for air barrier continuity

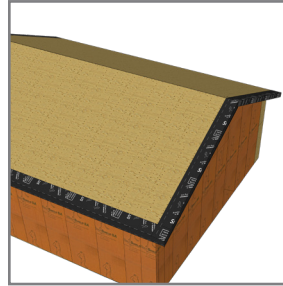

3. Install SlopeFlashing on roof gables, extending underlayment down and shingling over wall membrane, if required for air barrier continuity

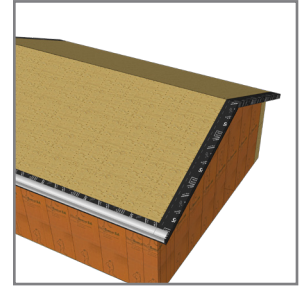

4. Install metal flashing (by others) over SlopeFlashing

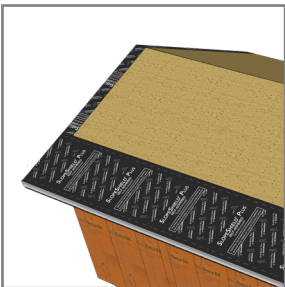

5. Horizontally install SlopeShield Plus underlayment across roof span starting at the bottom of the roof

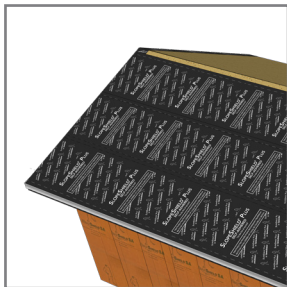

6. Continue installation maintaining a minimum 3" shingle overlap between runs

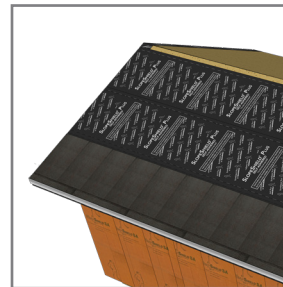

7. Install VaproMat drainage matrix over SlopeShield Plus to create a rain screen

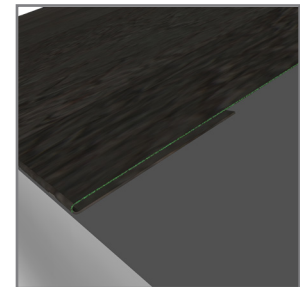

8. Bottom row of VaproMat installed with selfedge folded under for insect infiltration protection

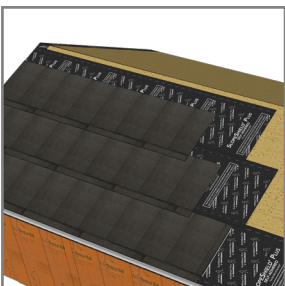

9. Install VaproMat toward the peak of the roof over SlopeShield Plus to maintain shingle effect

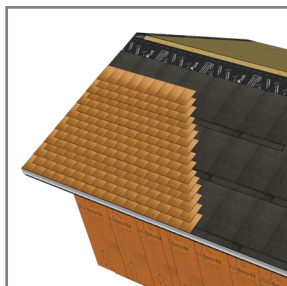

10. Install cedar shingles over VaproMat as per manufacturer's installation guidelines

## PENETRATIONS

For all penetrations: tool VaproLiqui-Flash evenly AT LEAST 2" onto the face and AT LEAST 1" out along all sides of the penetration.

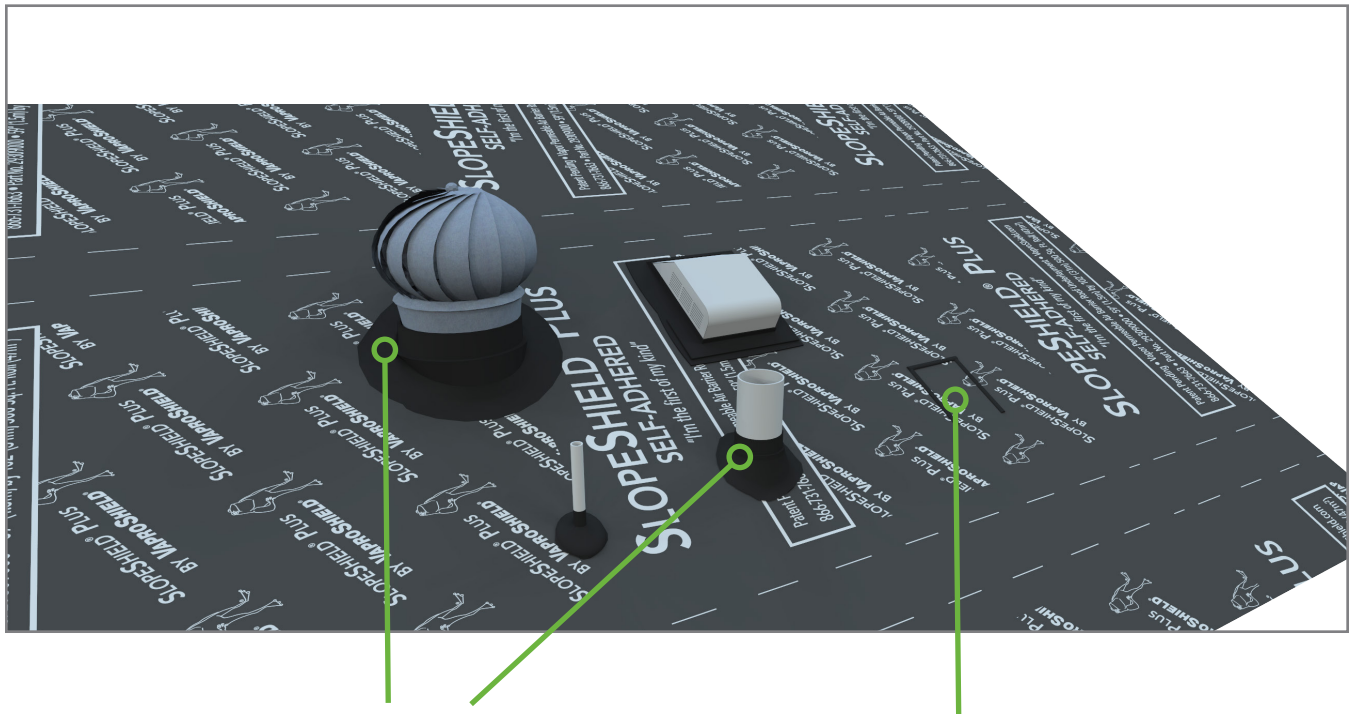

Flanges and fasteners should be completely covered with VaproLiqui-Flash.

Minimum 1" of VaproLiqui-Flash onto flange or pipe penetration.

Membrane patched from misplaced penetration.

VaproLiqui-Flash is applied to top and sides of membrane patch.

# STEEP SLOPE INSTALLATION INSTRUCTIONS

SlopeShield Plus Self-Adhered - Full Width Roll Part No.: 29309000 / SlopeShield Plus Self-Adhered - Half Width Roll Part No.: 41303400

## AIR BARRIER CONTINUITY

**To achieve air barrier continuity, review venting requirements for roofing assembly.**

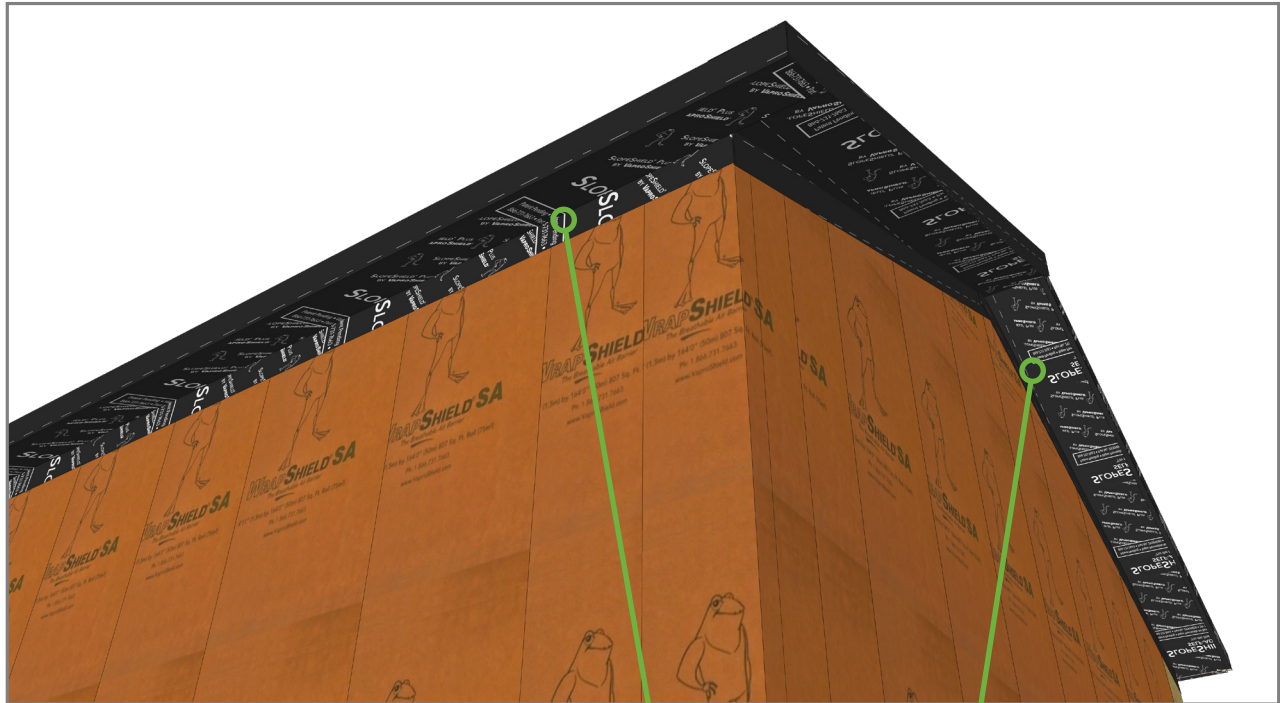

Ensure air barrier continuity by extending the SlopeFlashing around gables and eaves.

### Additional Details and Sequences

Scan QR code for additional sequences and details including field/factory installation or Contact us at 866-731-7663, or email: [technical@vaproshield.com](mailto:technical@vaproshield.com)



### Warranty Information

Scan the QR code to complete a warranty request form.

