

PROJECT PROFILE | LAWRENCE HIGH SCHOOL | LAWRENCE, MA

ARCHITECT

Flansburgh Architects
Boston, Massachusetts
(616) 367-3970

VAPROSHIELD REPRESENTATIVE

Bob McEachern
Hampstead, NH
bmceachern@rtsreps.net.com
(603) 494-3757

INSTALLER

Greenwood Industries, Inc
Millbury, MA
(508) 865-4040

PRODUCT(S)

WALLSHIELD® Water-Resistive Barrier Sheet

PROJECT DESCRIPTION

Over 35,000 sq.ft. of WallShield Water Resistive Barrier Sheet was used on Lawrence High School in Massachusetts.

WallShield was chosen to ensure the wall assembly remained breathable and to promote the long life of the assembly components including the Rheinzink cladding.

WallShield also offers:

- Secondary Rain Barrier
- Zero VOC's, (no off-gassing)
- Low Temperature Applications
- Fire Rated, Class A to ASTM E 84
- 6 Months UV & Climate Exposure
- High Temperature Resistance
- Tough, Durable, Tear Resistant
- Cinches around Fasteners
- Contributes to LEED points

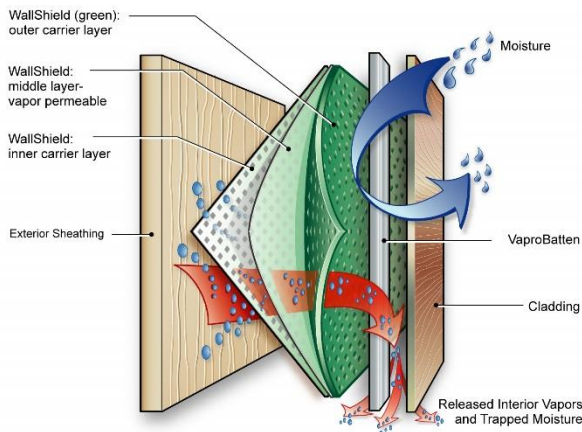

Over 32,000 sq.ft. of WallShield Water Resistive Barrier Sheet was installed on the new high school.



WallShield was installed behind the Rheinzink exterior cladding.

