

## INSTALLATION INSTRUCTIONS

### OVERVIEW

- SlopeShield Plus Self-Adhered roofing underlayment protects the roofing assembly by allowing vapor to pass through (breathable) but not air or liquid — mitigating costly moisture damage and saving energy for the life of the building
- SlopeShield Plus Self-Adhered is installed on steep slope roofs of 2:12 (9.46 degrees) or greater pitch.
- SlopeShield Plus Self-Adhered consists of a spun-bond polyester fabric with proprietary coatings on the top and underside utilizing Vapor Permeable Polymer Composite Technology (VPPCT™). The top coating is slip resistant and UV-stable. The underside is a fully self-adhered adhesive protected by a siliconized release film, which is removed during installation.

### ROOFING SYSTEM COMPATIBILITY

SlopeShield Plus Self-Adhered roofing underlayment can be installed under a variety of roofing systems including:

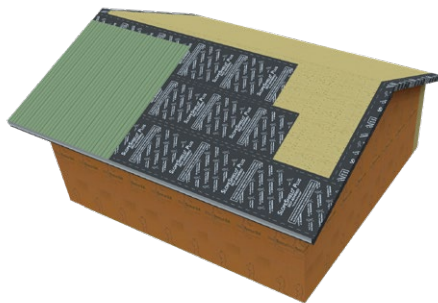

Standing Seam  
Metal Roof

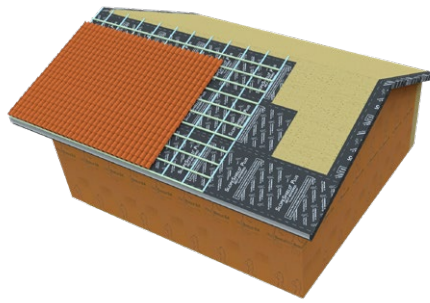

Slate/Clay Tile with Batten/  
Counter-Batten Substructure

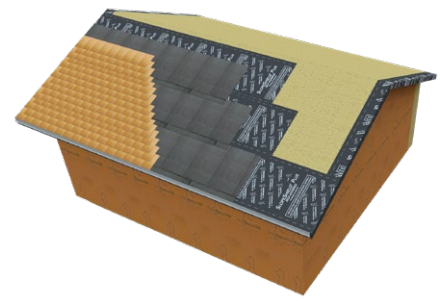

Cedar Shingles/Shakes with  
VaproMat™ Drainage Matrix

### COMPATIBLE ROOF DECK SUBSTRATES

- Gypsum/Fiber Roof Sheathing Boards
  - Rigid Insulation
  - Concrete
  - Plywood
  - Cross Laminated Timber (CLT)
  - Nail Laminated Timber (NLT)
  - Dowel Laminated Timber (DLT)
  - Pre-painted Steel
  - Galvanized Metal
  - Aluminum (Painted/Mill Finish)
- \*For OSB and OSB factory-coated products contact VaproShield Technical.

### SUBSTRATE INFORMATION

- Verify that surfaces and conditions are ready to accept the work of this section. Notify [engineer] [architect] [consultant] in writing of any discrepancies.
- Mechanical fasteners used to secure sheathing boards, insulation or penetrate roof deck shall be set flush with surface and fastened into solid backing.
- All surfaces must be clean and dry to the touch and in "as new condition;" sound, clean and free of oil, grease, dirt, or other contaminants.

## INSTALLATION INSTRUCTIONS

### (SUBSTRATE INFORMATION, CON'T)

- Do not install SlopeShield Plus Self-Adhered membrane when ambient temperatures are below 20°F (-6°C)

### DELIVERY, PACKAGING AND STORAGE

- Store roll materials vertically on end in original packaging at temperatures between 40°F and 120°F (4°C - 49°C).
- Protect materials from direct sunlight and inclement weather until ready for use.

### INSTALLATION BEST PRACTICES

- Primer is NOT required or recommended
- Plan the installation and layout of SlopeShield Plus Self-Adhered PRIOR to application to minimize waste
- Ensure substrate fasteners are flush with surface and fastened into solid backing
- Roll out material with release film intact, check for proper alignment, reposition, and align as required
- Pre-cut SlopeShield Plus Self-Adhered membrane to desired manageable lengths prior to removing release film. At bottom of roof allow for excess material to accommodate wall WRB/AB connects.
- Snap chalk lines for alignment guidance
- Align and place exposed membrane into position use hand pressure to adhere membrane to substrate
- Re-roll material back to starting location with release film intact
- Keep SlopeShield Plus Self-Adhered membrane and release film in contact with deck as you pull the release film.
- Pull release film and smooth out air bubbles with soft bristle push broom
- Roll underlayment with two-handed roller to ensure proper adhesion to substrate
- Install in an overlapping shingle fashion, with the upper courses overlapping the lower courses to shed water down the roof.



### (INSTALLATION BEST PRACTICES, CON'T)

- AVOID EXCESSIVE FOOT TRAFFIC on installed SlopeShield Plus Self-Adhered roof underlayment
- Avoid construction material storage on installed SlopeShield Plus Self-Adhered roof underlayment
- For Roofing Penetration Details and to ensure water and air tight details around penetrations (skylights, curbs etc.), refer to VaproShield.com.



#### RIBBIT TIP:

To achieve air barrier continuity, review venting requirements for roofing assembly.

### LIMITATIONS

- SlopeShield Plus Self-Adhered should be covered within 180 days (6 months) of installation with permanent roofing material.
- SlopeShield Plus Self-Adhered Roofing Underlayment Sheet is not intended to be the primary liquid water hold out system or temporary roof covering. Cover membrane as soon as practical.
- Minimum recommended application temperature of 20°F (- 6.0°C) and rising.
- For roof slopes **below** 2:12 (9.46 degrees) contact VaproShield Technical for required approval.

### SAFETY

- Persons who access any roofs, involved with roof construction, repair or maintenance shall use appropriate personal protective equipment including, but not limited to, hard hats, eye protection, and leather gloves and must be trained on safe practices relevant to their work.
- Where the use of ladders, scaffolds, platforms, or temporary floors are utilized, safety lines and safety harnesses shall be used. Please access the OSHA Web site at [www.osha.gov](http://www.osha.gov), contact your local OSHA office, or visit the local federal bookstore to obtain the most current information on OSHA 29 CFR 1926.

## STANDING SEAM METAL ROOF

### Best Practice HORIZONTAL Installation Instructions



1. Ensure sheathing is in "as-new" condition



2. Install SlopeFlashing around eaves, extending underlayment down and shingling over wall membrane, if required for air barrier continuity

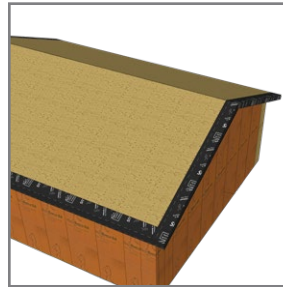

3. Install SlopeFlashing on roof gables, extending underlayment down and shingling over wall membrane, if required for air barrier continuity

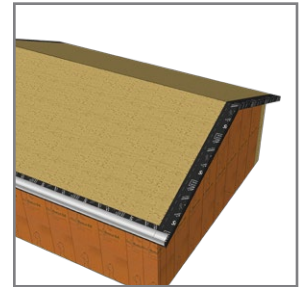

4. Install metal flashing (by others) over SlopeFlashing

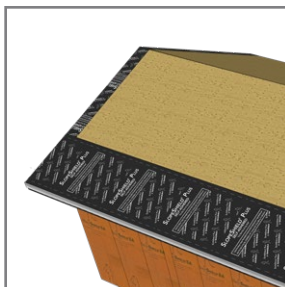

5H. Horizontally install SlopeShield Plus underlayment across roof span starting at the bottom of the roof

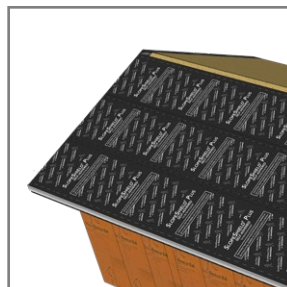

6H. Continue installation maintaining a minimum 3" shingle overlap between runs

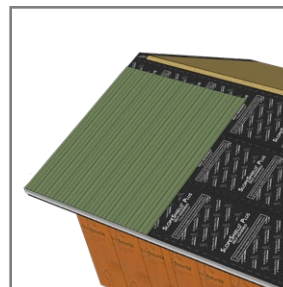

7H. Install roofing material according to manufacturer's installation guidelines



#### RIBBIT TIP:

Verify with the roofing manufacturer if VaproShim SA Self-Adhered (1/8" or 1/4") can be used under metal roof clips to create:

- watertight gasketing
- extra depth for increased air flow within the roof system

Note: **Must be approved by roofing manufacturer.**



## SLATE/CLAY TILE WITH BATTEN/COUNTER-BATTEN SUBSTRUCTURE

### Best Practice **HORIZONTAL** Installation Instructions



1. Ensure sheathing is in "as-new" condition

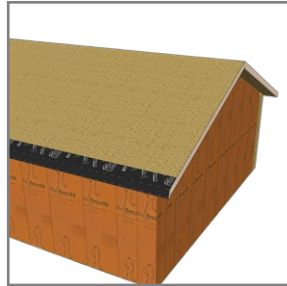

2. Install SlopeFlashing around eaves, extending underlayment down and shingling over wall membrane, if required for air barrier continuity

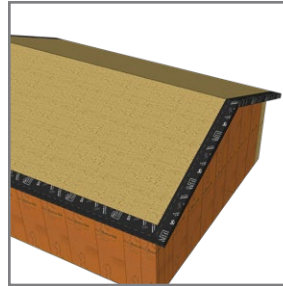

3. Install SlopeFlashing on roof gables, extending underlayment down and shingling over wall membrane, if required for air barrier continuity

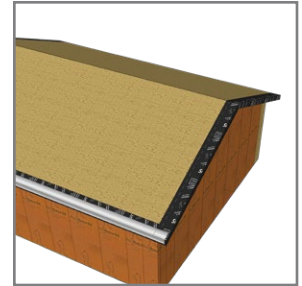

4. Install metal flashing (by others) over SlopeFlashing

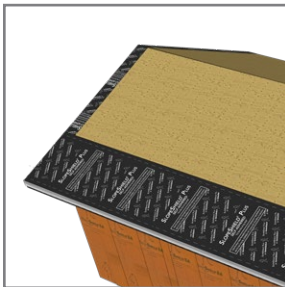

5. Horizontally install SlopeShield Plus underlayment across roof span starting at the bottom of the roof

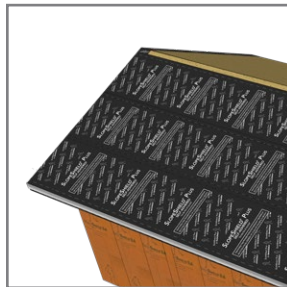

6. Continue installation maintaining a minimum 3" shingle overlap between runs

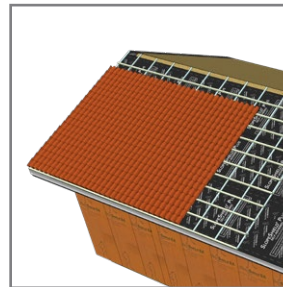

7. Install batten and counter batten roofing system under clay tiles as per manufacturer's installation guidelines



## CEDAR SHINGLES/SHAKES WITH VAPROMAT™ DRAINAGE MATRIX

### Best Practice HORIZONTAL Installation Instructions



1. Ensure sheathing is in "as-new" condition



2. Install SlopeFlashing around eaves, extending underlayment down and shingling over wall membrane, if required for air barrier continuity

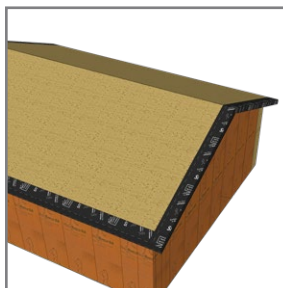

3. Install SlopeFlashing on roof gables, extending underlayment down and shingling over wall membrane, if required for air barrier continuity

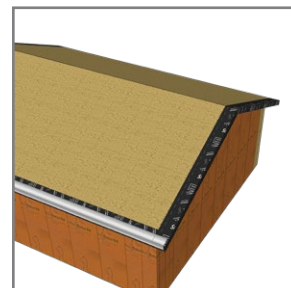

4. Install metal flashing (by others) over SlopeFlashing

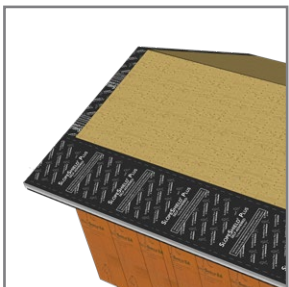

5. Horizontally install SlopeShield Plus underlayment across roof span starting at the bottom of the roof

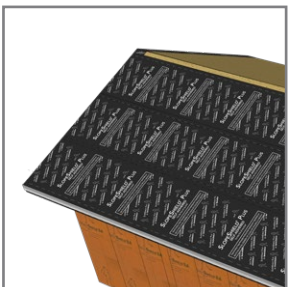

6. Continue installation maintaining a minimum 3" shingle overlap between runs

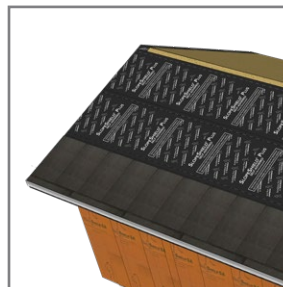

7. Install VaproMat drainage matrix over SlopeShield Plus to create a rain screen

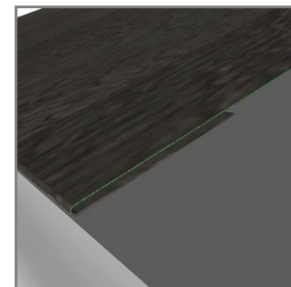

8. Bottom row of VaproMat installed with selfedge folded under for insect infiltration protection

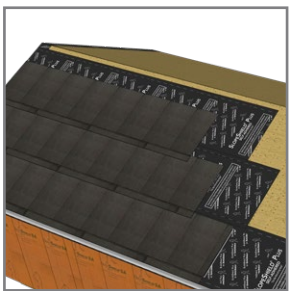

9. Install VaproMat toward the peak of the roof over SlopeShield Plus to maintain shingle effect

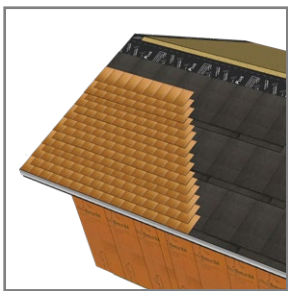

10. Install cedar shingles over VaproMat as per manufacturer's installation guidelines

## PENETRATIONS

For all penetrations: tool VaproLiqui-Flash evenly AT LEAST 2" onto the face and AT LEAST 1" out along all sides of the penetration.

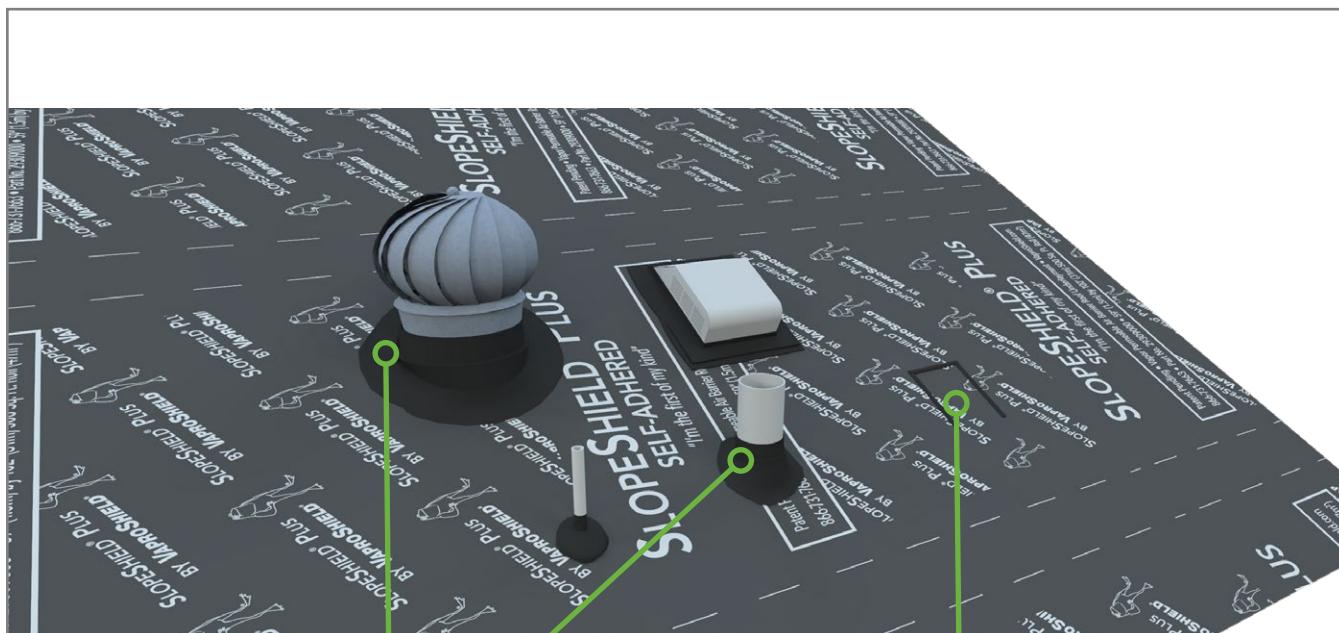

Flanges and fasteners should be completely covered with VaproLiqui-Flash.

Minimum 1" of VaproLiqui-Flash onto flange or pipe penetration.

Membrane patched from misplaced penetration.

VaproLiqui-Flash is applied to top and sides of membrane patch.

## AIR BARRIER CONTINUITY

**To achieve air barrier continuity, review venting requirements for roofing assembly.**

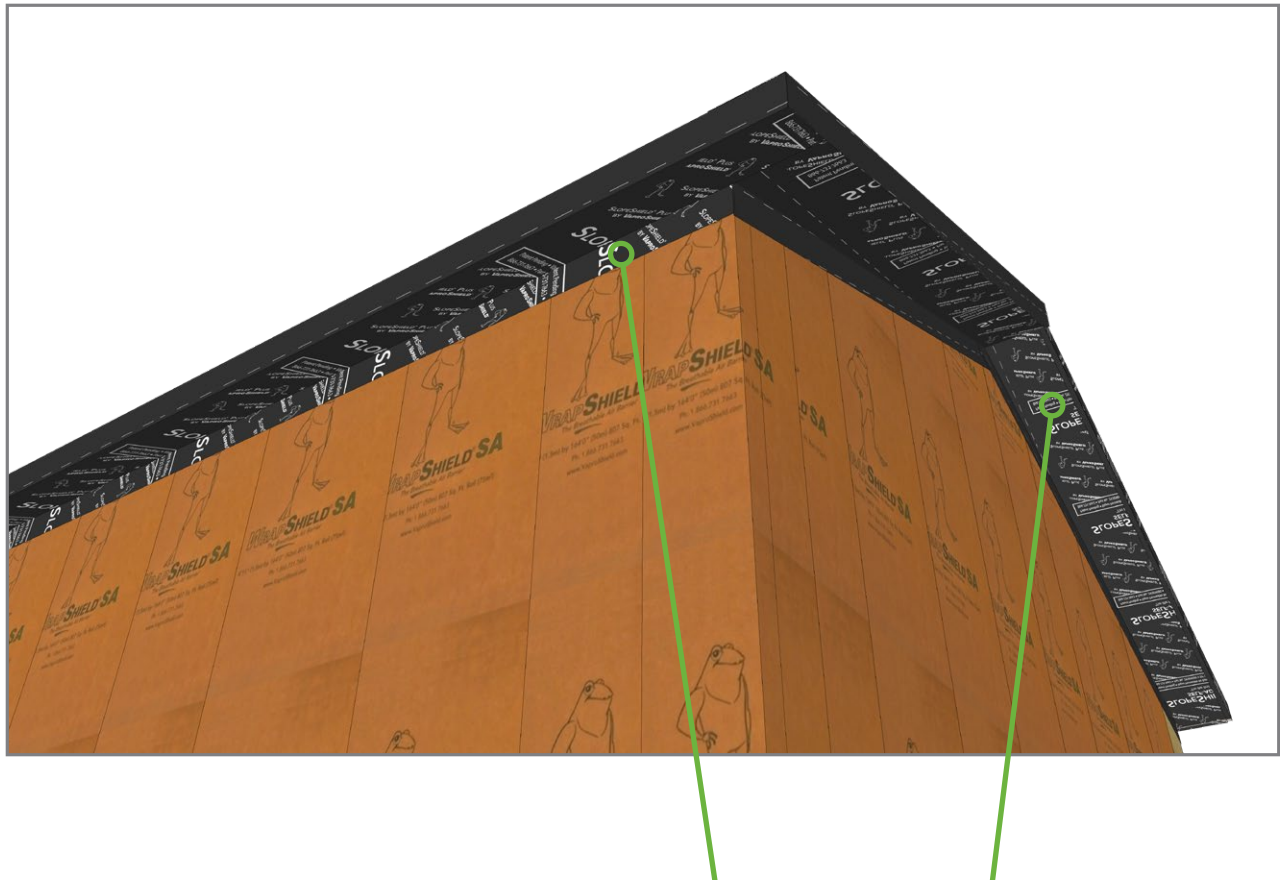

Ensure air barrier continuity by extending the SlopeFlashing around gables and eaves.

## VaproShield LLC 20-Year Product Warranty

**Job #:**

**Purchase Ship Date:**

**Installation Date:**

**Project Name:**

**Address:**

**City/State/Zip:**

**PRODUCT:**

**Owner Name:**

**Address:**

**City/State/Zip:**

**Installer Name**

**Address:**

**City/State/Zip:**

**Date Issued:**

### LIMITED PRODUCT WARRANTY AND DISCLAIMER\*:

#### A) PRODUCTS TO WHICH WARRANTY APPLIES:

VaproShield membranes and roofing underlayments.

#### B) LIMITED WARRANTY:

The VaproShield membranes and roofing underlayments are suited for their intended use as an underlayment, weather resistive barrier or air barrier. VaproShield will warrant its products for a period of twenty (20) years from the date of purchase.

VaproShield will replace any faulty product, provided the product used is installed per the published installation instructions and details. VaproShield installation instructions are provided with the products and/or are available at [www.vaproshield.com](http://www.vaproshield.com), or by calling VaproShield toll free at 1-866-731-7663.

This warranty is transferable upon sale of the project, but in no event does it extend beyond 20 years from the date of original purchase of the product. Any and all claims must be made in writing within 20 business days after the owner discovers or obtains knowledge of any defect in the product(s). VaproShield must be given reasonable opportunity to inspect the allegedly defective product and all damage prior to alteration or removal of the product or any surrounding building components.

All claims must be made in accordance with the claims and inspection procedure noted herein.

This warranty shall not apply to, and VaproShield shall not be liable for, any damages arising in whole or in part from any one or more of the following:

1) VaproShield membranes and roofing underlayments that are not stored or installed in accordance with

VaproShield's installation instructions in effect at the time of the installation.

2) Improper building practices or design not in accordance with the applicable building code or industry standards, or any deviation from approved construction plans or specifications.

3) Damage to VaproShield membranes and roofing underlayments resulting from causes other than normal weather conditions, including impact of falling objects, "Acts of God," earthquakes, hurricanes, flood, fire, hailstorms, high winds, cascading roof/floor water, ponding water, immersion in water, or improper installation of any building component.

4) Defects in the structure or a component of the structure (e.g., window, door, or wall system), premature deterioration of the building materials, or non-standard use of the VaproShield products.

5). Contamination of membrane with building site chemicals including, but not limited to, surfactants or substances that adversely affects its water resistance.

#### OPEN JOINT APPLICATIONS:

VaproShield will warrant material for any open jointed cladding systems when VaproShield's Best Practices, details, and installation instructions (in effect at the time of the installation) are followed.

#### C) DISCLAIMER:

This warranty is limited to product replacement. This warranty is the sole warranty and is being provided in lieu of any other warranties, whether express or implied. Neither VaproShield LLC nor any of its affiliated companies, including product manufacturers, suppliers, representatives or distributors shall be liable for labor costs, consequential damages (such as personal injuries or

damage to property) of any kind, loss of profits, loss of use, or any other damage or injury, whether known or unknown, that is caused or alleged to have been caused in whole or in part by any VaproShield product.

Any deviation from VaproShield's published Best Practices, details, and installation instructions (in effect at the time of the installation) shall void this warranty as to the entire project, unless such deviation was 1) pursuant to a written directive or approval by VaproShield's Technical Team or 2) specified and/or detailed by a qualified architect, engineer, or waterproofing consultant and such deviation is in conformance with all applicable building codes, regulations, and standard good building practices.

The International Building Code (IBC) requires buildings to be designed and constructed so as to prevent water accumulation within the wall assembly, including by installing a water-resistive barrier behind the exterior cladding. In addition, the building should provide a means of draining water to the exterior, unless it is determined that water behind the cladding would not be detrimental to the wall assembly. Conventional, exterior, stucco cladding systems must include an underlying drainage mat and a rainscreen water management system in order to qualify for our standard, 20-year material-only warranty on any VaproShield products used in stucco cladding wall assemblies.

Under no circumstances is a product sales representative, or any other individual or entity, authorized by VaproShield to direct or approve any VaproShield product installation, including but not limited to any deviation from VaproShield's published Best Practices, details, and installation instructions.

This Warranty is not valid unless and until VaproShield product has been paid for in full.