

1. Metal roof panel
2. Treated wood cross batten
3. **SLOPESHIELD® PLUS SELF-ADHERED** roof underlayment (water barrier)
4. **VAPROBOND™** or **VAPROLIQUI-FLASH™** minimum 1 inch (25 mm) onto the penetration and 2 inches (51 mm) onto the **SLOPESHIELD® PLUS SELF-ADHERED**
5. **SLOPESHIELD® PLUS SELF-ADHERED**, air barrier and temporary moisture protection

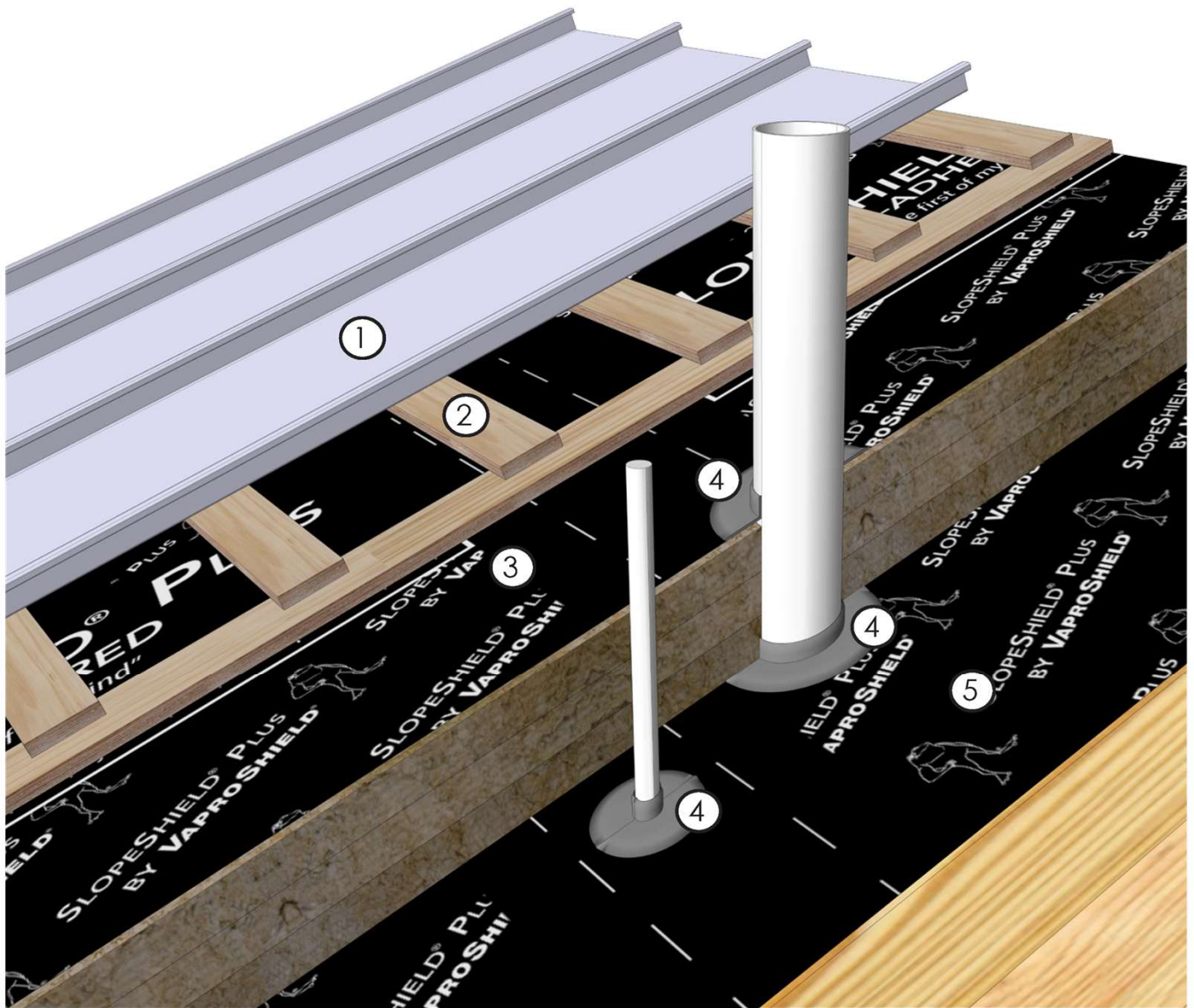

CLT Roof Penetrations



DISCLAIMER

Detail sketch is generic, representing suggested best practices for VaproShield materials, and does not represent a specific job site condition and therefore may not be applicable to certain projects. Detail sketch is designed for use as a reference and must be approved by the designer/consultant of record for each project prior to installation by the subcontractor. Changes and approvals of VaproShield details are the sole responsibility of the designer/consultant of record. VaproShield is not the designer of record for building enclosure details and takes no responsibility for the accuracy or interpretation of actual project site conditions.

DRAWN BY: RDH

DATE: 5/14/19

REF: 228

Always check www.VaproShield.com for the latest details and installation instructions