

1. Sloped sheet-metal coping
2. **VAPRO-SS FLASHING™** over **WRAPFLASHING SA™ SELF-ADHERED**
3. **WRAPSHIELD SA® SELF-ADHERED** or **REVEALSHIELD SA™ SELF-ADHERED**
4. **VAPRO-SS FLASHING™**
5. Roof base flashing, per manufacturer
6. Roof membrane, coverboard, rigid insulation, and air/vapor barrier
7. Structural sheathing over sloped over-framing
8. **SLOPESHIELD® PLUS SELF-ADHERED** temporary moisture protection membrane
9. **VAPROLIQUI-FLASH™** minimum 2 inches (51 mm) onto **SLOPESHIELD® PLUS SELF-ADHERED** and 2 inches (51 mm) onto the CLT wall panel
10. Cladding system

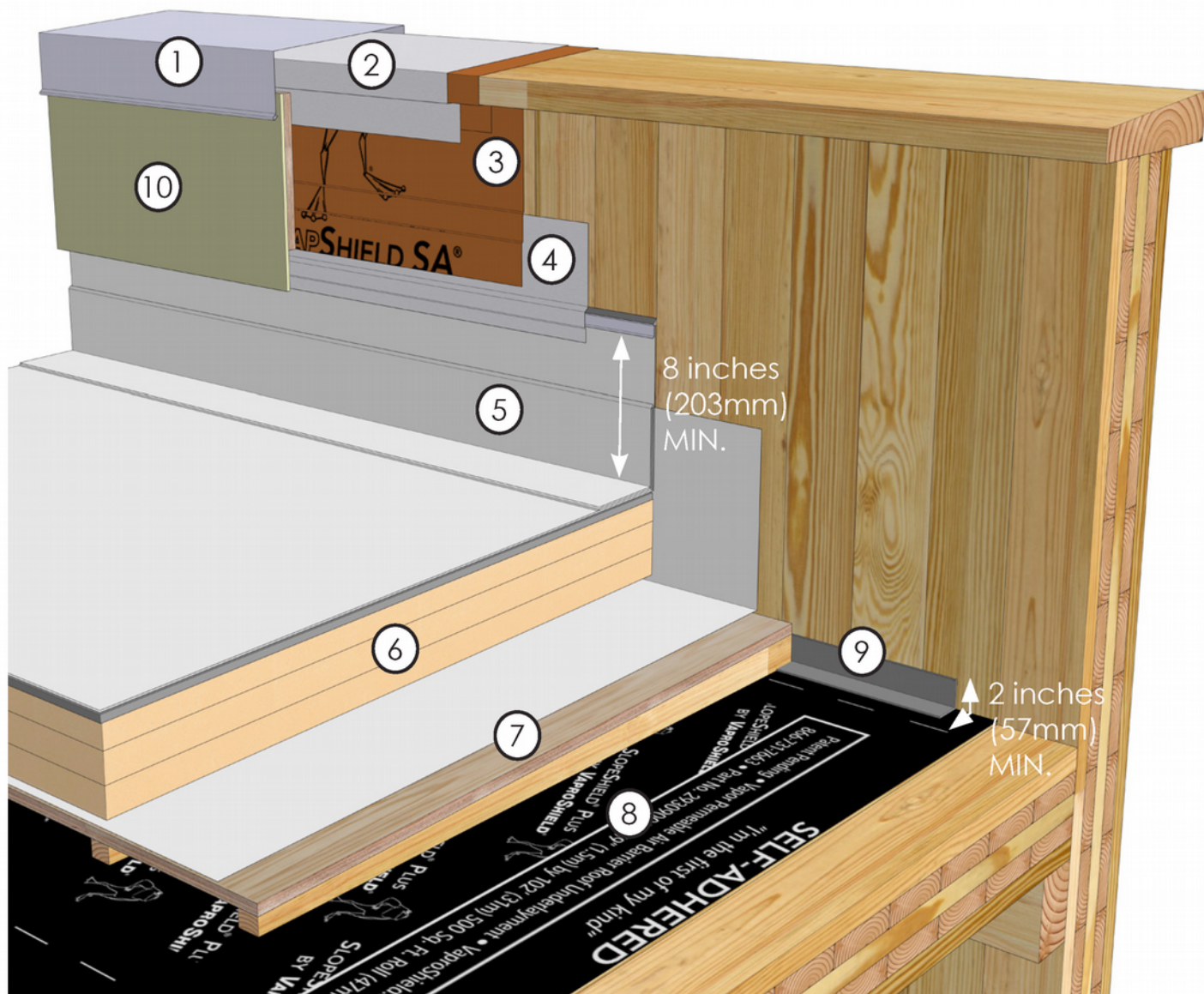

CLT Parapet Detail ($\geq 2:12$ pitch)



DISCLAIMER

Detail sketch is generic, representing suggested best practices for VaproShield materials, and does not represent a specific job site condition and therefore may not be applicable to certain projects. Detail sketch is designed for use as a reference and must be approved by the designer/consultant of record for each project prior to installation by the subcontractor. Changes and approvals of VaproShield details are the sole responsibility of the designer/consultant of record. VaproShield is **not** the designer of record for building enclosure details and takes no responsibility for the accuracy or interpretation of actual project site conditions.

DRAWN BY: RDH

DATE: 12/03/19

REF: 226

Always check www.VaproShield.com for the latest details and installation instructions