

(listed exterior to interior)

1. Metal roof panel
2. Treated wood cross batten
3. **SLOPESHIELD® PLUS SELF-ADHERED** roof underlayment (water barrier)
4. Rigid or semi-rigid mineral fiber insulation between intermittent metal clips
5. **SLOPESHIELD® PLUS SELF-ADHERED** air barrier and temporary moisture protection
6. CLT panel and structure

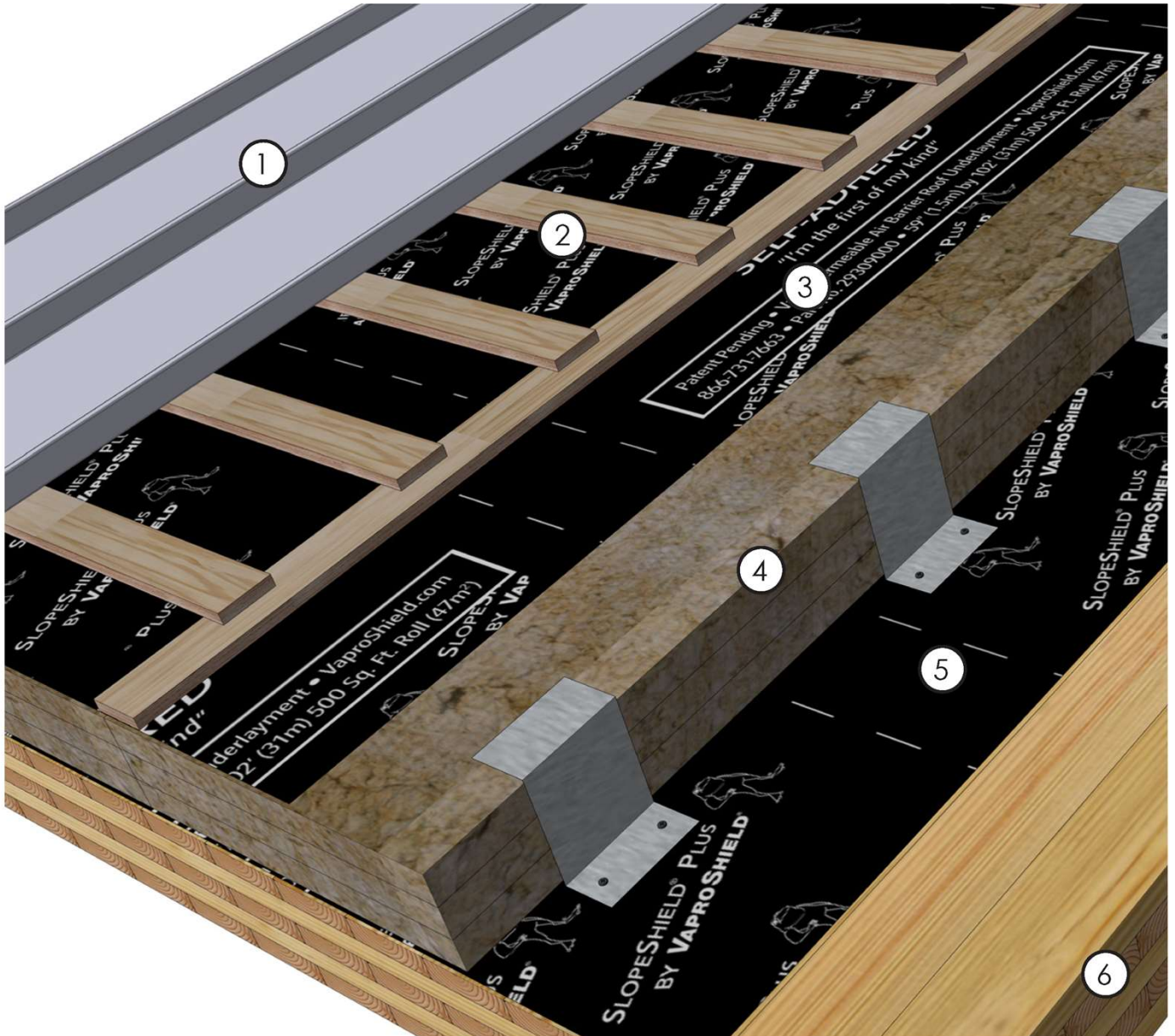

CLT Metal Roof Assembly ($\geq 2:12$ pitch)



DISCLAIMER

Detail sketch is generic, representing suggested best practices for VaproShield materials, and does not represent a specific job site condition and therefore may not be applicable to certain projects. Detail sketch is designed for use as a reference and must be approved by the designer/consultant of record for each project prior to installation by the subcontractor. Changes and approvals of VaproShield details are the sole responsibility of the designer/consultant of record. VaproShield is not the designer of record for building enclosure details and takes no responsibility for the accuracy or interpretation of actual project site conditions.

DRAWN BY: RDH

DATE: 5/14/19

REF: 222

Always check www.VaproShield.com for the latest details and installation instructions