

RevealFlashing SA Self-Adhered scraps adhere to cover pre-punched metal stud holes

Sheathing in "as new" condition

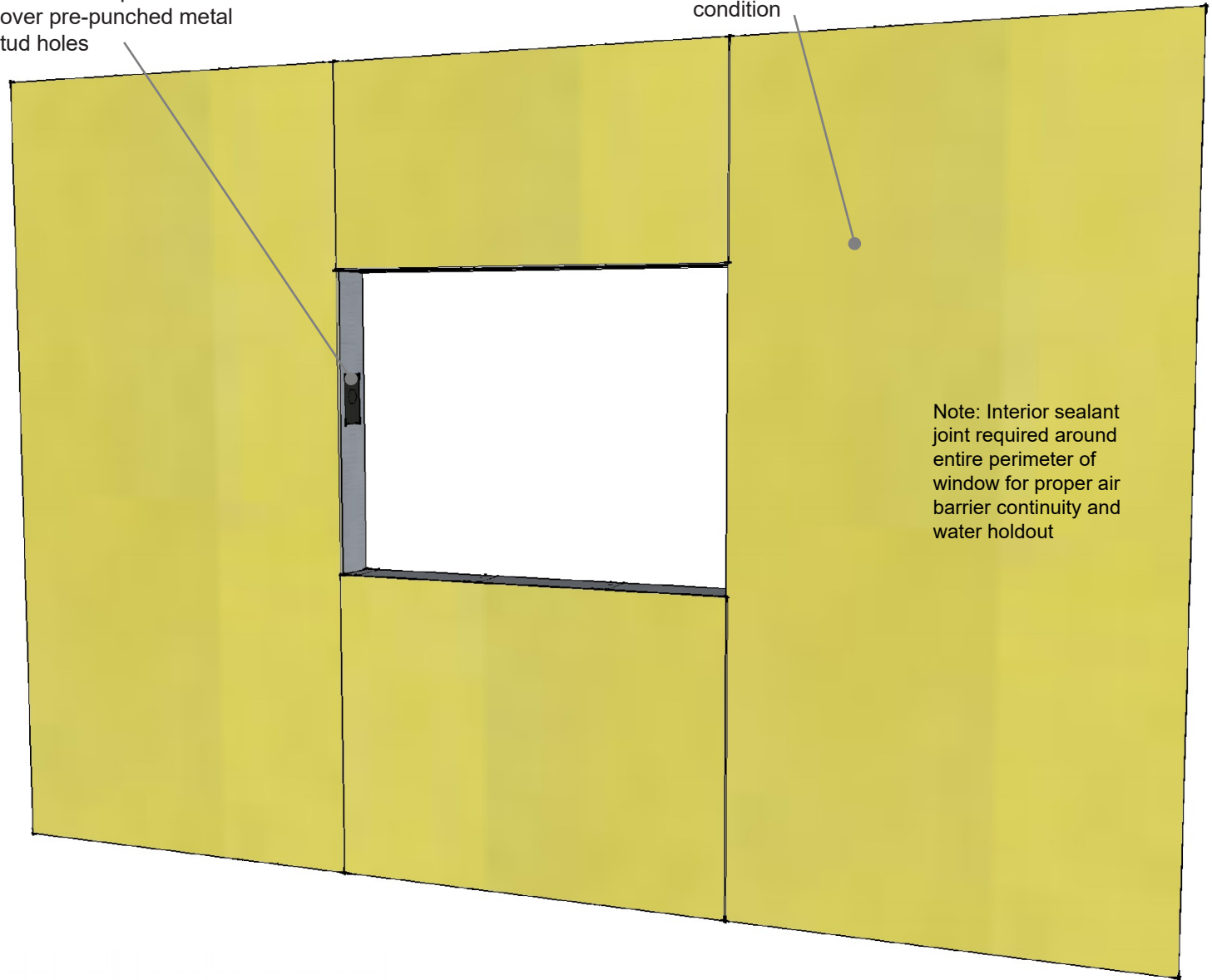

Note: Interior sealant joint required around entire perimeter of window for proper air barrier continuity and water holdout

## VAPROBOND™

Step 1: Inspect rough opening, patch pre-punched holes with RevealFlashing SA

### PRODUCT DESCRIPTION

VaproBond™ is a single component 100% silicone adhesive sealant used to bind layers of VaproShield membranes to each other or typical construction material surfaces. It simplifies the process of producing watertight, airtight details.

### DISCLAIMER

Detail sketch is generic, representing suggested best practices for VaproShield materials, and does not represent a specific job site condition and therefore may not be applicable to certain projects. Detail sketch is designed for use as a reference and must be approved by the designer/consultant of record for each project prior to installation by the subcontractor. Changes and approvals of VaproShield details are the sole responsibility of the designer/consultant of record. VaproShield is **not** the designer of record for building enclosure details and takes no responsibility for the accuracy or interpretation of actual project site conditions.

DRAWN BY: AR

DATE: 06/2017

REF: 196-A

Always check [www.VaproShield.com](http://www.VaproShield.com) for the latest details and installation instructions

## Step 2: Rough Opening Flashing System Commercial Window

RevealFlashing SA Self-Adhered scraps adhere to cover pre-punched metal stud holes

Sheathing in "as new" condition

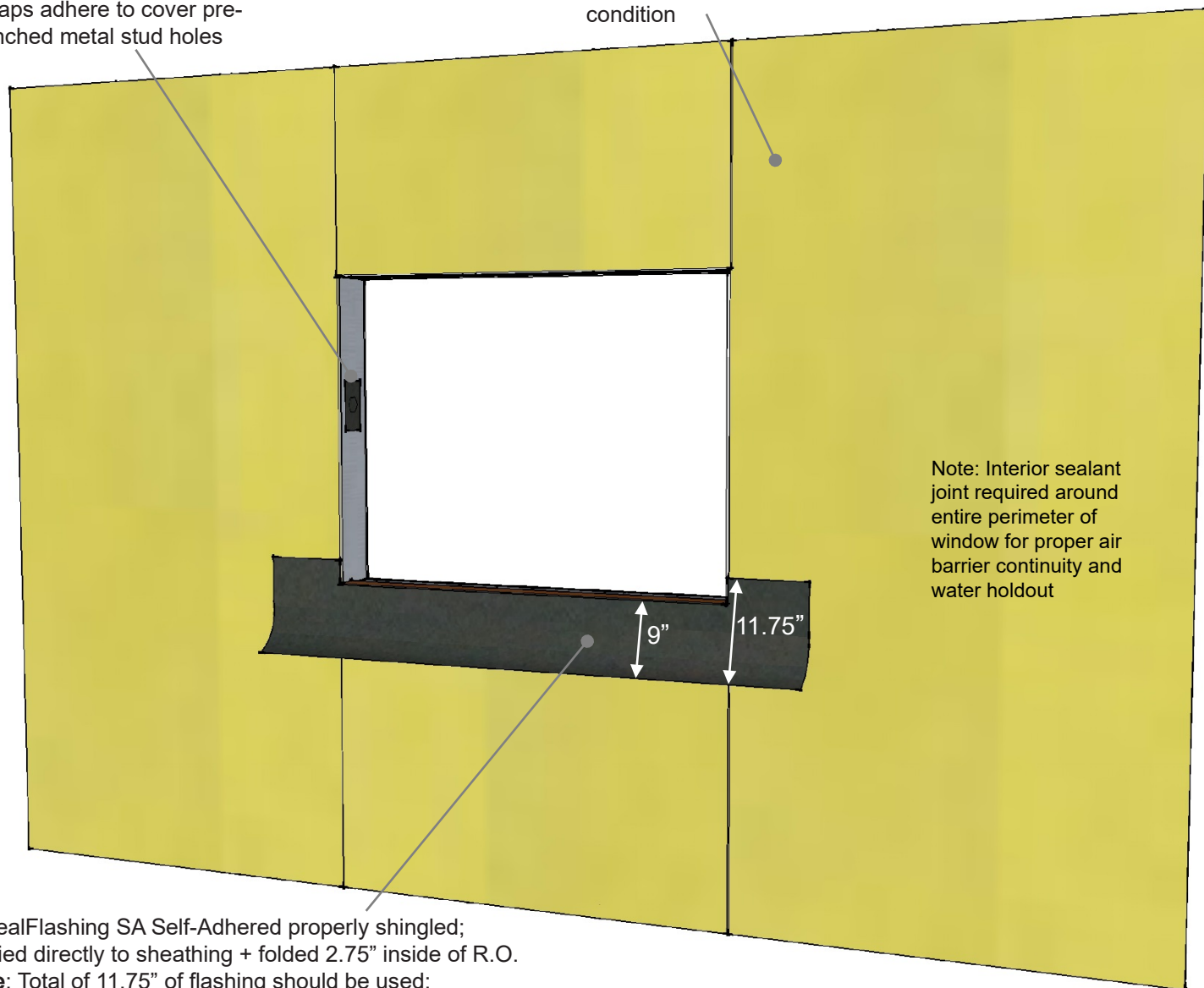

Note: Interior sealant joint required around entire perimeter of window for proper air barrier continuity and water holdout

RevealFlashing SA Self-Adhered properly shingled; applied directly to sheathing + folded 2.75" inside of R.O.

**Note:** Total of 11.75" of flashing should be used:

- 9" of flashing should be left on the face of the sheathing
- 6" of release film from the bottom of the flashing to be left attached for shingling over membrane.

### VAPROBOND™

Step 2: Install RevealFlashing SA into sill with 2.75" folded into R.O. 9" left on face, with bottom 6" of release film to remain attached.

#### PRODUCT DESCRIPTION

VaproBond™ is a single component 100% silicone adhesive sealant used to bind layers of VaproShield membranes to each other or typical construction material surfaces. It simplifies the process of producing watertight, airtight details.

#### DISCLAIMER

Detail sketch is generic, representing suggested best practices for VaproShield materials, and does not represent a specific job site condition and therefore may not be applicable to certain projects. Detail sketch is designed for use as a reference and must be approved by the designer/consultant of record for each project prior to installation by the subcontractor. Changes and approvals of VaproShield details are the sole responsibility of the designer/consultant of record. VaproShield is **not** the designer of record for building enclosure details and takes no responsibility for the accuracy or interpretation of actual project site conditions.

DRAWN BY: AR

DATE: 06/2017

REF: 196-A

Always check [www.VaproShield.com](http://www.VaproShield.com) for the latest details and installation instructions

## Step 3: Rough Opening Flashing System Commercial Window

RevealFlashing SA Self-Adhered scraps adhere to cover pre-punched metal stud holes

Sheathing in "as new" condition

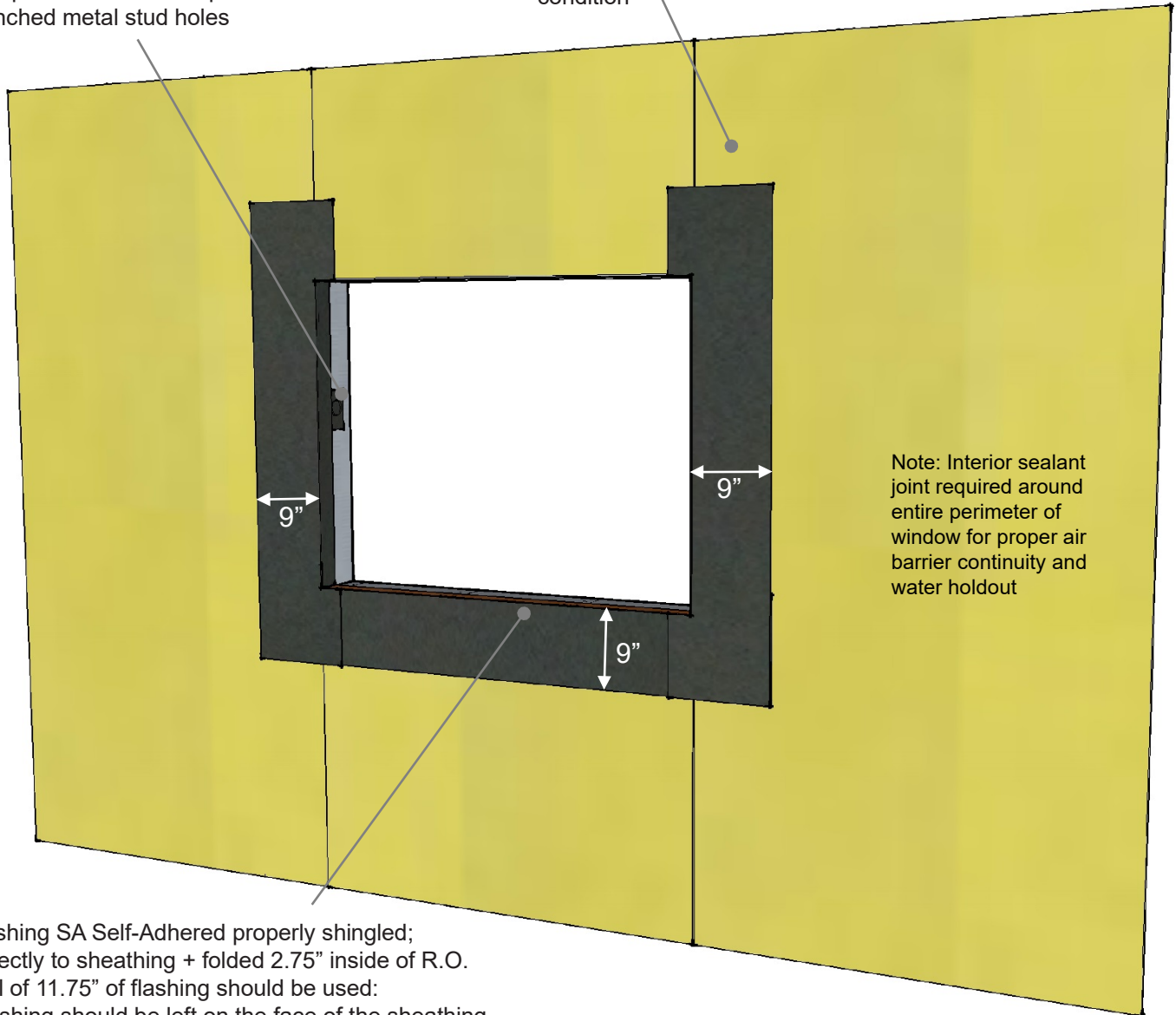

RevealFlashing SA Self-Adhered properly shingled; applied directly to sheathing + folded 2.75" inside of R.O.

**Note:** Total of 11.75" of flashing should be used:

- 9" of flashing should be left on the face of the sheathing
- 6" of release film from the bottom of the flashing to be left attached for shingling over membrane.

### VAPROBOND™

Step 3: Install jamb pieces with 2.75" folded into R.O. 9" to be left on face.

#### PRODUCT DESCRIPTION

VaproBond™ is a single component 100% silicone adhesive sealant used to bind layers of VaproShield membranes to each other or typical construction material surfaces. It simplifies the process of producing watertight, airtight details.

#### DISCLAIMER

Detail sketch is generic, representing suggested best practices for VaproShield materials, and does not represent a specific job site condition and therefore may not be applicable to certain projects. Detail sketch is designed for use as a reference and must be approved by the designer/consultant of record for each project prior to installation by the subcontractor. Changes and approvals of VaproShield details are the sole responsibility of the designer/consultant of record. VaproShield is **not** the designer of record for building enclosure details and takes no responsibility for the accuracy or interpretation of actual project site conditions.

DRAWN BY: AR

DATE: 06/2017

REF: 196-A

Always check [www.VaproShield.com](http://www.VaproShield.com) for the latest details and installation instructions

## Step 4: Rough Opening Flashing System Commercial Window

RevealFlashing SA Self-Adhered scraps adhere to cover pre-punched metal stud holes

Sheathing in "as new" condition

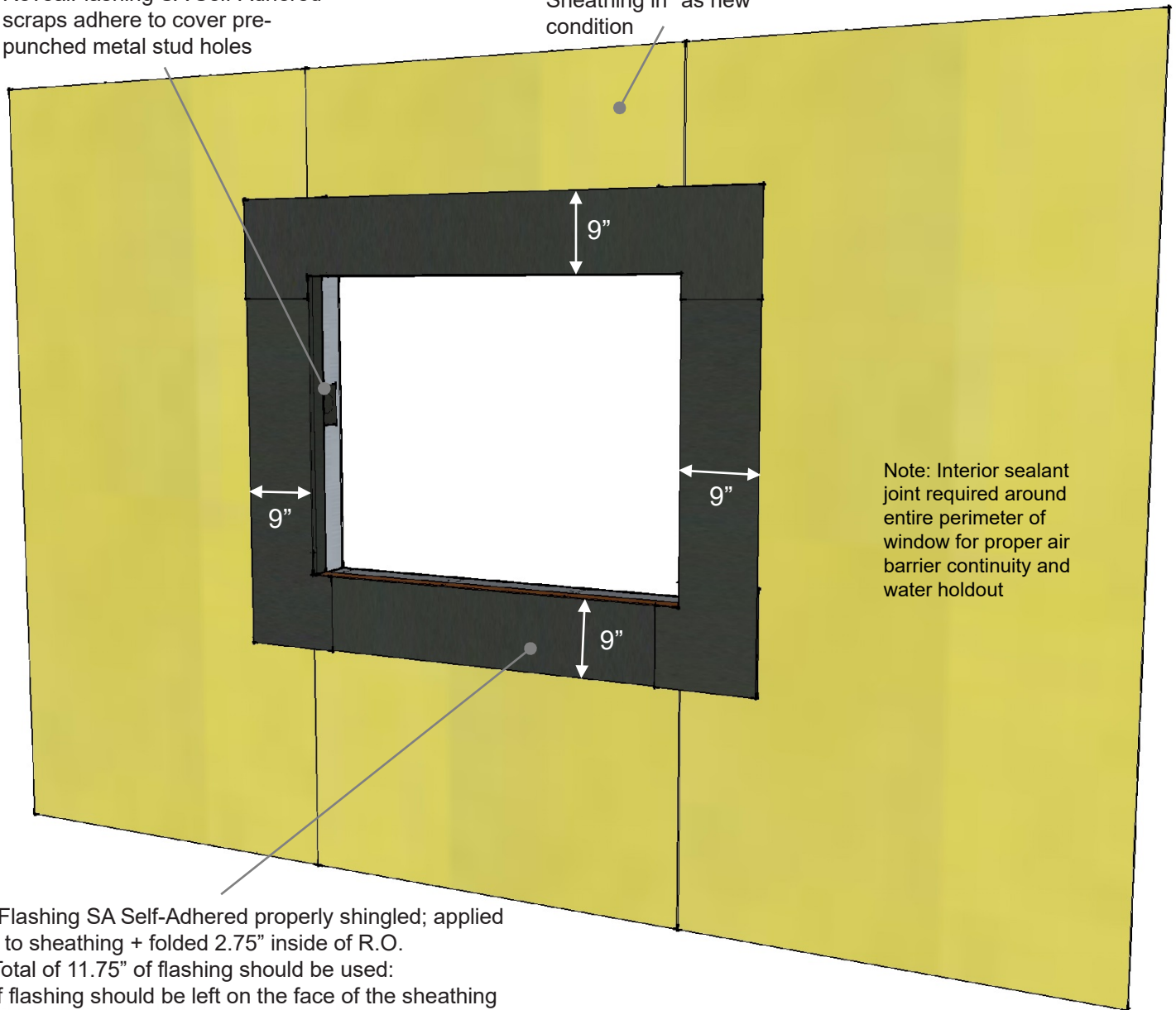

Note: Interior sealant joint required around entire perimeter of window for proper air barrier continuity and water holdout

RevealFlashing SA Self-Adhered properly shingled; applied directly to sheathing + folded 2.75" inside of R.O.

**Note:** Total of 11.75" of flashing should be used:

- 9" of flashing should be left on the face of the sheathing
- 6" of release film from the bottom of the flashing to be left attached for shingling over membrane.

### VAPROBOND™

Step 4: Install head piece with 2.75" folded into R.O. 9" to be left on face.

#### PRODUCT DESCRIPTION

VaproBond™ is a single component 100% silicone adhesive sealant used to bind layers of VaproShield membranes to each other or typical construction material surfaces. It simplifies the process of producing watertight, airtight details.

#### DISCLAIMER

Detail sketch is generic, representing suggested best practices for VaproShield materials, and does not represent a specific job site condition and therefore may not be applicable to certain projects. Detail sketch is designed for use as a reference and must be approved by the designer/consultant of record for each project prior to installation by the subcontractor. Changes and approvals of VaproShield details are the sole responsibility of the designer/consultant of record. VaproShield is **not** the designer of record for building enclosure details and takes no responsibility for the accuracy or interpretation of actual project site conditions.

DRAWN BY: AR

DATE: 06/2017

REF: 196-A

Always check [www.VaproShield.com](http://www.VaproShield.com) for the latest details and installation instructions



## Step 5: Rough Opening Flashing System Commercial Window

VaproBond  
full-coverage inside rough  
opening + 1" on face

Sheathing in "as new"  
condition

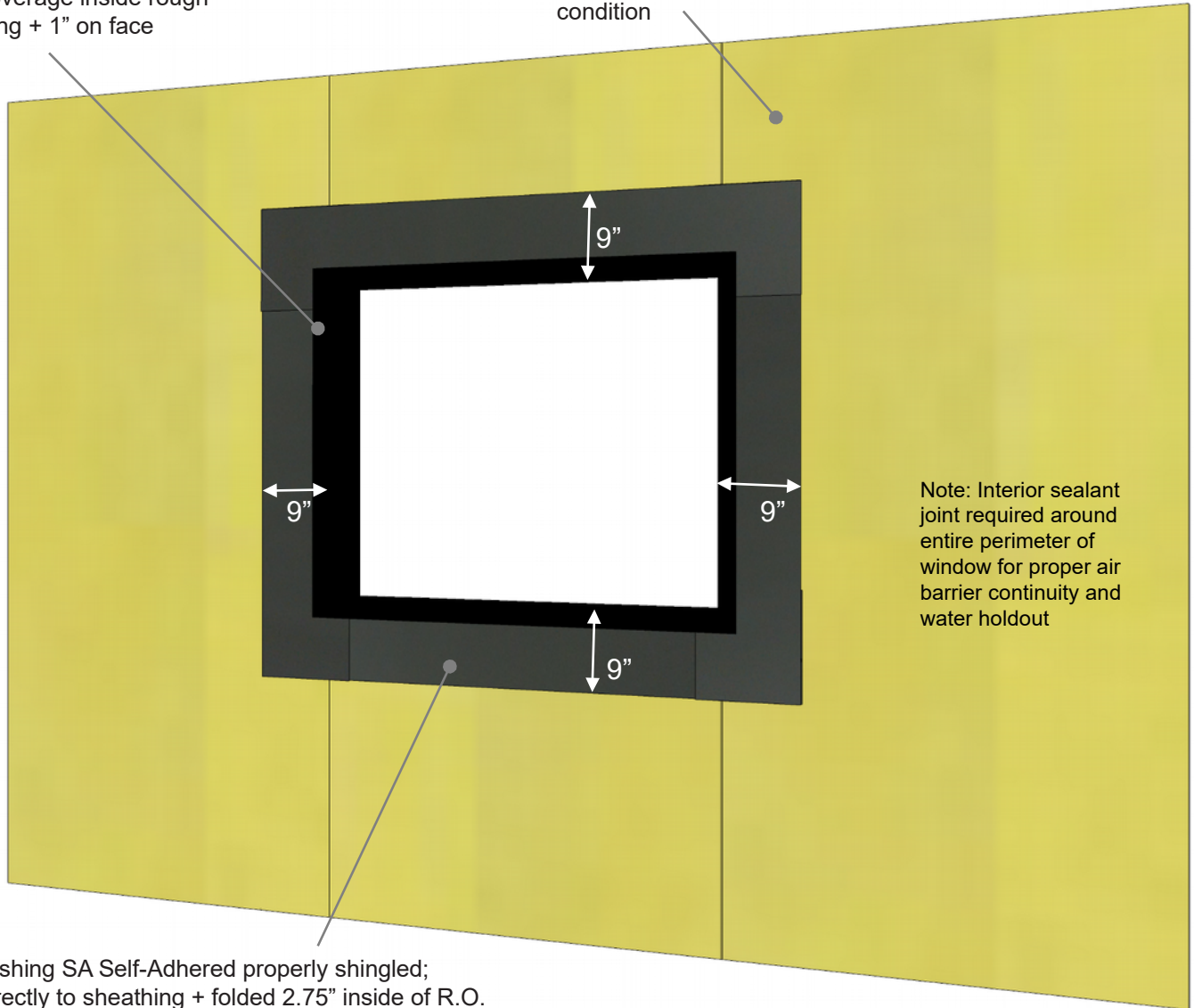

Note: Interior sealant  
joint required around  
entire perimeter of  
window for proper air  
barrier continuity and  
water holdout

RevealFlashing SA Self-Adhered properly shingled;  
applied directly to sheathing + folded 2.75" inside of R.O.

**Note:** Total of 11.75" of flashing should be used:

- 9" of flashing should be left on the face of the sheathing
- 6" of release film from the bottom of the flashing to be left attached for shingling over membrane.

### VAPROBOND™

Step 5: Apply VaproBond to inside  
of R.O. (full coverage) and 1" on  
face

#### PRODUCT DESCRIPTION

VaproBond™ is a single component  
100% silicone adhesive sealant used  
to bind layers of VaproShield  
membranes to each other or typical  
construction material surfaces. It  
simplifies the process of producing  
watertight, airtight details.

#### DISCLAIMER

Detail sketch is generic, representing suggested best  
practices for VaproShield materials, and does not  
represent a specific job site condition and therefore may  
not be applicable to certain projects. Detail sketch is  
designed for use as a reference and must be approved by  
the designer/ consultant of record for each project prior to  
installation by the subcontractor. Changes and approvals  
of VaproShield details are the sole responsibility of the  
designer/consultant of record. VaproShield is **not** the  
designer of record for building enclosure details and takes  
no responsibility for the accuracy or interpretation of actual  
project site conditions.

DRAWN BY: AR

DATE: 06/2017

REF: 196-A

Always check [www.VaproShield.com](http://www.VaproShield.com) for the latest details and installation instructions

## Step 6: Rough Opening Flashing System Commercial Window

VaproBond full-coverage inside rough opening + 1" on face

Commercial Window w/ sealant joint + backer rod (by others)

Sheathing in "as new" condition

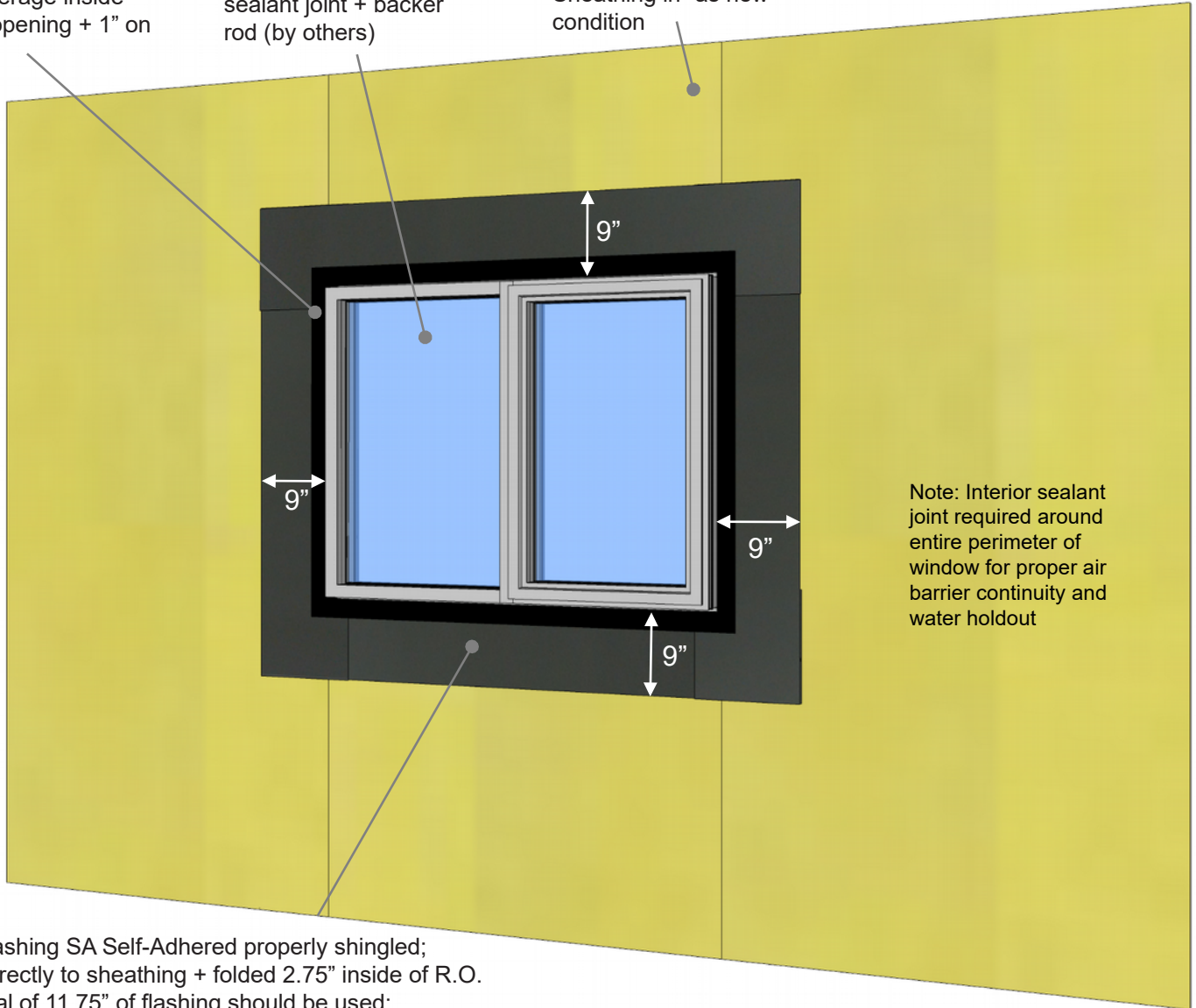

RevealFlashing SA Self-Adhered properly shingled; applied directly to sheathing + folded 2.75" inside of R.O.

**Note:** Total of 11.75" of flashing should be used:

- 9" of flashing should be left on the face of the sheathing
- 6" of release film from the bottom of the flashing to be left attached for shingling over membrane.

Note: Interior sealant joint required around entire perimeter of window for proper air barrier continuity and water holdout

### VAPROBOND™

Step 6: Install commercial window w/ perimeter sealant joint and backer rod (by others)

#### PRODUCT DESCRIPTION

VaproBond™ is a single component 100% silicone adhesive sealant used to bind layers of VaproShield membranes to each other or typical construction material surfaces. It simplifies the process of producing watertight, airtight details.

#### DISCLAIMER

Detail sketch is generic, representing suggested best practices for VaproShield materials, and does not represent a specific job site condition and therefore may not be applicable to certain projects. Detail sketch is designed for use as a reference and must be approved by the designer/consultant of record for each project prior to installation by the subcontractor. Changes and approvals of VaproShield details are the sole responsibility of the designer/consultant of record. VaproShield is **not** the designer of record for building enclosure details and takes no responsibility for the accuracy or interpretation of actual project site conditions.

DRAWN BY: AR

DATE: 06/2017

REF: 196-A

Always check [www.VaproShield.com](http://www.VaproShield.com) for the latest details and installation instructions

## Step 7: Rough Opening Flashing System Commercial Window

Commercial Window w/  
sealant joint + backer  
rod (by others)

Head flashing (by others) fully  
embedded in VaproBond  
over cured VaproBond

Sheathing in "as new"  
condition

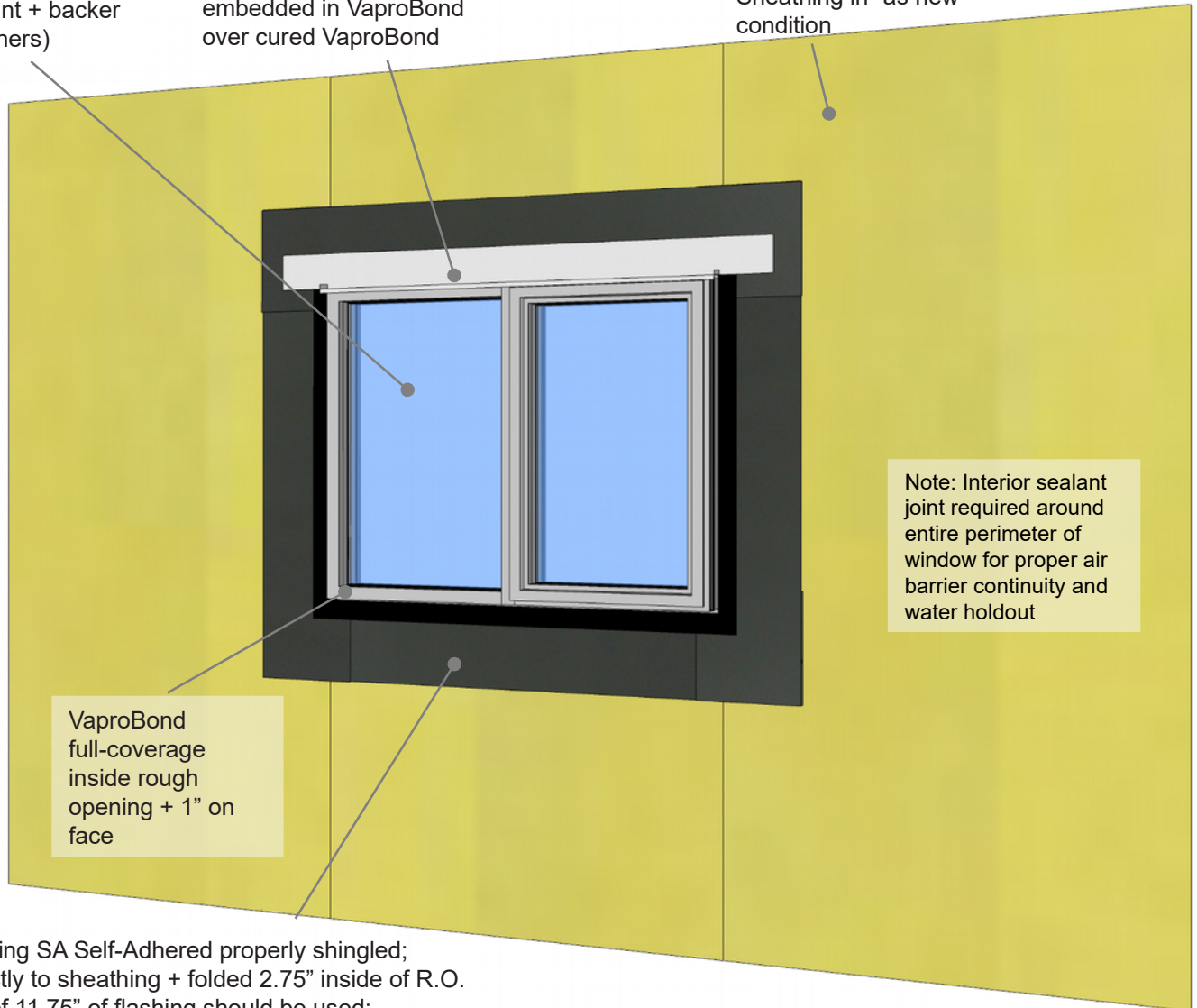

VaproBond  
full-coverage  
inside rough  
opening + 1" on  
face

**Note:** Interior sealant  
joint required around  
entire perimeter of  
window for proper air  
barrier continuity and  
water holdout

RevealFlashing SA Self-Adhered properly shingled;  
applied directly to sheathing + folded 2.75" inside of R.O.

**Note:** Total of 11.75" of flashing should be used:

- 9" of flashing should be left on the face of the sheathing
- 6" of release film from the bottom of the flashing to be left attached for shingling over membrane.

### VAPROBOND™

Step 7: Install metal head flashing  
(by others) fully embedded in  
VaproBond over cured VaproBond

#### PRODUCT DESCRIPTION

VaproBond™ is a single component 100% silicone adhesive sealant used to bind layers of VaproShield membranes to each other or typical construction material surfaces. It simplifies the process of producing watertight, airtight details.

#### DISCLAIMER

Detail sketch is generic, representing suggested best practices for VaproShield materials, and does not represent a specific job site condition and therefore may not be applicable to certain projects. Detail sketch is designed for use as a reference and must be approved by the designer/ consultant of record for each project prior to installation by the subcontractor. Changes and approvals of VaproShield details are the sole responsibility of the designer/consultant of record. VaproShield is **not** the designer of record for building enclosure details and takes no responsibility for the accuracy or interpretation of actual project site conditions.

DRAWN BY: AR

DATE: 06/2017

REF: 196-A

Always check [www.VaproShield.com](http://www.VaproShield.com) for the latest details and installation instructions



## Step 8: Rough Opening Flashing System Commercial Window

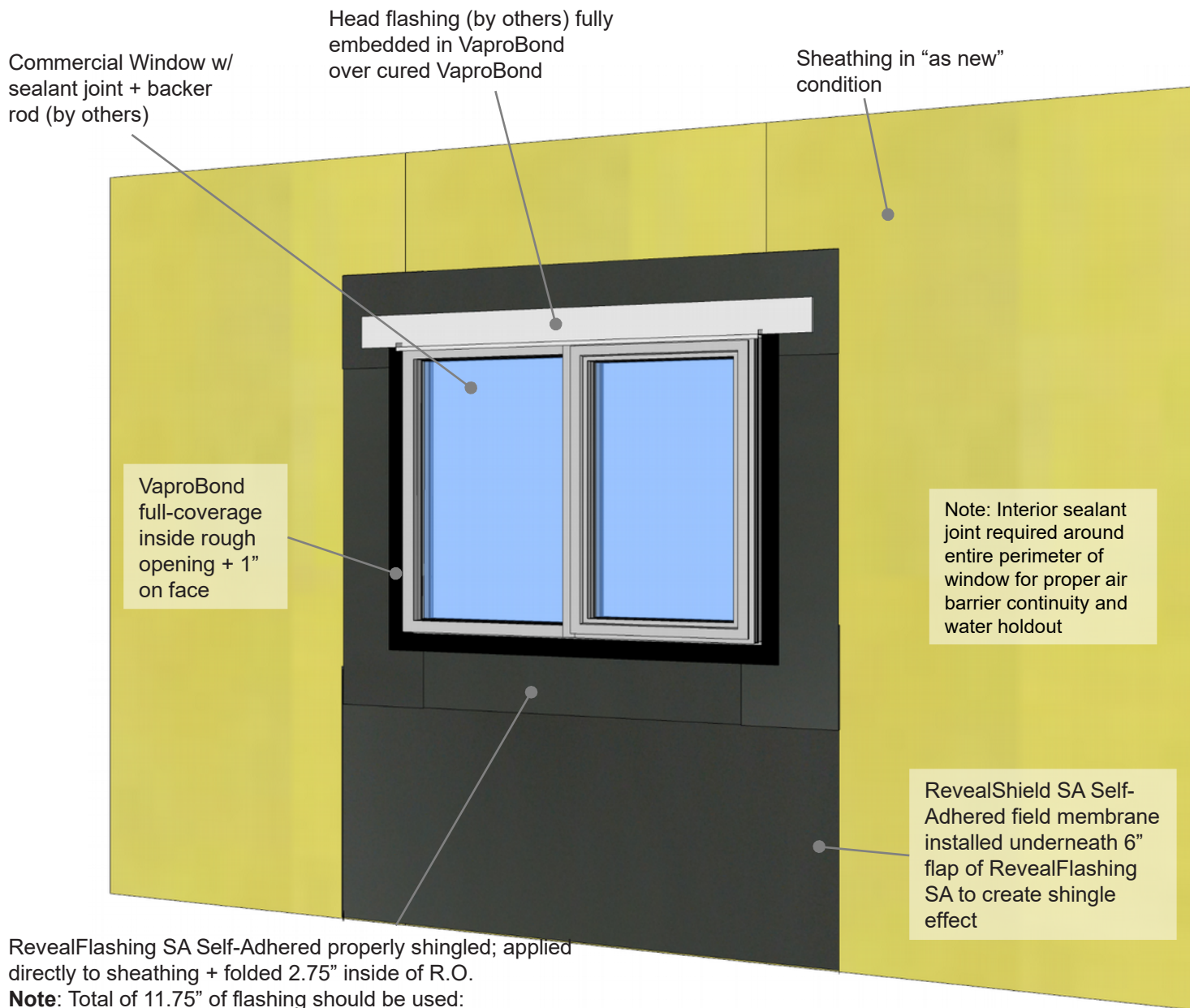

RevealFlashing SA Self-Adhered properly shingled; applied directly to sheathing + folded 2.75" inside of R.O.

**Note:** Total of 11.75" of flashing should be used:

- 9" of flashing should be left on the face of the sheathing
- Remove release film from flashing and adhere bottom 6" to field membrane.

### VAPROBOND™

Step 8: Install field membrane underneath 6" flap of sill flashing to create shingle effect, remove release film, adhere to membrane

#### PRODUCT DESCRIPTION

VaproBond™ is a single component 100% silicone adhesive sealant used to bind layers of VaproShield membranes to each other or typical construction material surfaces. It simplifies the process of producing watertight, airtight details.

#### DISCLAIMER

Detail sketch is generic, representing suggested best practices for VaproShield materials, and does not represent a specific job site condition and therefore may not be applicable to certain projects. Detail sketch is designed for use as a reference and must be approved by the designer/ consultant of record for each project prior to installation by the subcontractor. Changes and approvals of VaproShield details are the sole responsibility of the designer/consultant of record. VaproShield is **not** the designer of record for building enclosure details and takes no responsibility for the accuracy or interpretation of actual project site conditions.

DRAWN BY: AR

DATE: 06/2017

REF: 196-A

Always check [www.VaproShield.com](http://www.VaproShield.com) for the latest details and installation instructions



## Step 9: Rough Opening Flashing System Commercial Window

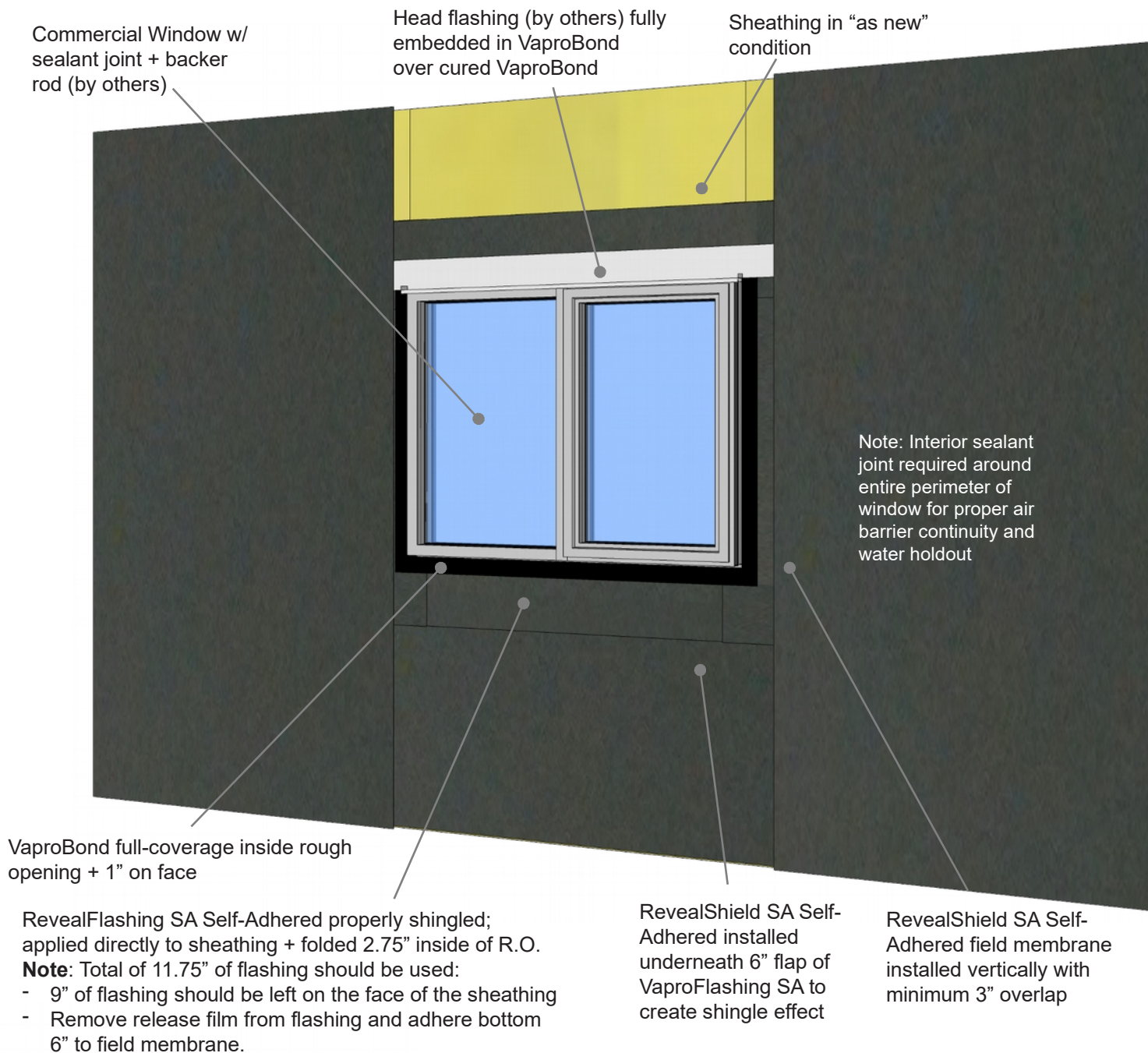

### **VAPROBOND**<sup>™</sup>

Step 9: Install field membrane vertically to sheathing, maintaining 3" minimum overlap with R.O. flashing

DRAWN BY: AR

DATE: 06/2017

#### PRODUCT DESCRIPTION

VaproBond<sup>™</sup> is a single component 100% silicone adhesive sealant used to bind layers of VaproShield membranes to each other or typical construction material surfaces. It simplifies the process of producing watertight, airtight details.

#### DISCLAIMER

Detail sketch is generic, representing suggested best practices for VaproShield materials, and does not represent a specific job site condition and therefore may not be applicable to certain projects. Detail sketch is designed for use as a reference and must be approved by the designer/ consultant of record for each project prior to installation by the subcontractor. Changes and approvals of VaproShield details are the sole responsibility of the designer/consultant of record. VaproShield is **not** the designer of record for building enclosure details and takes no responsibility for the accuracy or interpretation of actual project site conditions.

# Step 10: Rough Opening Flashing System Commercial Window

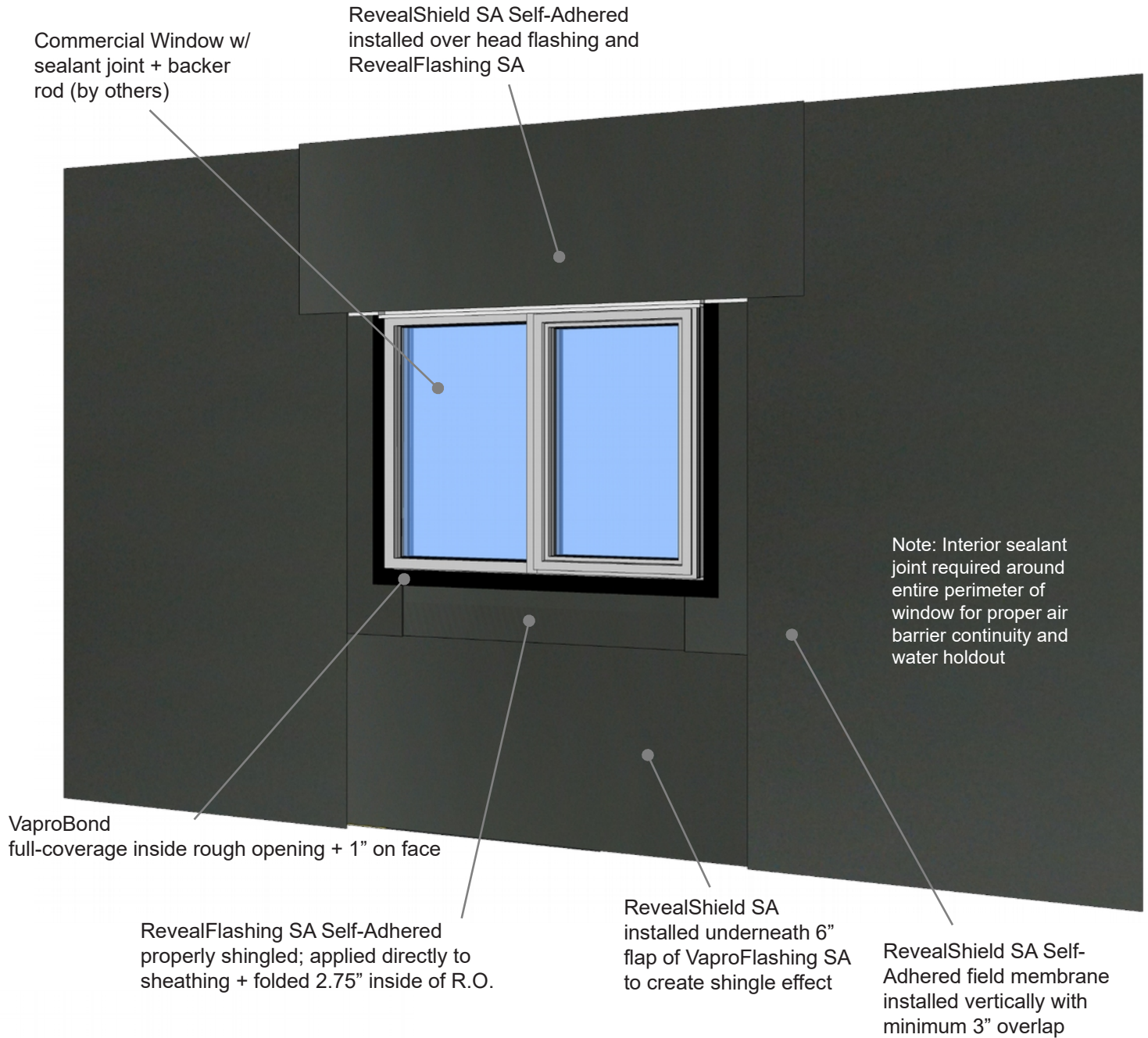

## VAPROBOND™

Step 10: Install field membrane over metal head flashing, maintaining 3" minimum overlap to adjacent field membrane.

### PRODUCT DESCRIPTION

VaproBond™ is a single component 100% silicone adhesive sealant used to bind layers of VaproShield membranes to each other or typical construction material surfaces. It simplifies the process of producing watertight, airtight details.

### DISCLAIMER

Detail sketch is generic, representing suggested best practices for VaproShield materials, and does not represent a specific job site condition and therefore may not be applicable to certain projects. Detail sketch is designed for use as a reference and must be approved by the designer/consultant of record for each project prior to installation by the subcontractor. Changes and approvals of VaproShield details are the sole responsibility of the designer/consultant of record. VaproShield is **not** the designer of record for building enclosure details and takes no responsibility for the accuracy or interpretation of actual project site conditions.

DRAWN BY: AR

DATE: 06/2017

REF: 196-A

Always check [www.VaproShield.com](http://www.VaproShield.com) for the latest details and installation instructions