

# Commercial Window Rough Opening Flashing: Exploded

- 1.) WrapFlashing SA Self-Adhered Sill Piece applied directly to sheathing + folded 2.75" inside of R.O. \*Release film left on lower 6" to shingle over field membrane
- 2.) WrapFlashing SA Self-Adhered Jamb Pieces applied directly to sheathing + folded 2.75" inside of R.O.
- 3.) WrapFlashing SA Self-Adhered Sill Pieces applied directly to sheathing + folded 2.75" inside of R.O.
- 4.) VaproBond @ inside rough opening + 1" on face, 30 mils on sill, 15 mils on jamb and head.
- 5.) Head flashing (by others) over VaproBond embedded in VaproBond

- 6.) VaproAirSeal + backer rod (by others)

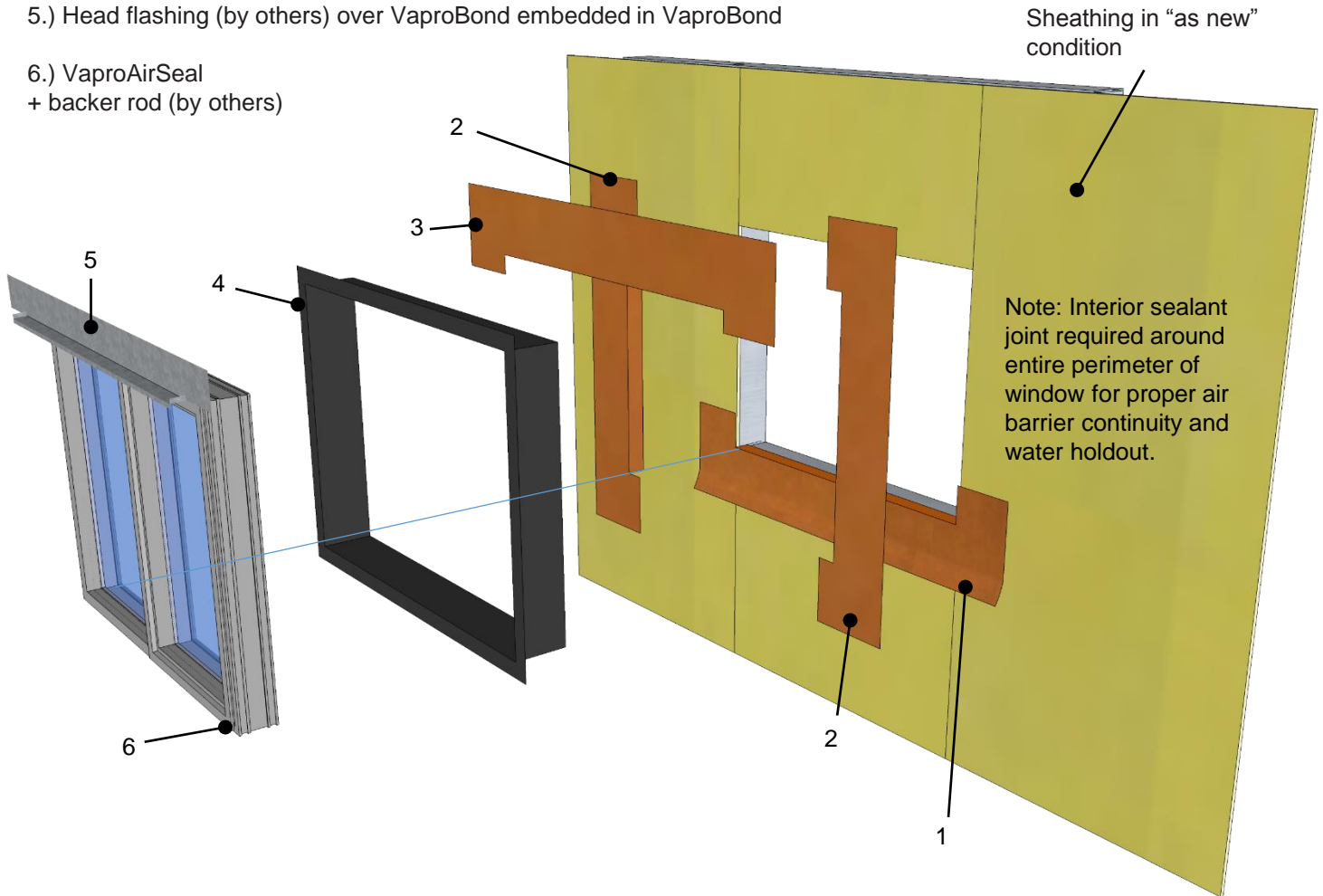

**VAPROBOND**<sup>™</sup>

**PRODUCT DESCRIPTION**  
VaproBond<sup>™</sup> is a single component 100% silicone adhesive sealant used to bind layers of VaproShield membranes to each other or typical construction material surfaces. It simplifies the process of producing watertight, airtight details.

**DISCLAIMER**

Detail sketch is generic, representing suggested best practices for VaproShield materials, and does not represent a specific job site condition and therefore may not be applicable to certain projects. Detail sketch is designed for use as a reference and must be approved by the designer/ consultant of record for each project prior to installation by the subcontractor. Changes and approvals of VaproShield details are the sole responsibility of the designer/consultant of record. VaproShield is **not** the designer of record for building enclosure details and takes no responsibility for the accuracy or interpretation of actual project site conditions.

DRAWN BY: AR

DATE: 06/2017

REF: 190

Always check [www.VaproShield.com](http://www.VaproShield.com) for the latest details and installation instructions