

Vapro-SS Flashing Window Rough Opening Sequencing Exploded View

1. WrapFlashing SA Self-Adhered sill piece applied directly to sheathing + folded 2.75" inside of R.O. Leave release film on lower 6" to shingle over field membrane.

2. WrapFlashing SA Jamb Pieces applied directly to sheathing + folded 2.75" inside R.O.

3. WrapFlashing SA head piece applied directly to sheathing + folded 2.75" inside of R.O.

4. Vapro-SS Flashing installed in shingle fashion (sill, jambs, head) with 3" up-turned legs at sill and head + 1" on face; jambs are 1" onto the face.

5. VaproBond or VaproLiqui-Flash 1/2" tooled fillet bead at each corner where inside of R.O. meets face of sheathing. Ref. Figure 1.

6. Window installation and sealant joints + backer rod (by others)

7. Head flashing (by others) over Vapro-SS Flashing + embedded in VaproBond.

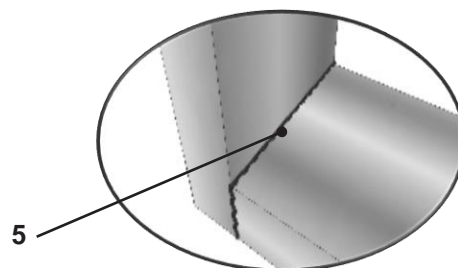
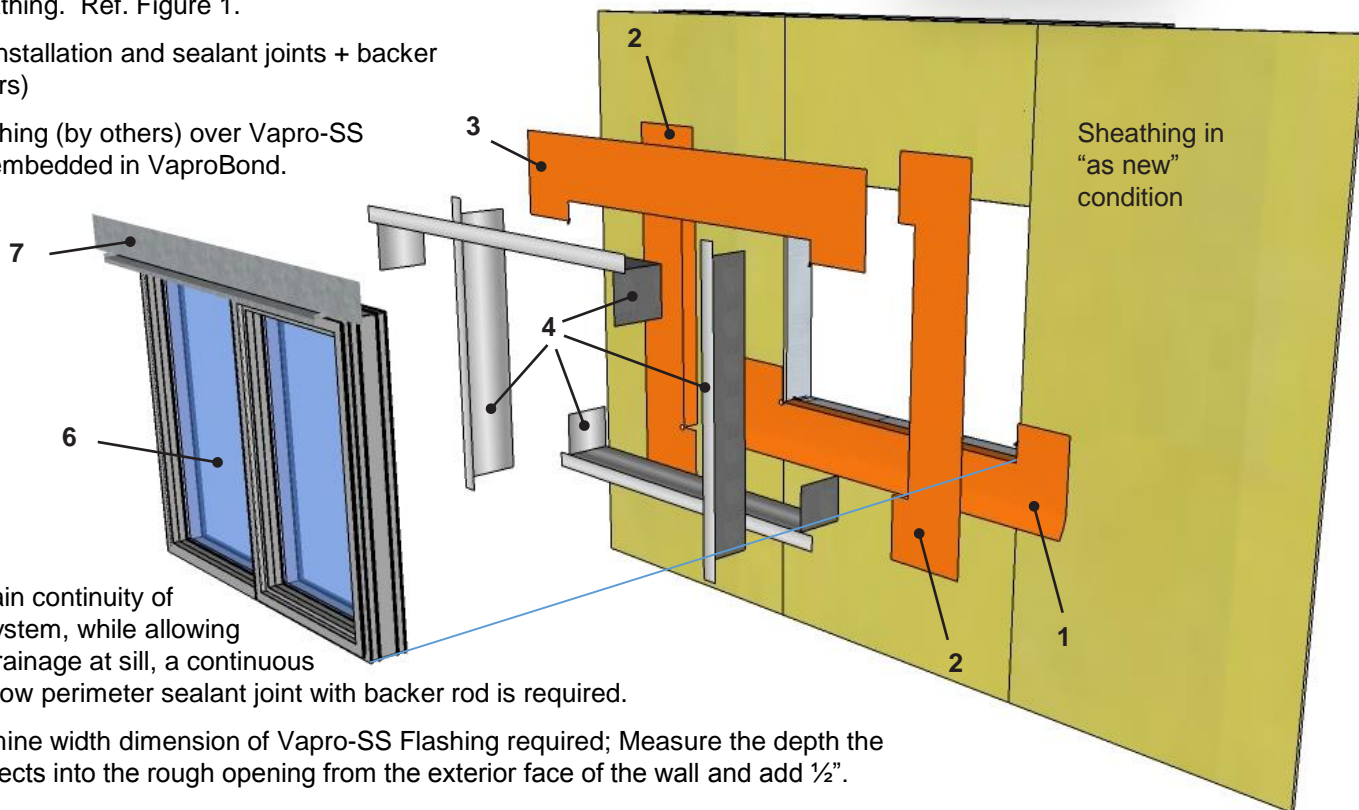

Figure 1, Close-up of corner



Notes:

a. To maintain continuity of air barrier system, while allowing for proper drainage at sill, a continuous interior window perimeter sealant joint with backer rod is required.

b. To determine width dimension of Vapro-SS Flashing required; Measure the depth the window projects into the rough opening from the exterior face of the wall and add 1/2".

c. Vapro-SS Flashing available in 4", 6", 9", 12", 18", or 24" widths by 50' length rolls

VAPRO-SS FLASHING™

PRODUCT DESCRIPTION

Vapro-SS Flashing is a stainless steel, butyl adhesive backed flexible, waterproof, air barrier flashing system component for window and door rough openings.

DISCLAIMER

Detail sketch is generic, representing suggested best practices for VaproShield materials, and does not represent a specific job site condition and therefore may not be applicable to certain projects. Detail sketch is designed for use as a reference and must be approved by the designer/ consultant of record for each project prior to installation by the subcontractor. Changes and approvals of VaproShield details are the sole responsibility of the designer/consultant of record. VaproShield is **not** the designer of record for building enclosure details and takes no responsibility for the accuracy or interpretation of actual project site conditions.

DRAWN BY: CAD Detail

DATE: 03.09.16

REF: 129

Always check www.VaproShield.com for the latest details and installation instructions