

# Commercial Window Rough Opening Flashing: Exploded

- 1.) WrapFlashing SA Self-Adhered Sill Piece applied directly to sheathing + folded 2.75" inside of R.O. \*Release paper left on lower 6" to shingle over field membrane
- 2.) WrapFlashing SA Self-Adhered Jamb Pieces applied directly to sheathing + folded 2.75" inside of R.O.
- 3.) WrapFlashing SA Self-Adhered Sill Pieces applied directly to sheathing + folded 2.75" inside of R.O.
- 4.) VaproLiqui-Flash @ inside rough opening + 1" on face, 30 mils on sill, 15 mils on jamb and head.

5.) Head flashing (by others) over VaproLiqui-Flash embedded in VaproBond

6.) Commercial Window sealant joint + backer rod (by others)

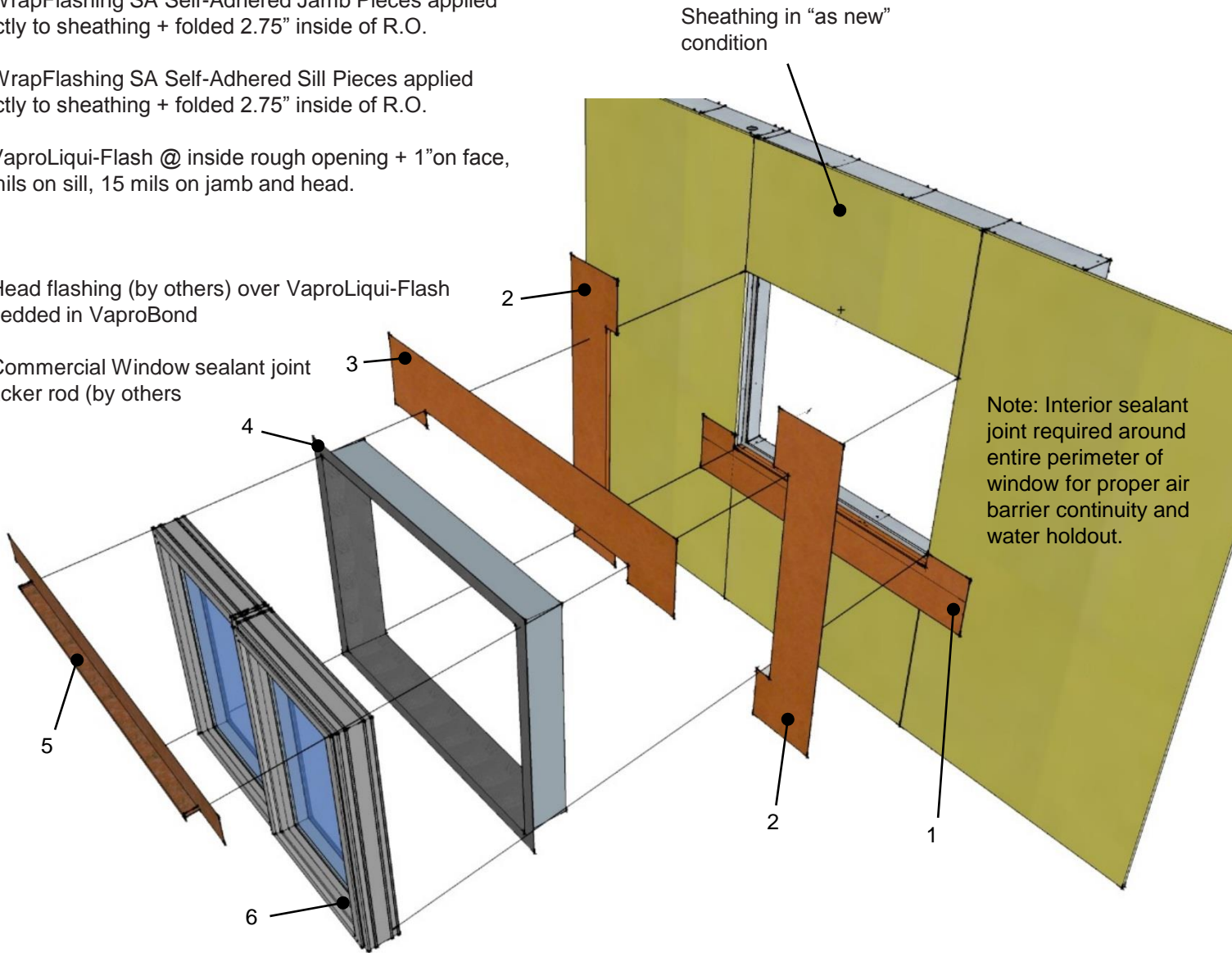

**VAPROLIQUI-FLASH**<sup>™</sup>

#### PRODUCT DESCRIPTION

VaproLiqui-Flash is a liquid applied, vapor permeable, waterproof, air barrier flashing system component for window and door rough openings. VaproLiquiFlash is designed to work with WrapFlashing and VaproShield field membranes as a complete system.

#### DISCLAIMER

Detail sketch is generic, representing suggested best practices for VaproShield materials, and does not represent a specific job site condition and therefore may not be applicable to certain projects. Detail sketch is designed for use as a reference and must be approved by the designer/consultant of record for each project prior to installation by the subcontractor. Changes and approvals of VaproShield details are the sole responsibility of the designer/consultant of record. VaproShield is **not** the designer of record for building enclosure details and takes no responsibility for the accuracy or interpretation of actual project site conditions.

DRAWN BY: BV

DATE: 12/2015

REF: 105

Always check [www.VaproShield.com](http://www.VaproShield.com) for the latest details and installation instructions