

SlopeShield® Plus Self-Adhered

Steep Slope Roof Detail Packet - 30 Pages

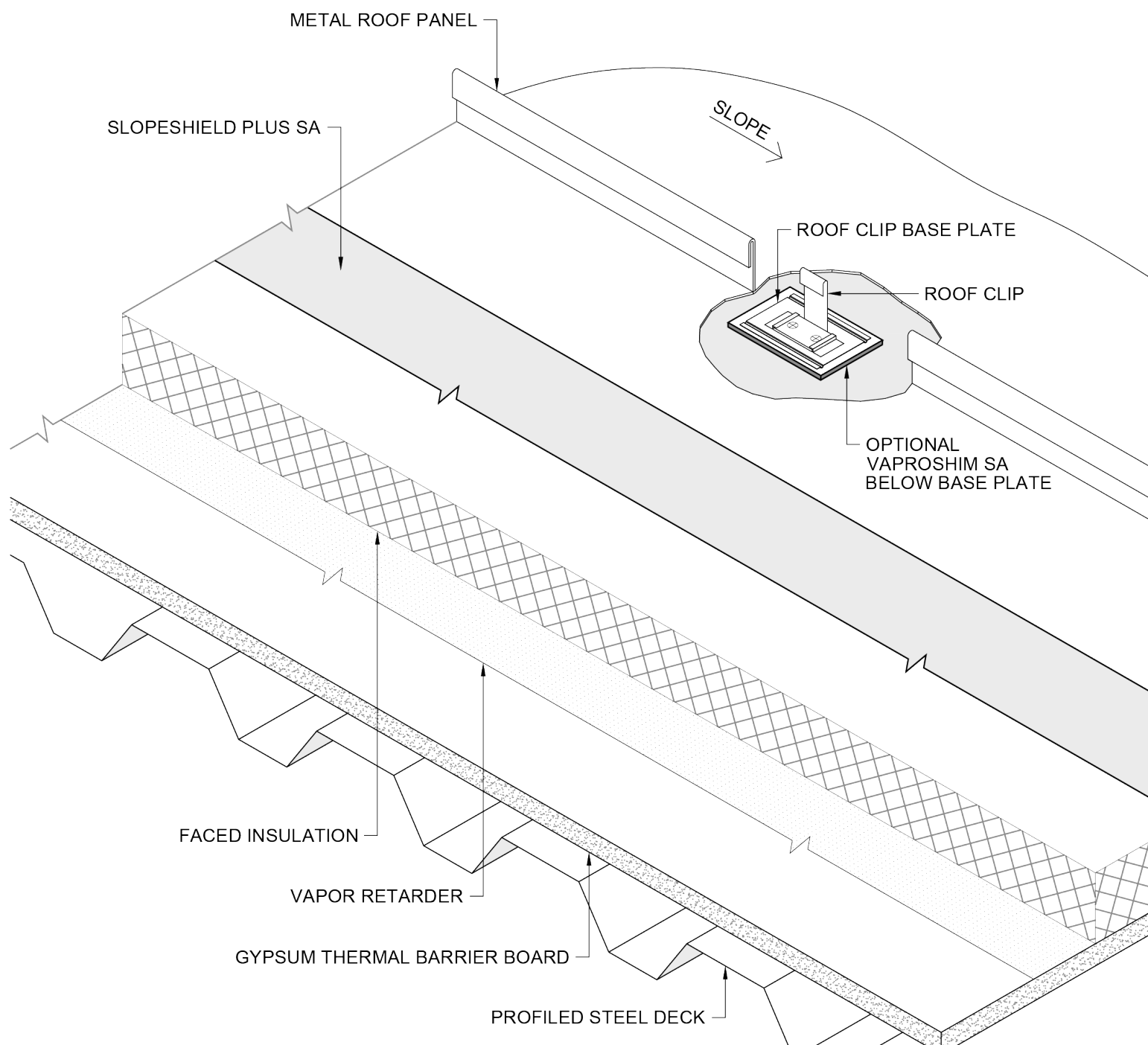

NOTES:

1. FOR ROOF SLOPE LESS THAN 2:12, CONTACT VAPROSHIELD TECHNICAL DEPARTMENT FOR INSTALLATION GUIDANCE
2. SLOPESHIELD PLUS SA MUST BE APPLIED TO CLEAN AND DRY SURFACE

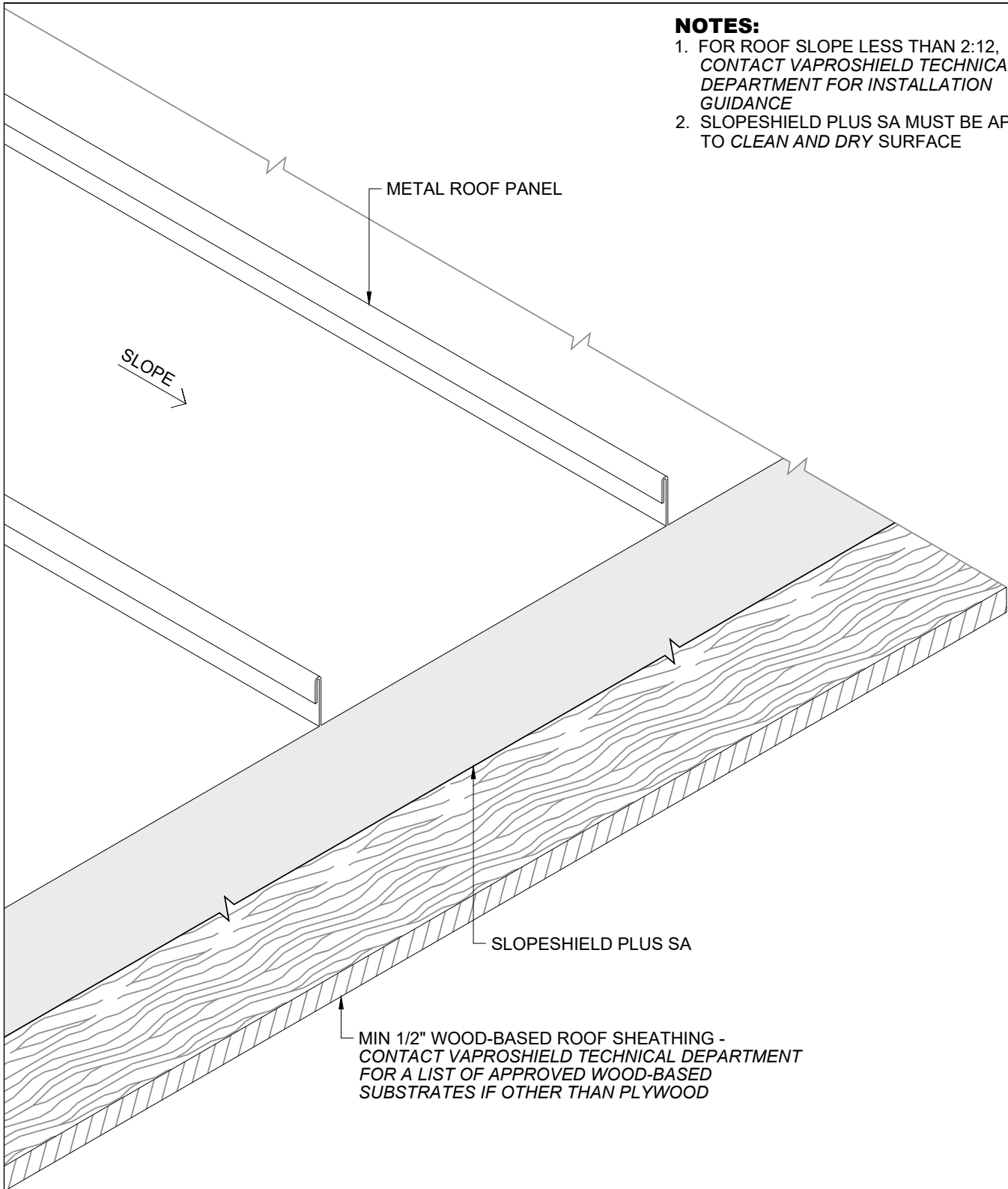

VAPROSHIELD SLOPESHIELD PLUS SA

TITLE: METAL ROOF
OVER WOOD SUBSTRATE

DATE: 08.03.2020

SCALE: NONE

STEEP SLOPE
2:12 OR GREATER

FILE:

SS-01

NOTES:

1. FOR ROOF SLOPE LESS THAN 2:12, CONTACT VAPROSHIELD TECHNICAL DEPARTMENT FOR INSTALLATION GUIDANCE
2. SLOPESHIELD PLUS SA MUST BE APPLIED TO CLEAN AND DRY SURFACE

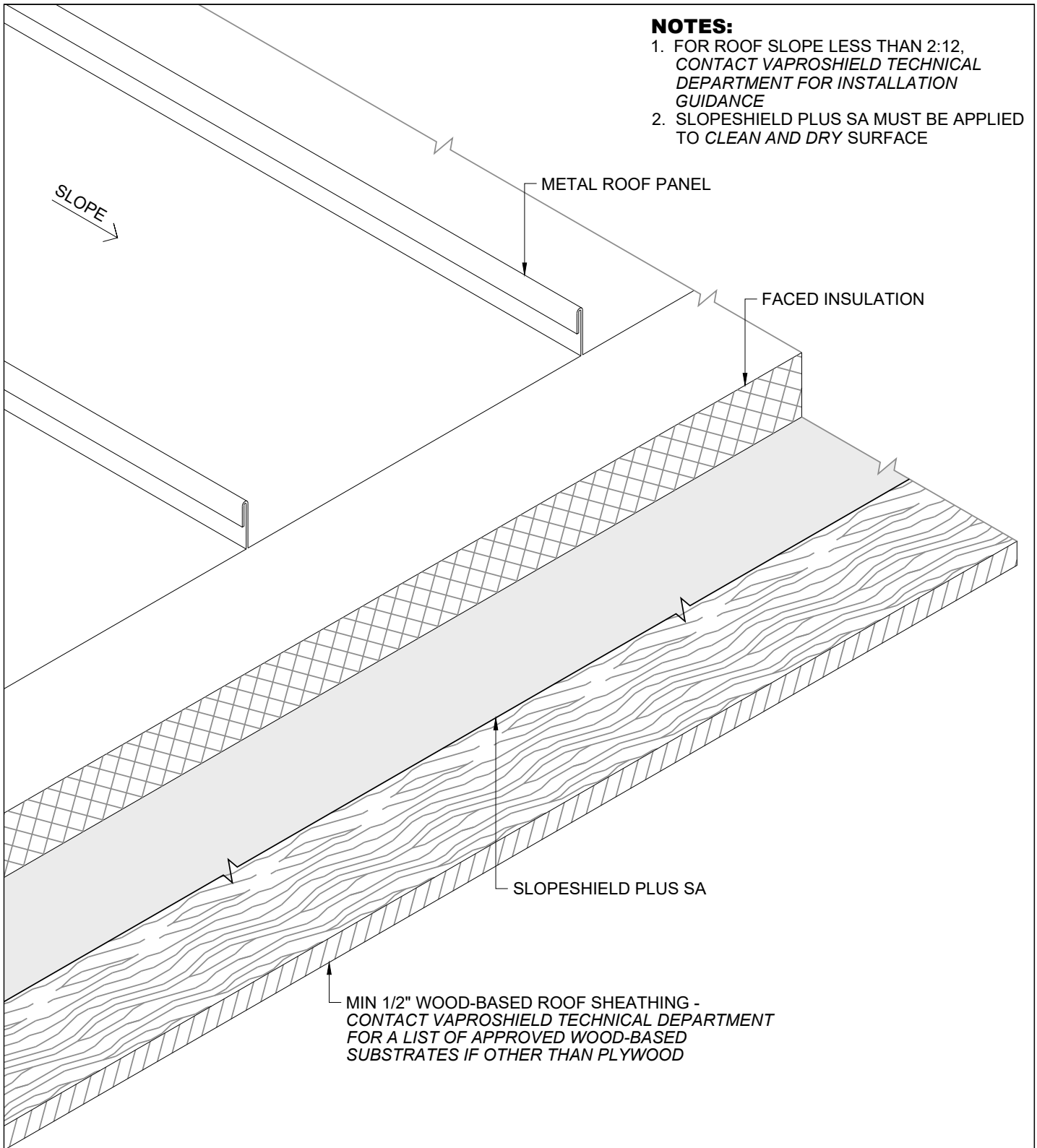

VAPROSHIELD SLOPESHIELD PLUS SA

TITLE: METAL ROOF OVER INSULATION
ASSEMBLY #1

DATE: 08.03.2020

SCALE: NONE

STEEP SLOPE
2:12 OR GREATER

FILE:

SS-02

NOTES:

1. FOR ROOF SLOPE LESS THAN 2:12, CONTACT VAPROSHIELD TECHNICAL DEPARTMENT FOR INSTALLATION GUIDANCE
2. SLOPESHIELD PLUS SA MUST BE APPLIED TO CLEAN AND DRY SURFACE

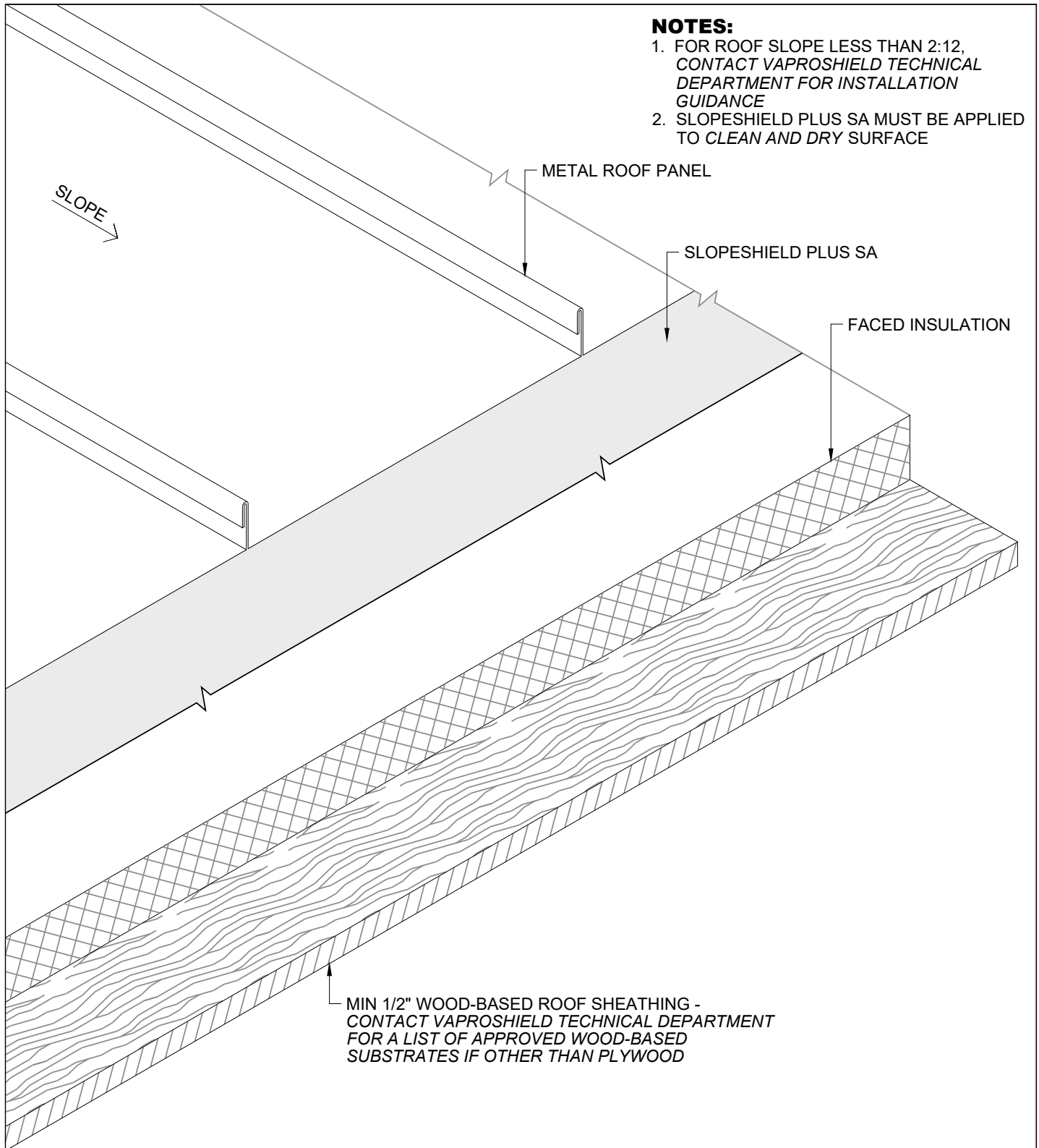

VAPROSHIELD SLOPESHIELD PLUS SA

TITLE: METAL ROOF OVER INSULATION
ASSEMBLY #2

DATE: 08.03.2020

SCALE: NONE

STEEP SLOPE
2:12 OR GREATER

FILE:

SS-03

NOTES:

1. FOR ROOF SLOPE LESS THAN 2:12, CONTACT VAPROSHIELD TECHNICAL DEPARTMENT FOR INSTALLATION GUIDANCE
2. SLOPESHIELD PLUS SA MUST BE APPLIED TO CLEAN AND DRY SURFACE

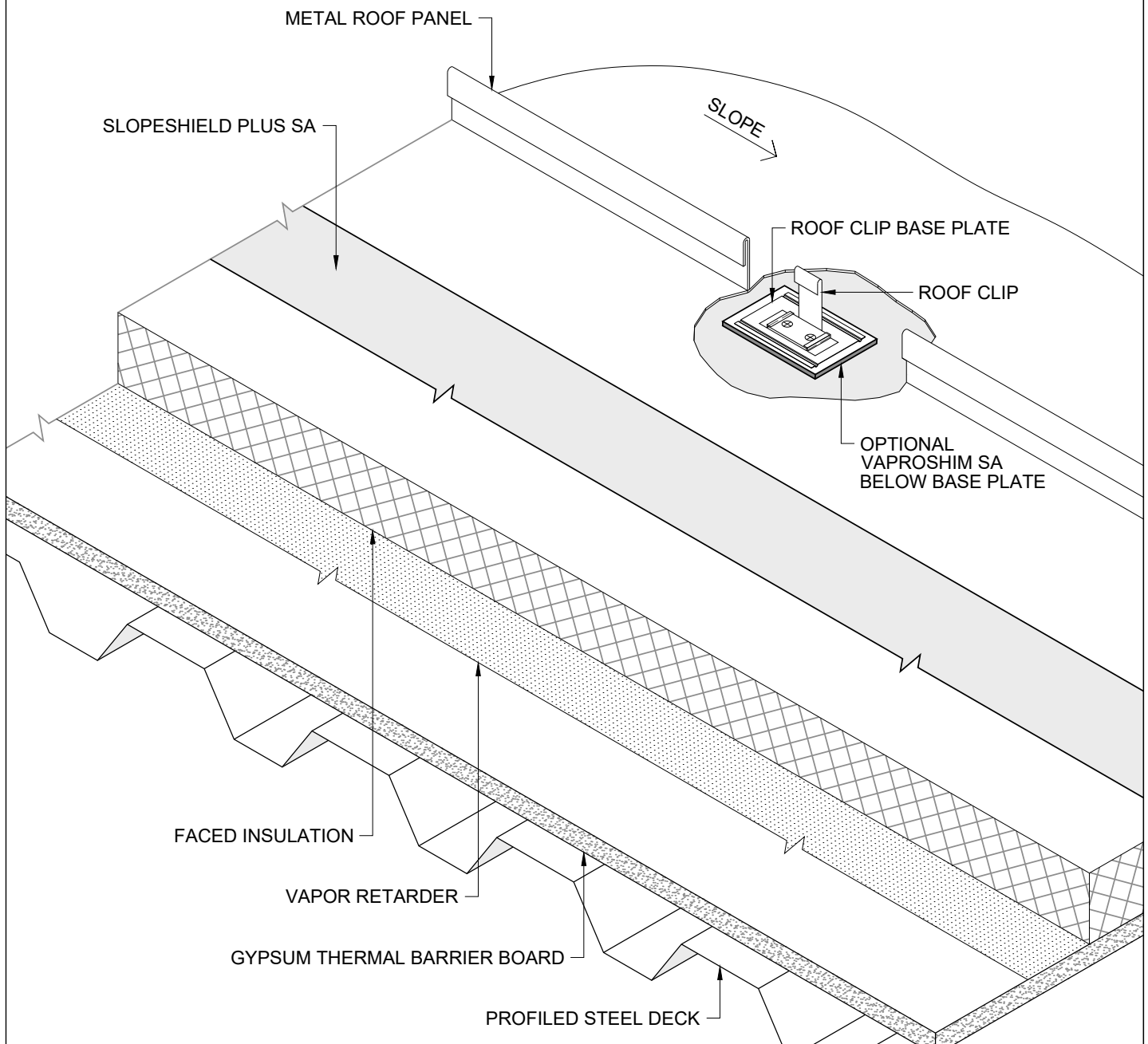
**VAPROSHIELD SLOPESHIELD PLUS SA**

**TITLE: METAL ROOF OVER INSULATION
ASSEMBLY #3**

DATE: 08.03.2020

SCALE: NONE

**STEEP SLOPE
2:12 OR GREATER**

FILE:

SS-04

NOTES:

1. FOR ROOF SLOPE LESS THAN 2:12,
CONTACT VAPROSHIELD TECHNICAL
DEPARTMENT FOR INSTALLATION
GUIDANCE
2. SLOPESHIELD PLUS SA MUST BE APPLIED
TO CLEAN AND DRY SURFACE

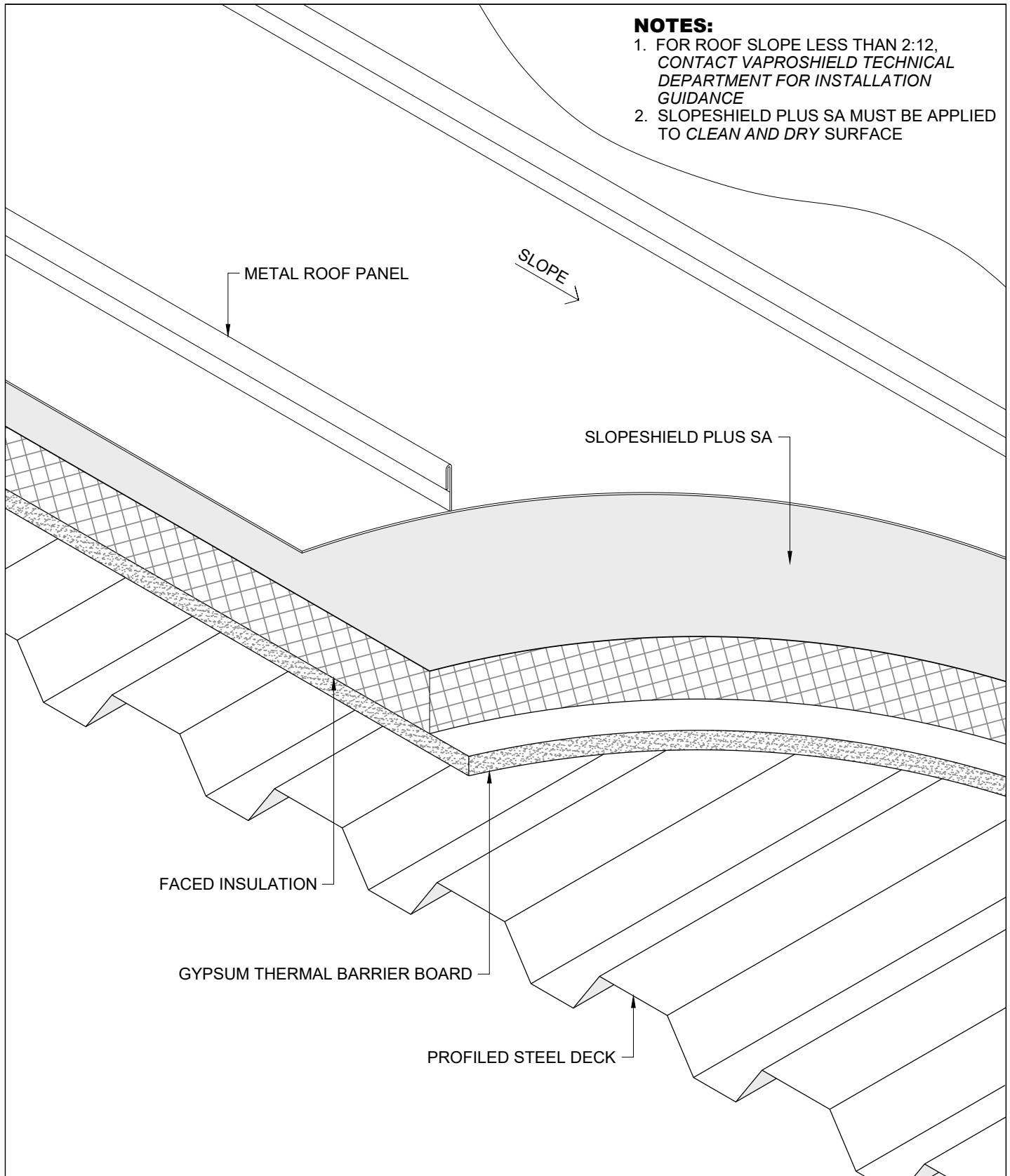

VAPROSHIELD SLOPESHIELD PLUS SA

TITLE: METAL ROOF OVER INSULATION
ASSEMBLY #4

DATE: 08.03.2020

SCALE: NONE

STEEP SLOPE
2:12 OR GREATER

FILE:

SS-05

NOTES:

1. FOR ROOF SLOPE LESS THAN 2:12,
CONTACT VAPROSHIELD TECHNICAL
DEPARTMENT FOR INSTALLATION
GUIDANCE
2. SLOPESHIELD PLUS SA MUST BE APPLIED
TO CLEAN AND DRY SURFACE

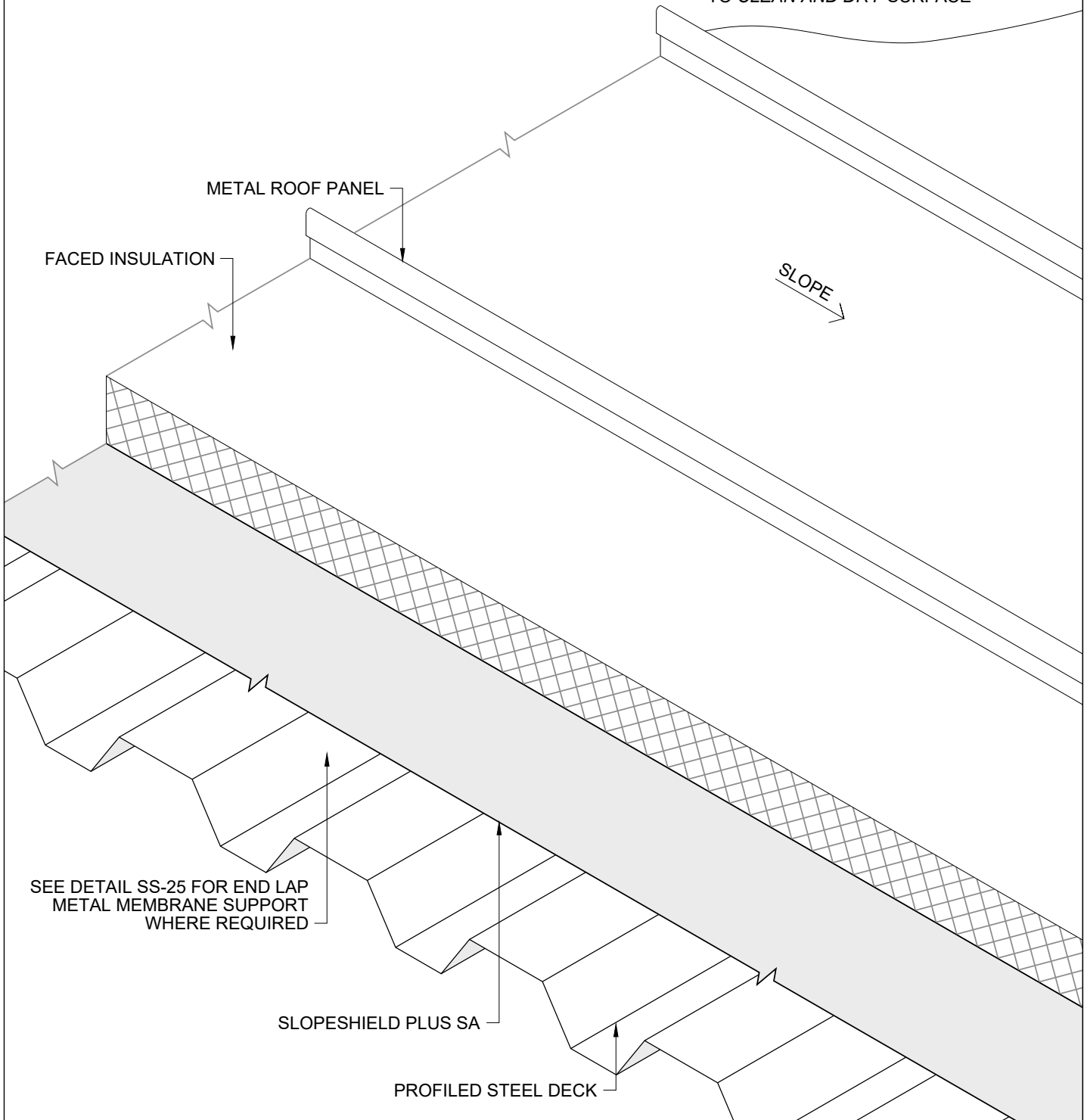

VAPROSHIELD SLOPESHIELD PLUS SA

TITLE: METAL ROOF OVER INSULATION
ASSEMBLY #5

DATE: 08.03.2020

SCALE: NONE

STEEP SLOPE
2:12 OR GREATER

FILE:

SS-06

NOTES:

1. FOR ROOF SLOPE LESS THAN 2:12, CONTACT VAPROSHIELD TECHNICAL DEPARTMENT FOR INSTALLATION GUIDANCE
2. SLOPESHIELD PLUS SA MUST BE APPLIED TO CLEAN AND DRY SURFACE

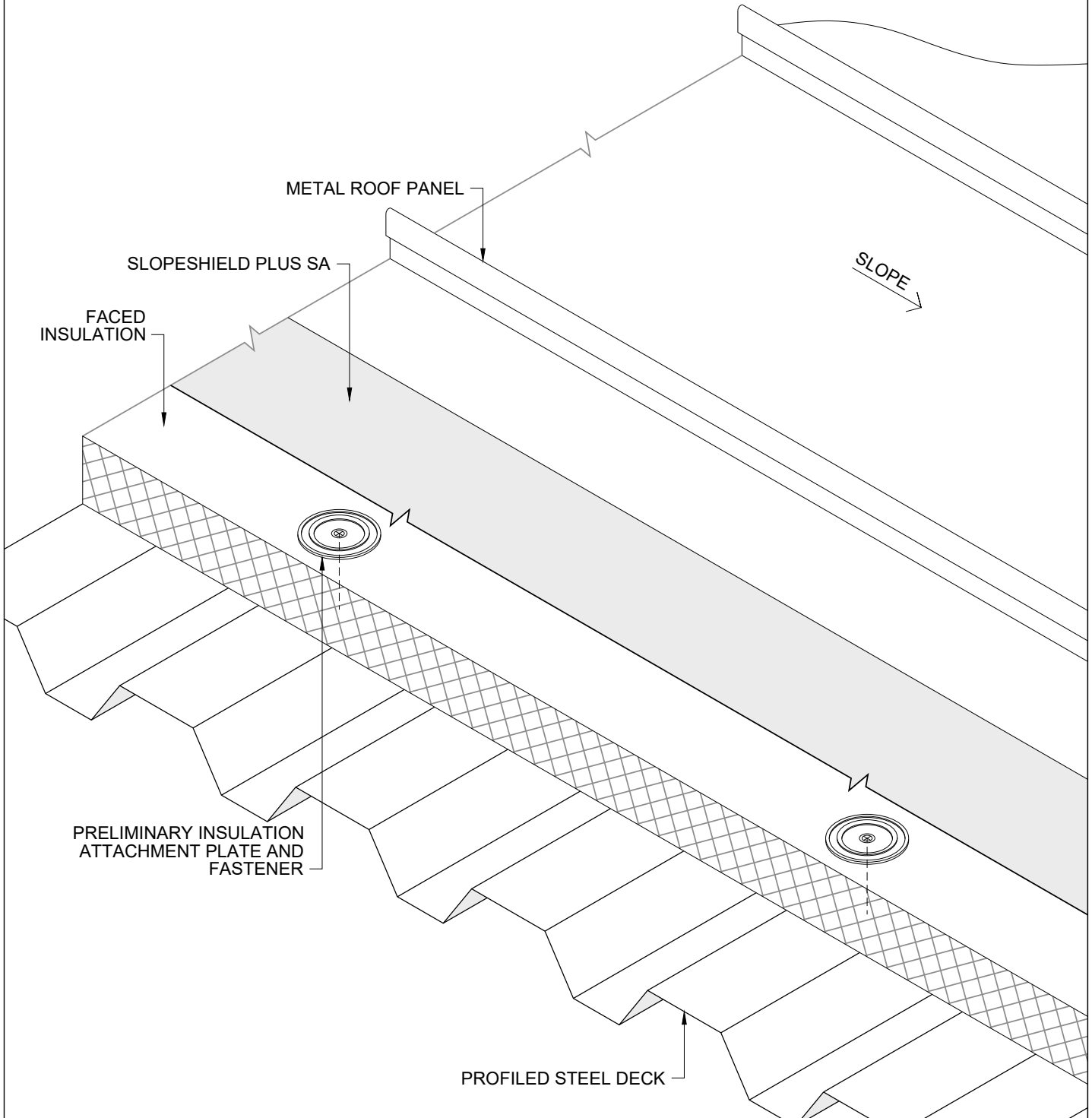
**VAPROSHIELD SLOPESHIELD PLUS SA**

TITLE: METAL ROOF OVER INSULATION
ASSEMBLY #6

DATE: 08.03.2020

SCALE: NONE

STEEP SLOPE
2:12 OR GREATER

FILE:

SS-07

NOTES:

1. FOR ROOF SLOPE LESS THAN 2:12, CONTACT VAPROSHIELD TECHNICAL DEPARTMENT FOR INSTALLATION GUIDANCE
2. SLOPESHIELD PLUS SA MUST BE APPLIED TO CLEAN AND DRY SURFACE

[ROOF PANELS NOT SHOWN FOR CLARITY]

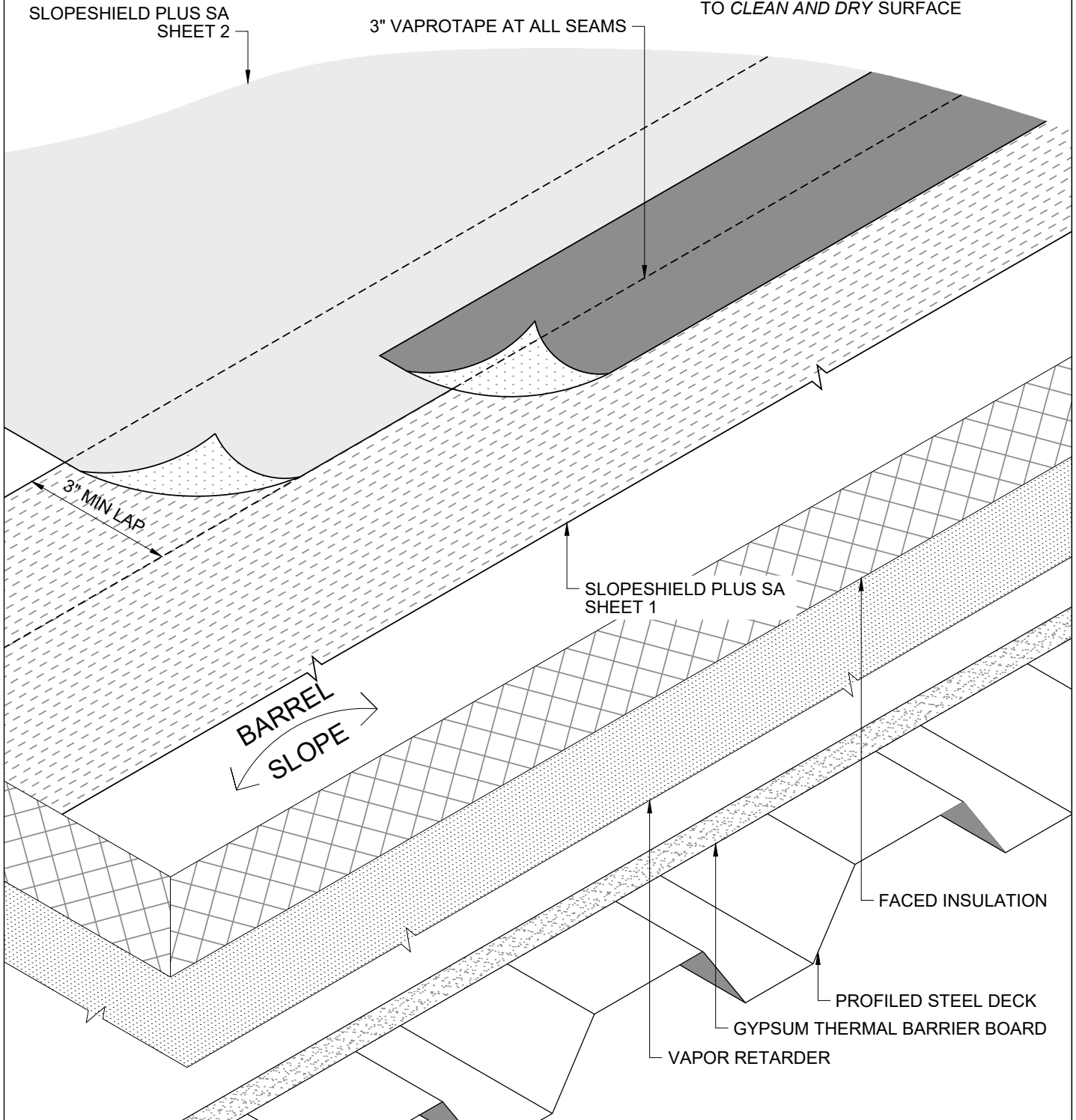

VAPROSHIELD SLOPESHIELD PLUS SA

TITLE: BARREL ROOF - SLOPESHIELD PLUS SA
INSTALLED PERPENDICULAR TO EAVE

DATE: 08.03.2020

STEEP SLOPE
2:12 OR GREATER

FILE:

SS-08

SCALE: NONE

NOTES:

1. FOR ROOF SLOPE LESS THAN 2:12, CONTACT VAPROSHIELD TECHNICAL DEPARTMENT FOR INSTALLATION GUIDANCE
2. SLOPESHIELD PLUS SA MUST BE APPLIED TO CLEAN AND DRY SURFACE

[ROOF PANELS NOT SHOWN FOR CLARITY]

3" VAPROTAPE AT ALL SEAMS ALONG AREAS OF ROOF WITH LESS THAN 2:12 SLOPE

SLOPESHIELD PLUS SA SHEET 2

BARREL
SLOPE

3" MIN LAP

SLOPESHIELD PLUS SA
SHEET 1

FACED INSULATION

PROFILED STEEL DECK

GYPSUM THERMAL BARRIER BOARD

VAPOR RETARDER



VAPROSHIELD SLOPESHIELD PLUS SA

TITLE: BARREL ROOF - SLOPESHIELD PLUS SA
INSTALLED PARALLEL TO EAVE

DATE: 08.03.2020

STEEP SLOPE
2:12 OR GREATER

FILE:

SS-09

SCALE: NONE

NOTES:

1. FOR ROOF SLOPE LESS THAN 2:12,
CONTACT VAPROSHIELD TECHNICAL
DEPARTMENT FOR INSTALLATION
GUIDANCE
2. SLOPESHIELD PLUS SA MUST BE APPLIED
TO CLEAN AND DRY SURFACE

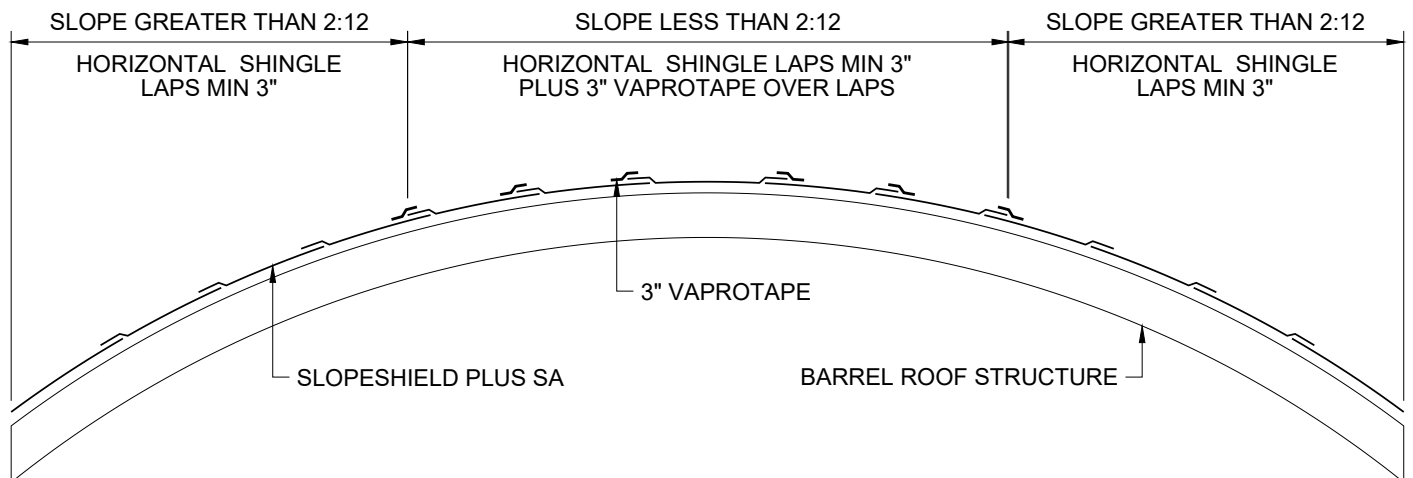

VAPROSHIELD SLOPESHIELD PLUS SA

TITLE: BARREL ROOF - SLOPESHIELD PLUS SA
INSTALLED PARALLEL TO EAVE - VAPROTAPE

DATE: 08.03.2020

STEEP SLOPE
2:12 OR GREATER

FILE:

SS-10

SCALE: NONE

NOTES:

1. FOR ROOF SLOPE LESS THAN 2:12,
CONTACT VAPROSHIELD TECHNICAL
DEPARTMENT FOR INSTALLATION
GUIDANCE
2. SLOPESHIELD PLUS SA MUST BE APPLIED
TO CLEAN AND DRY SURFACE

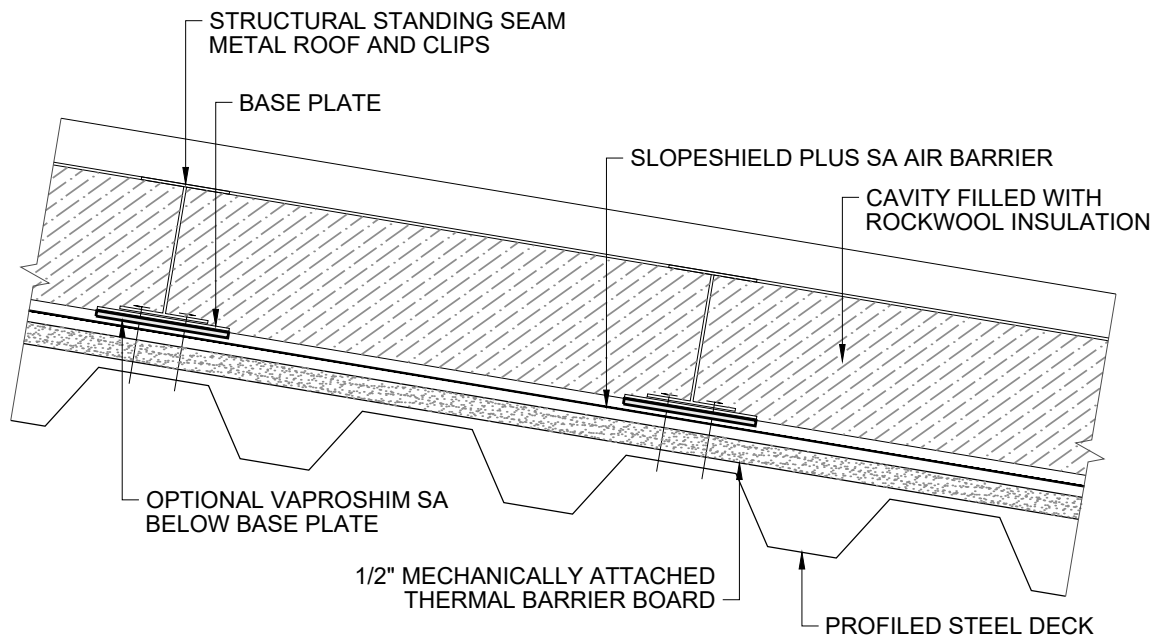
**VAPROSHIELD SLOPESHIELD PLUS SA**

TITLE: METAL ROOF OVER ROCKWOOL
CAVITY INSULATION - VAPROSHIM SA

DATE: 08.03.2020

STEEP SLOPE
2:12 OR GREATER

FILE:

SS-11

SCALE: NONE

NOTES:

1. FOR ROOF SLOPE LESS THAN 2:12,
CONTACT VAPROSHIELD TECHNICAL
DEPARTMENT FOR INSTALLATION
GUIDANCE
2. SLOPESHIELD PLUS SA MUST BE APPLIED
TO CLEAN AND DRY SURFACE

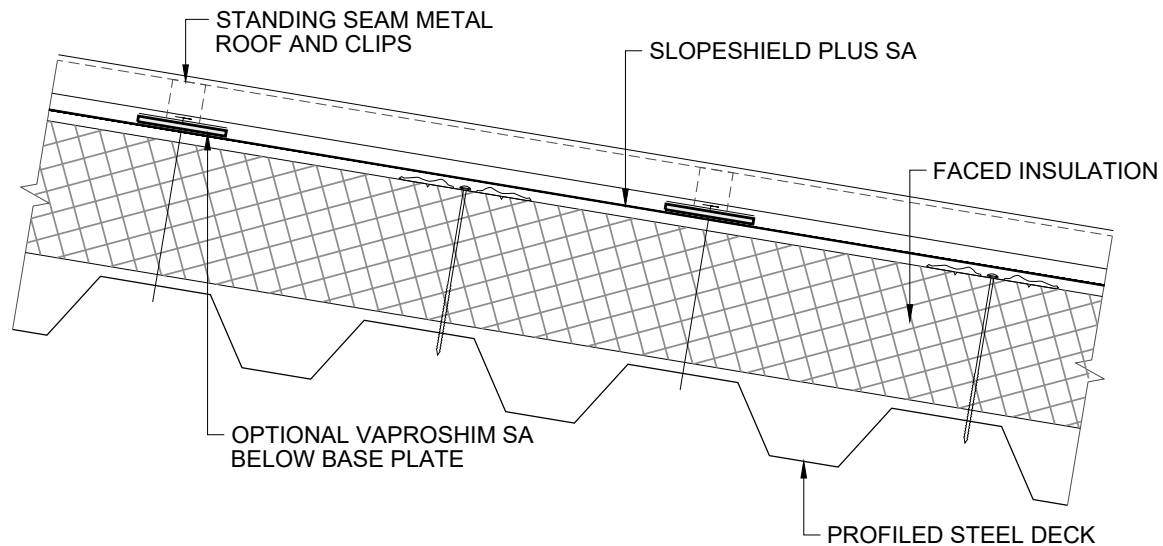
**VAPROSHIELD SLOPESHIELD PLUS SA**

TITLE: METAL ROOF WITH ROOF CLIPS
OVER INSULATION - WITH VAPROSHIM SA

DATE: 08.03.2020

STEEP SLOPE
2:12 OR GREATER

FILE:

SS-12

SCALE: NONE

NOTES:

1. FOR ROOF SLOPE LESS THAN 3:12, CONTACT VAPROSHIELD TECHNICAL DEPARTMENT FOR INSTALLATION GUIDANCE
2. SLOPESHIELD PLUS SA MUST BE APPLIED TO CLEAN AND DRY SURFACE

NOTE: HEAD LAP AND ATTACHMENT TO MEET PROJECT WIND LOAD REQUIREMENTS

ROOF TILE

SLOPE

BATTEN

COUNTER BATTEN

PRELIMINARY INSULATION ATTACHMENT PLATE AND FASTENER

SLOPESHIELD PLUS SA

RIGID INSULATION WITH NAIL BASE

NOTE: ATTACHMENT OF NAIL BASE TO MEET PROJECT WIND LOAD REQUIREMENTS

PROFILED STEEL DECK

**VAPROSHIELD SLOPESHIELD PLUS SA**

TITLE: TILE ROOF WITH BATTENS AND COUNTER BATTENS

DATE: 08.03.2020

STEEP SLOPE
2:12 OR GREATER

FILE:

SS-13

SCALE: NONE

NOTES:

1. FOR ROOF SLOPE LESS THAN 3:12, CONTACT VAPROSHIELD TECHNICAL DEPARTMENT FOR INSTALLATION GUIDANCE
2. SLOPESHIELD PLUS SA MUST BE APPLIED TO CLEAN AND DRY SURFACE

NOTE: HEAD LAP AND ATTACHMENT TO MEET PROJECT WIND LOAD REQUIREMENTS

ROOF TILE

SLOPE →

BATTEN

PRELIMINARY INSULATION ATTACHMENT PLATE AND FASTENER

SLOPESHIELD PLUS SA

RIGID INSULATION WITH NAIL BASE

NOTE: ATTACHMENT OF NAIL BASE TO MEET PROJECT WIND LOAD REQUIREMENTS

PROFILED STEEL DECK



VAPROSHIELD SLOPESHIELD PLUS SA

TITLE: TILE ROOF WITH BATTENS

DATE: 08.03.2020

STEEP SLOPE
2:12 OR GREATER

FILE:

SS-14

SCALE: NONE

NOTES:

1. FOR ROOF SLOPE LESS THAN 3:12, CONTACT VAPROSHIELD TECHNICAL DEPARTMENT FOR INSTALLATION GUIDANCE
2. SLOPESHIELD PLUS SA MUST BE APPLIED TO CLEAN AND DRY SURFACE

NOTE: HEAD LAP AND ATTACHMENT TO MEET PROJECT WIND LOAD REQUIREMENTS

SLOPE

SLATE TILE

PRELIMINARY INSULATION ATTACHMENT PLATE AND FASTENER

SLOPESHIELD PLUS SA

RIGID INSULATION WITH NAIL BASE

NOTE: ATTACHMENT OF NAIL BASE TO MEET PROJECT WIND LOAD REQUIREMENTS

PROFILED STEEL DECK



VAPROSHIELD SLOPESHIELD PLUS SA

TITLE: SLATE ROOF - DIRECT APPLIED

DATE: 08.03.2020

SCALE: NONE

STEEP SLOPE
2:12 OR GREATER

FILE:

SS-15

NOTES:

1. FOR ROOF SLOPE LESS THAN 2:12, CONTACT VAPROSHIELD TECHNICAL DEPARTMENT FOR INSTALLATION GUIDANCE
2. SLOPESHIELD PLUS SA MUST BE APPLIED TO CLEAN AND DRY SURFACE

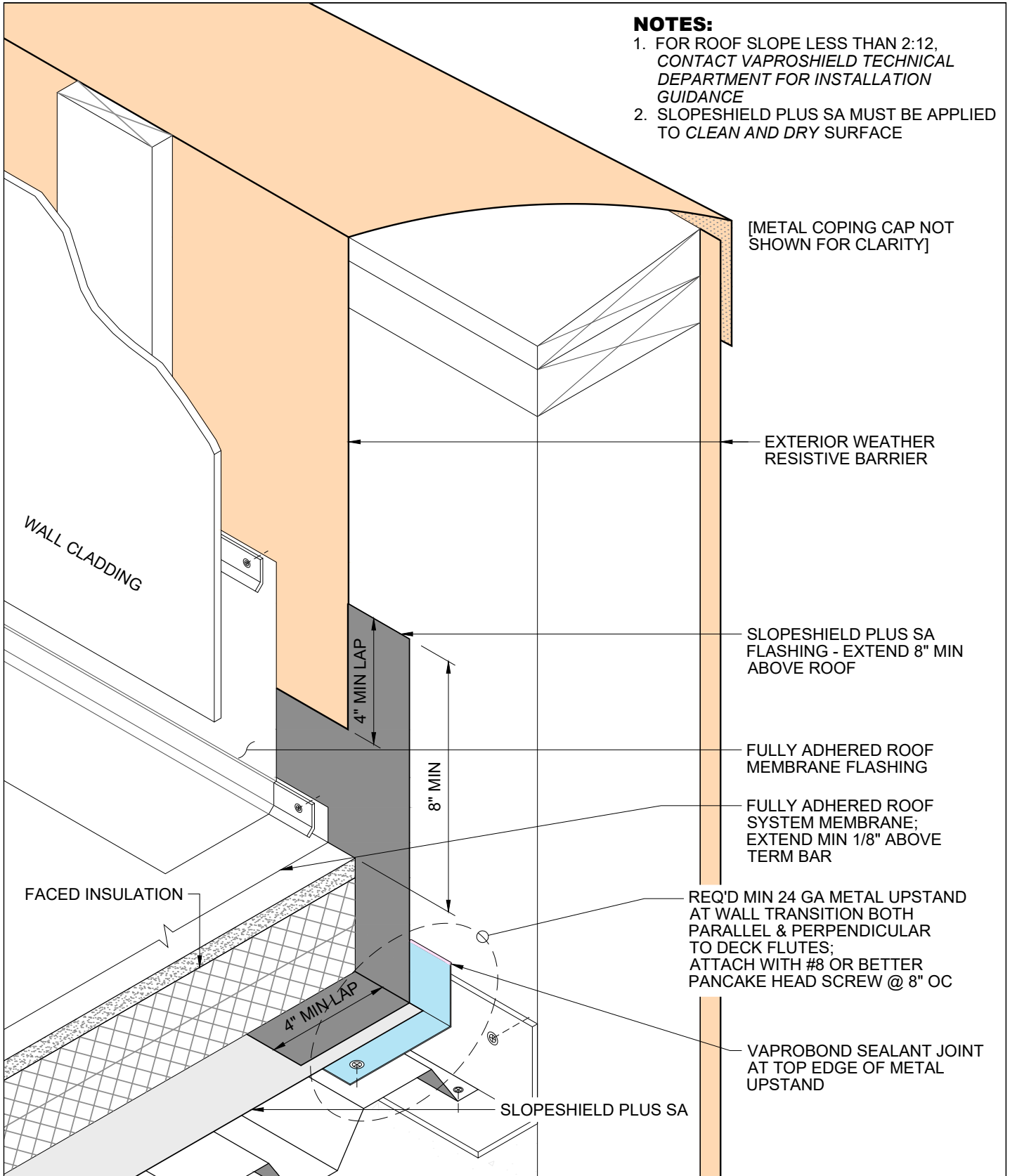

VAPROSHIELD SLOPESHIELD PLUS SA

TITLE: HIGH PARAPET FLASHING DETAIL

DATE: 08.03.2020

SCALE: NONE

STEEP SLOPE
2:12 OR GREATER

FILE:

SS-16

NOTES:

1. FOR ROOF SLOPE LESS THAN 2:12, CONTACT VAPROSHIELD TECHNICAL DEPARTMENT FOR INSTALLATION GUIDANCE
2. SLOPESHIELD PLUS SA MUST BE APPLIED TO CLEAN AND DRY SURFACE

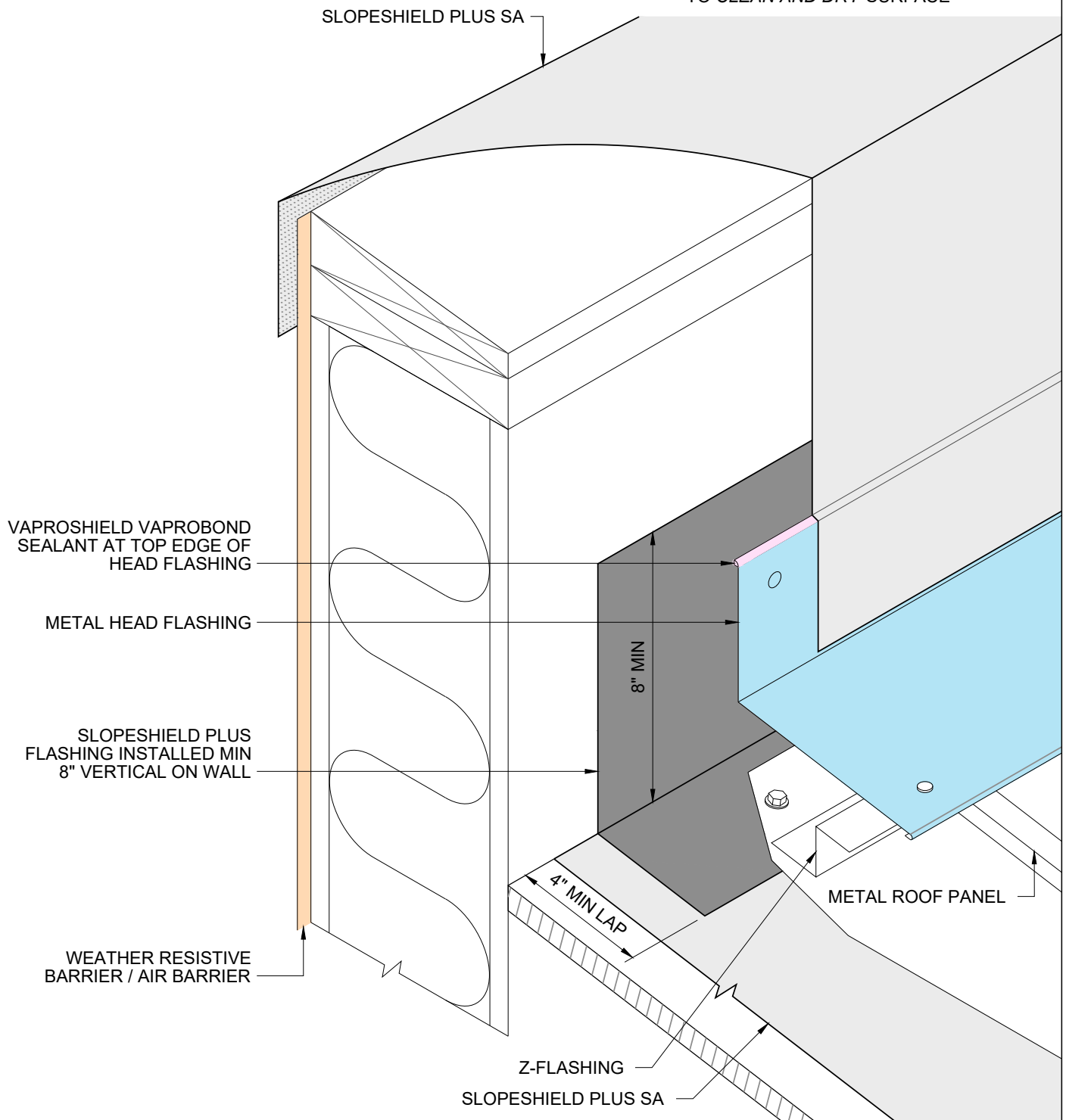

VAPROSHIELD SLOPESHIELD PLUS SA

TITLE: ROOF TO WALL HEAD FLASHING

DATE: 08.03.2020

SCALE: NONE

STEEP SLOPE
2:12 OR GREATER

FILE:

SS-17

NOTES:

1. FOR ROOF SLOPE LESS THAN 2:12,
CONTACT VAPROSHIELD TECHNICAL
DEPARTMENT FOR INSTALLATION
GUIDANCE
2. SLOPESHIELD PLUS SA MUST BE APPLIED
TO CLEAN AND DRY SURFACE

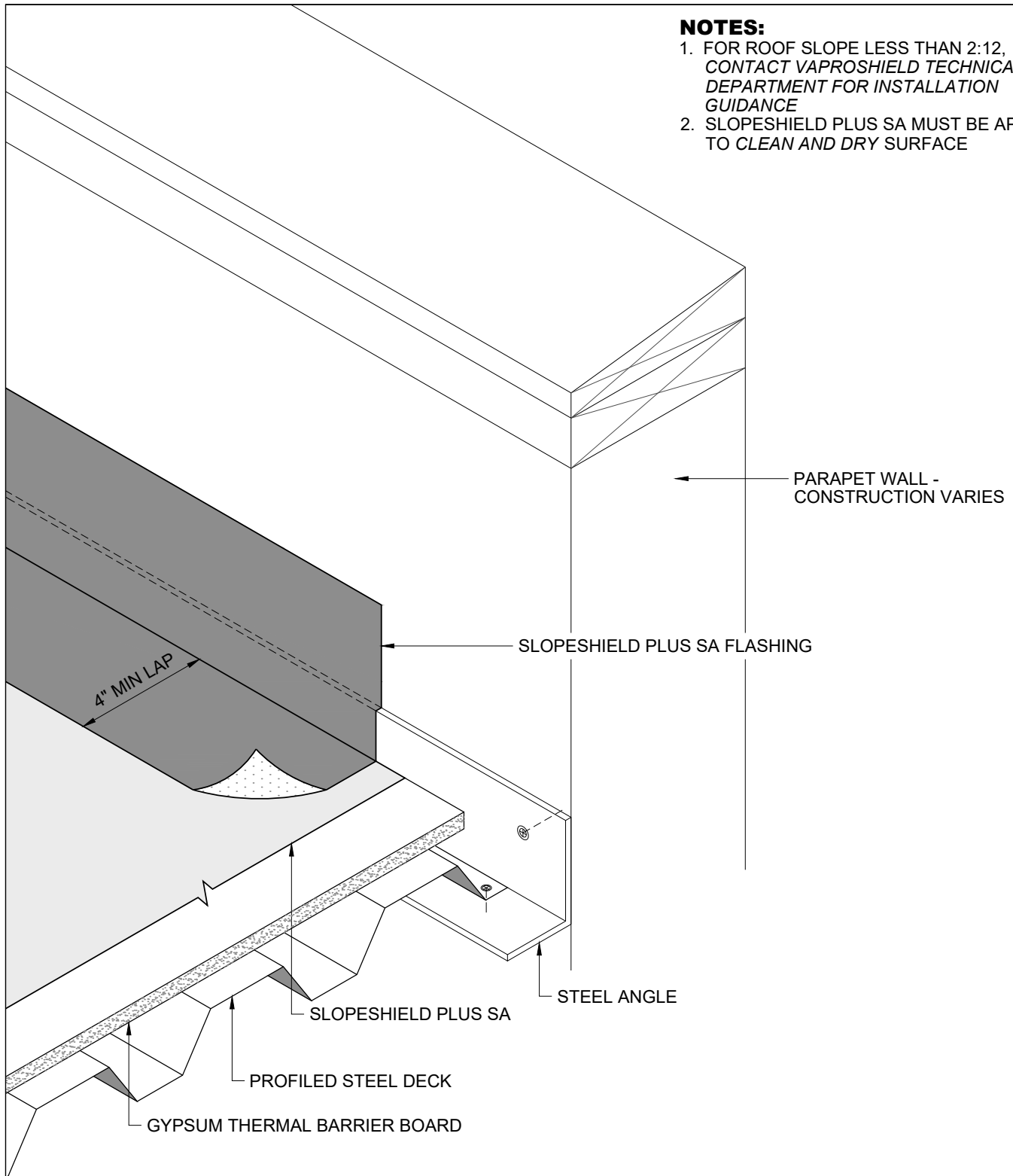

VAPROSHIELD SLOPESHIELD PLUS SA

TITLE: BASE FLASHING DETAIL

DATE: 08.03.2020

STEEP SLOPE
2:12 OR GREATER

FILE:

SS-18

SCALE: NONE

NOTES:

1. FOR ROOF SLOPE LESS THAN 2:12,
CONTACT VAPROSHIELD TECHNICAL
DEPARTMENT FOR INSTALLATION
GUIDANCE
2. SLOPESHIELD PLUS SA MUST BE APPLIED
TO CLEAN AND DRY SURFACE

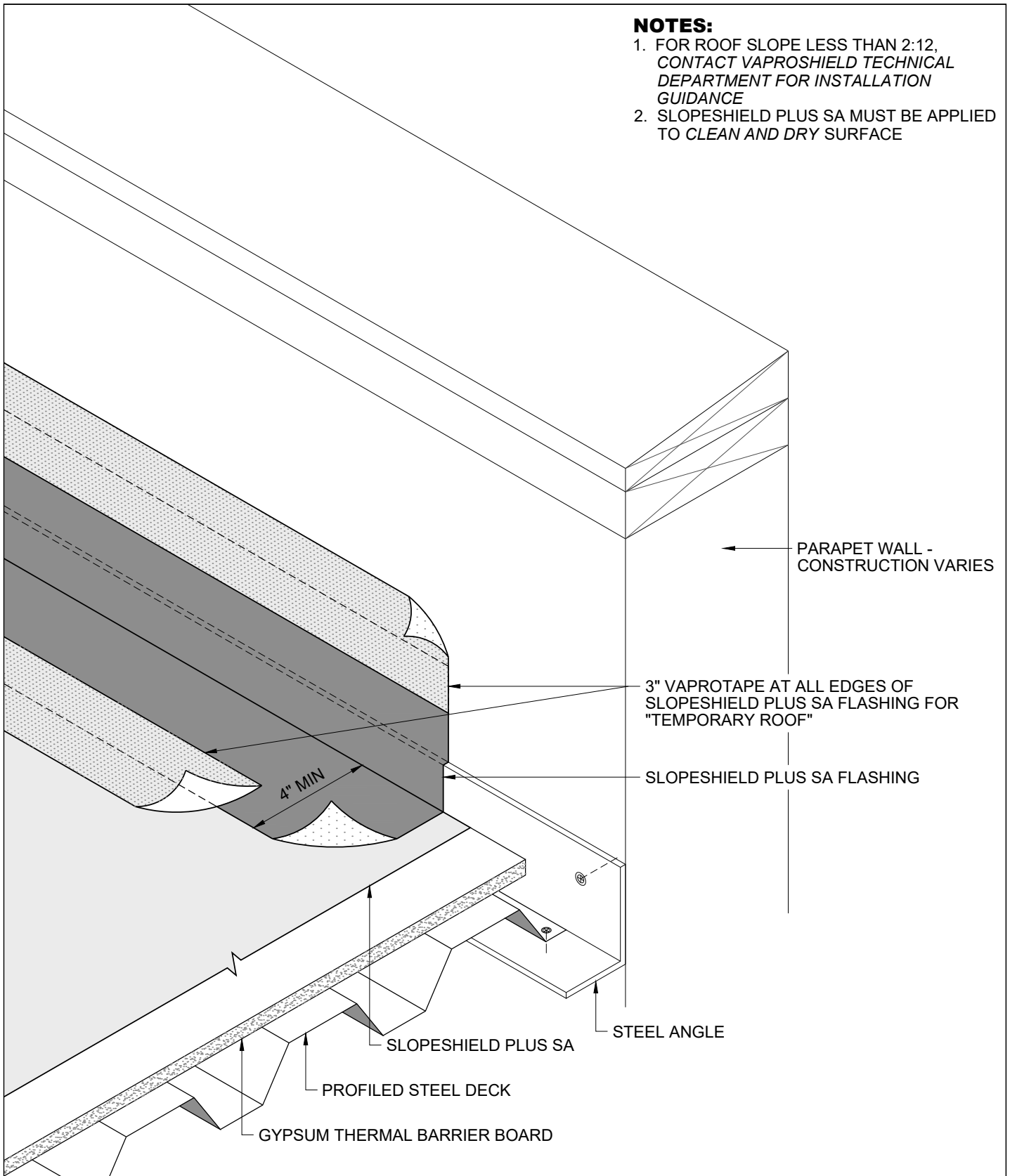
**VAPROSHIELD SLOPESHIELD PLUS SA**

TITLE: TEMPORARY ROOF -
SLOPESHIELD PLUS SA EDGE FLASHING

DATE: 08.03.2020

STEEP SLOPE
2:12 OR GREATER

FILE:

SS-19

SCALE: NONE

NOTES:

1. FOR ROOF SLOPE LESS THAN 2:12,
CONTACT VAPROSHIELD TECHNICAL
DEPARTMENT FOR INSTALLATION
GUIDANCE
2. SLOPESHIELD PLUS SA MUST BE APPLIED
TO CLEAN AND DRY SURFACE

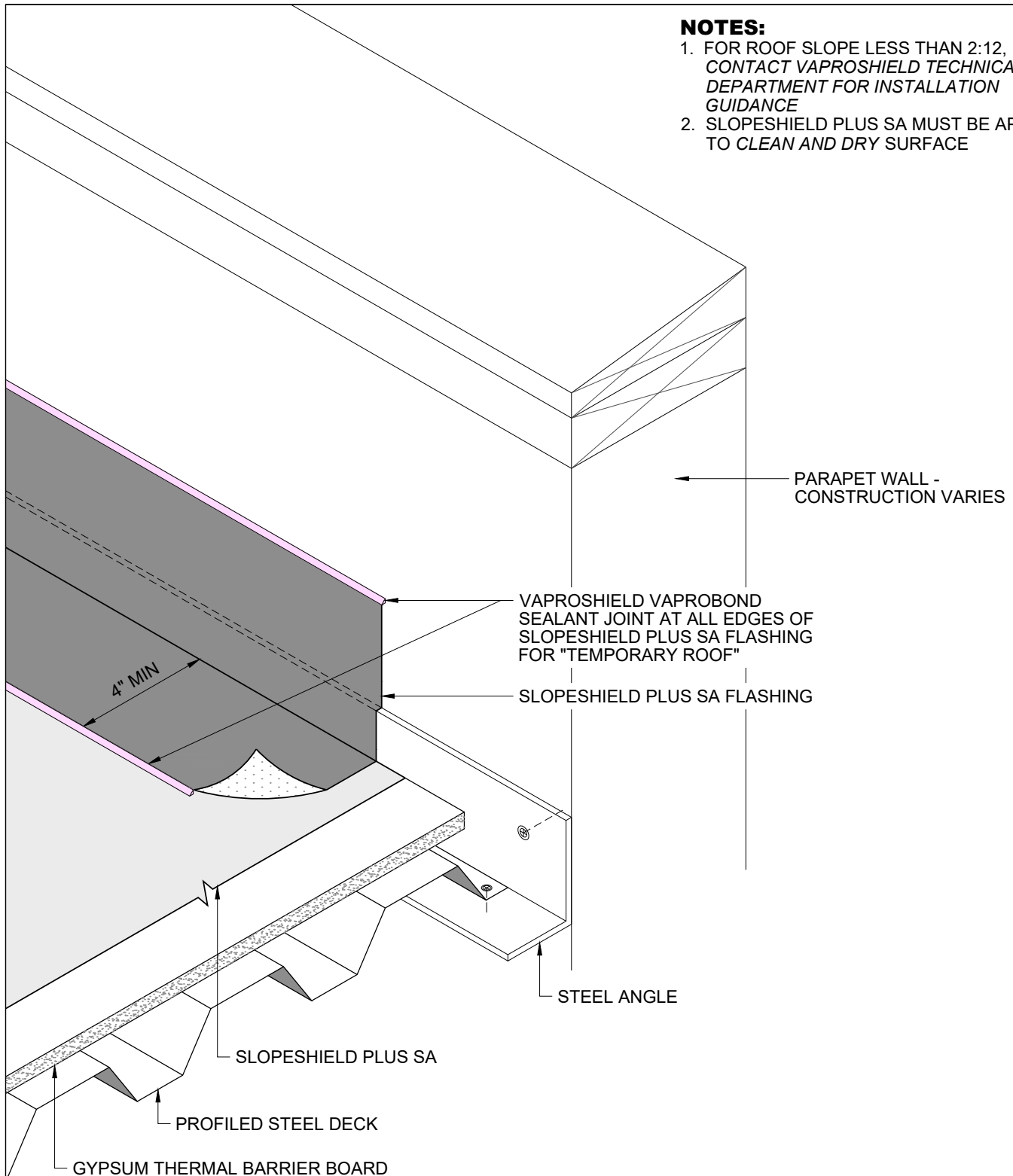
**VAPROSHIELD SLOPESHIELD PLUS SA**

TITLE: TEMPORARY ROOF -
VAPROBOND EDGE FLASHING

DATE: 08.03.2020

SCALE: NONE

STEEP SLOPE
2:12 OR GREATER

FILE:

SS-20

NOTES:

1. FOR ROOF SLOPE LESS THAN 2:12, CONTACT VAPROSHIELD TECHNICAL DEPARTMENT FOR INSTALLATION GUIDANCE
2. SLOPESHIELD PLUS SA MUST BE APPLIED TO CLEAN AND DRY SURFACE

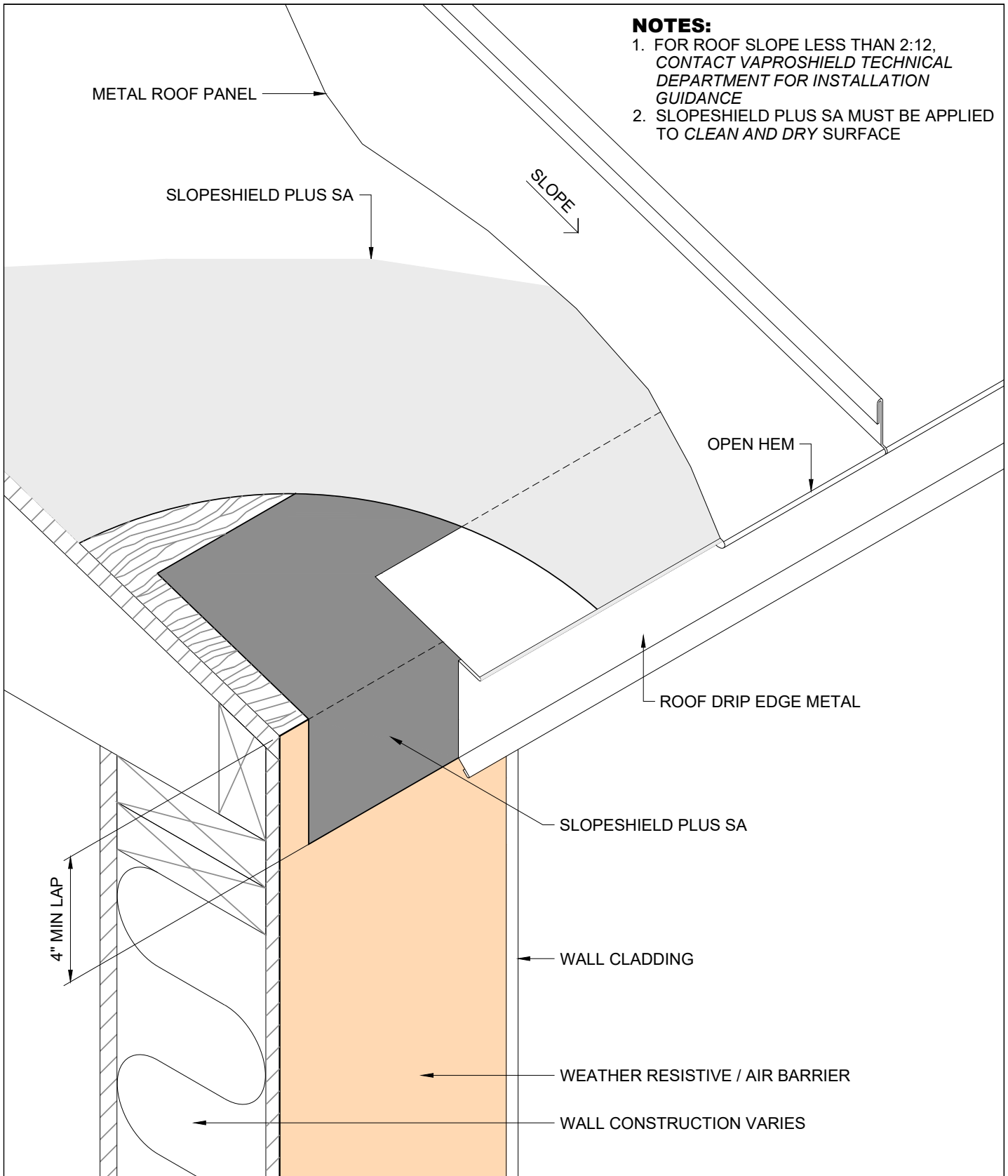

VAPROSHIELD SLOPESHIELD PLUS SA

TITLE: ROOF EAVE DETAIL

DATE: 08.03.2020

STEEP SLOPE
2:12 OR GREATER

FILE:

SS-21

SCALE: NONE

NOTES:

1. FOR ROOF SLOPE LESS THAN 2:12, CONTACT VAPROSHIELD TECHNICAL DEPARTMENT FOR INSTALLATION GUIDANCE
2. SLOPESHIELD PLUS SA MUST BE APPLIED TO CLEAN AND DRY SURFACE

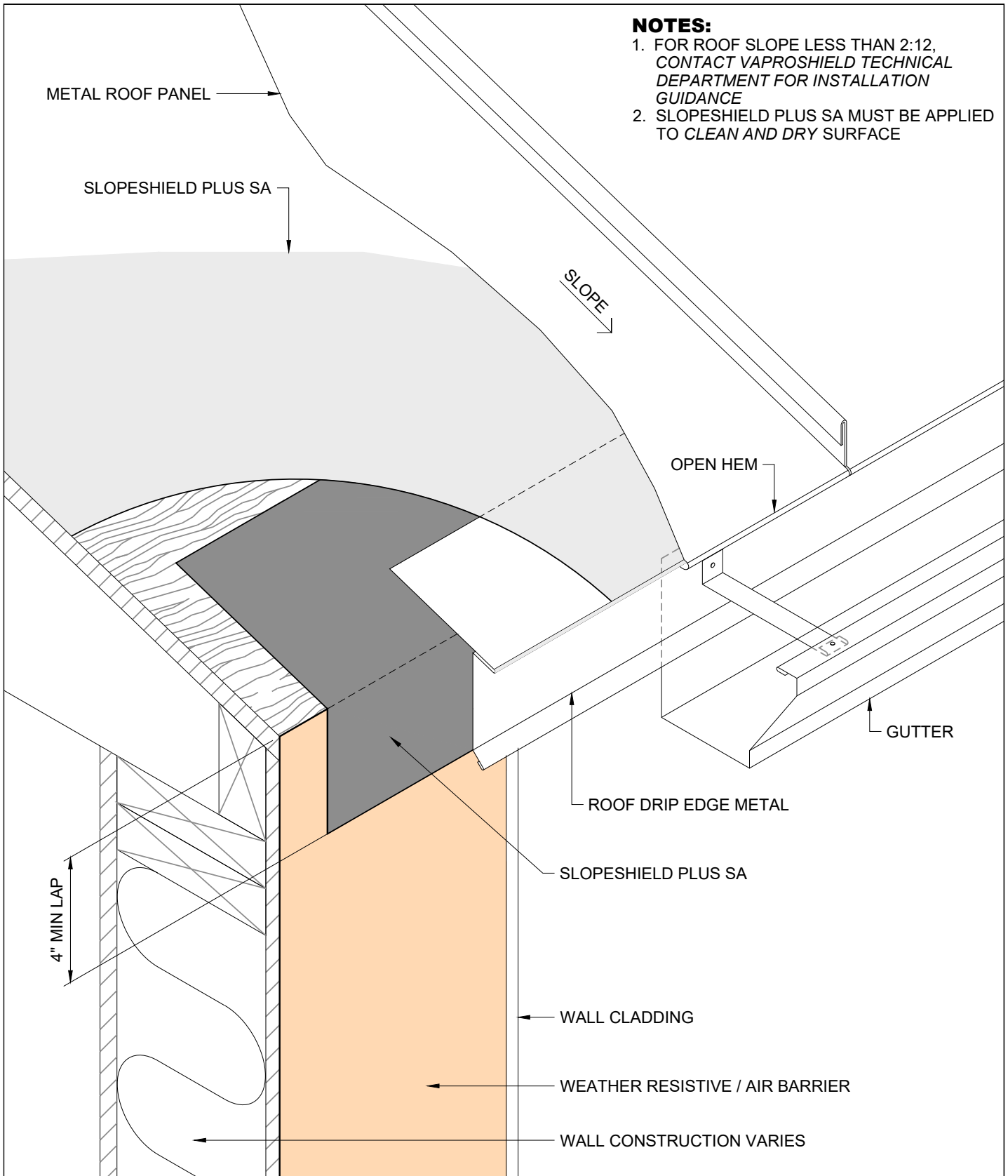

VAPROSHIELD SLOPESHIELD PLUS SA

TITLE: ROOF EAVE WITH GUTTER DETAIL

DATE: 08.03.2020

STEEP SLOPE
2:12 OR GREATER

SCALE: NONE

FILE:

SS-22

NOTES:

1. FOR ROOF SLOPE LESS THAN 2:12,
CONTACT VAPROSHIELD TECHNICAL
DEPARTMENT FOR INSTALLATION
GUIDANCE
2. SLOPESHIELD PLUS SA MUST BE APPLIED
TO CLEAN AND DRY SURFACE

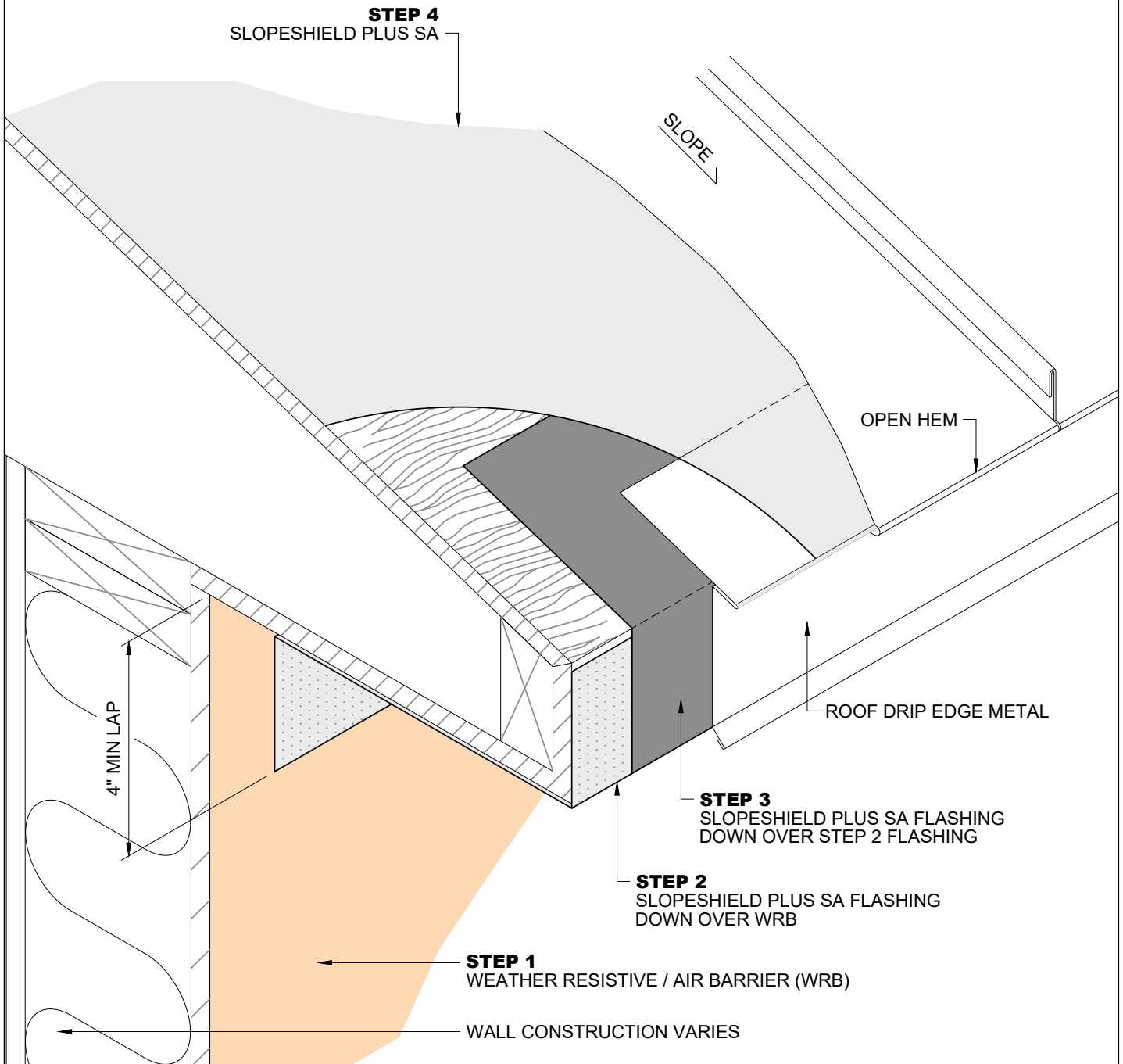

VAPROSHIELD SLOPESHIELD PLUS SA

TITLE: NON-VENTED WIDE SOFFIT DETAIL

DATE: 08.03.2020

STEEP SLOPE
2:12 OR GREATER

FILE:

SS-23

SCALE: NONE

NOTES:

1. FOR ROOF SLOPE LESS THAN 2:12,
CONTACT VAPROSHIELD TECHNICAL
DEPARTMENT FOR INSTALLATION
GUIDANCE
2. SLOPESHIELD PLUS SA MUST BE APPLIED
TO CLEAN AND DRY SURFACE

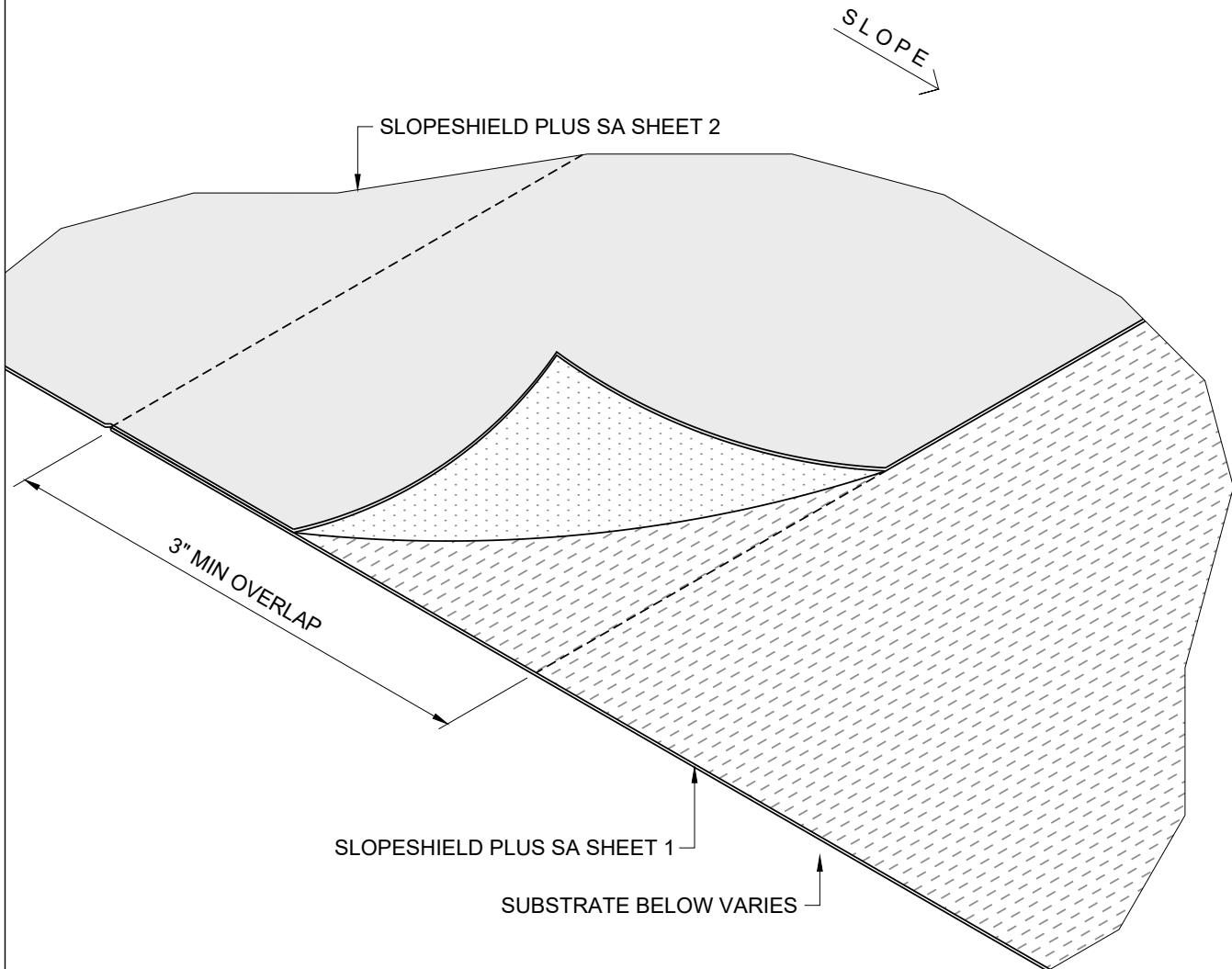

VAPROSHIELD SLOPESHIELD PLUS SA

TITLE: MEMBRANE SIDE LAP DETAIL

DATE: 08.03.2020

SCALE: NONE

STEEP SLOPE
2:12 OR GREATER

FILE:

SS-24

NOTES:

1. FOR ROOF SLOPE LESS THAN 2:12, CONTACT VAPROSHIELD TECHNICAL DEPARTMENT FOR INSTALLATION GUIDANCE
2. SLOPESHIELD PLUS SA MUST BE APPLIED TO CLEAN AND DRY SURFACE

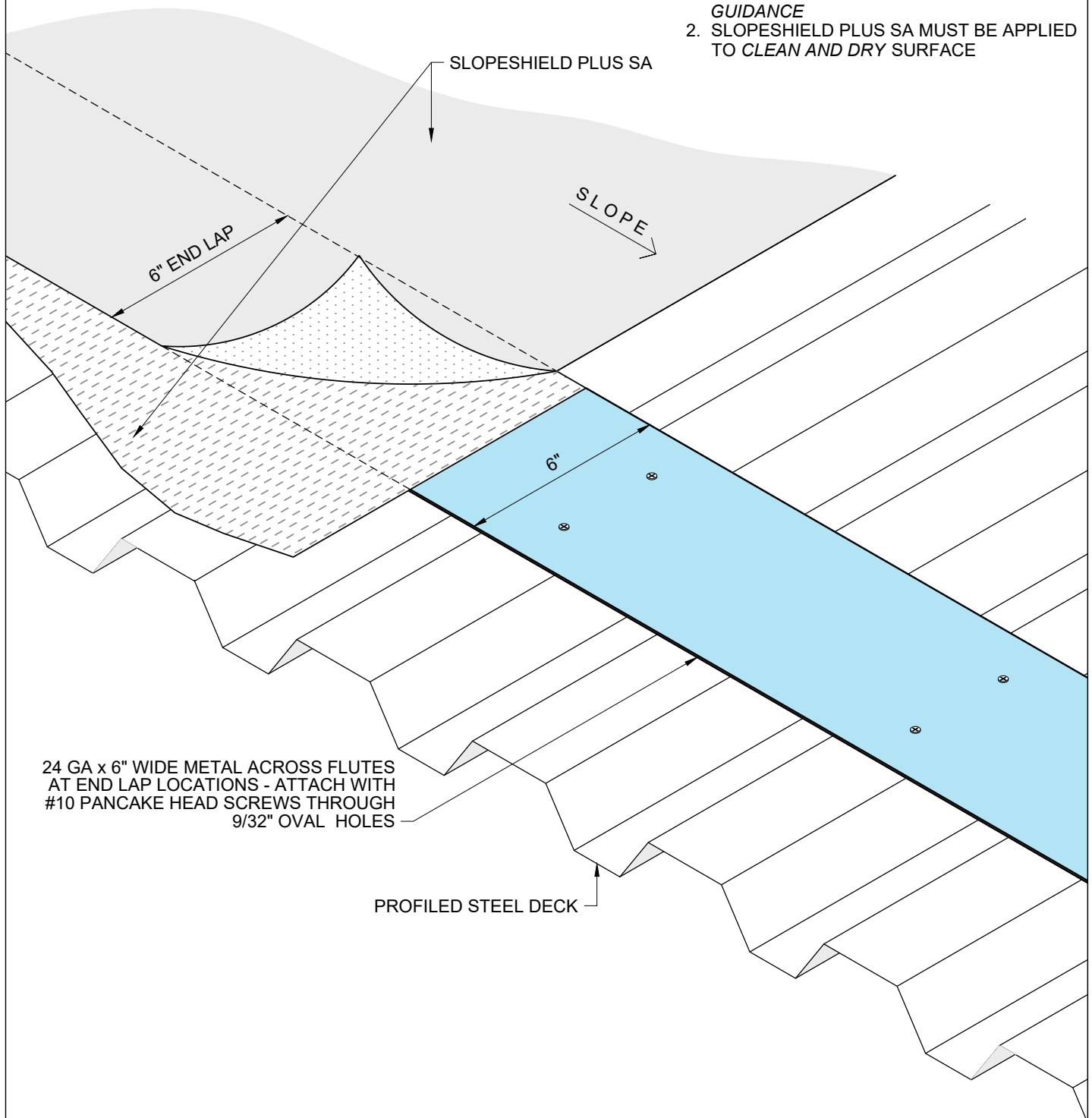

24 GA x 6" WIDE METAL ACROSS FLUTES
AT END LAP LOCATIONS - ATTACH WITH
#10 PANCAKE HEAD SCREWS THROUGH
9/32" OVAL HOLES

PROFILED STEEL DECK



VAPROSHIELD SLOPESHIELD PLUS SA

TITLE: END LAP MEMBRANE SUPPORT STRAP

DATE: 08.03.2020

SCALE: NONE

STEEP SLOPE
2:12 OR GREATER

FILE:

SS-25

NOTES:

1. FOR ROOF SLOPE LESS THAN 2:12,
CONTACT VAPROSHIELD TECHNICAL
DEPARTMENT FOR INSTALLATION
GUIDANCE
2. SLOPESHIELD PLUS SA MUST BE APPLIED
TO CLEAN AND DRY SURFACE

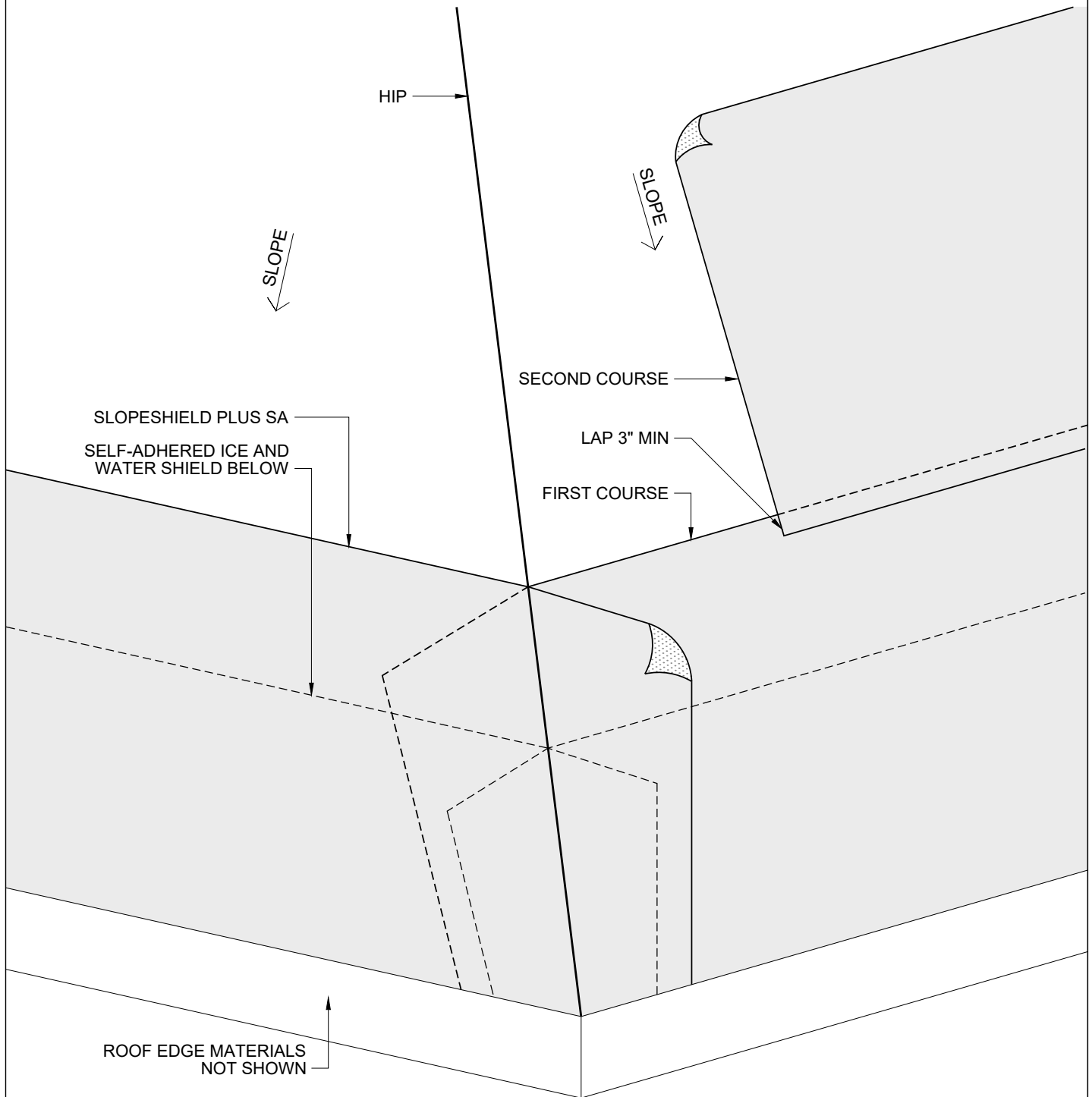

VAPROSHIELD SLOPESHIELD PLUS SA

TITLE: HIP DETAIL

DATE: 08.03.2020

SCALE: NONE

STEEP SLOPE
2:12 OR GREATER

FILE:

SS-26

NOTES:

1. FOR ROOF SLOPE LESS THAN 2:12, CONTACT VAPROSHIELD TECHNICAL DEPARTMENT FOR INSTALLATION GUIDANCE
2. SLOPESHIELD PLUS SA MUST BE APPLIED TO CLEAN AND DRY SURFACE

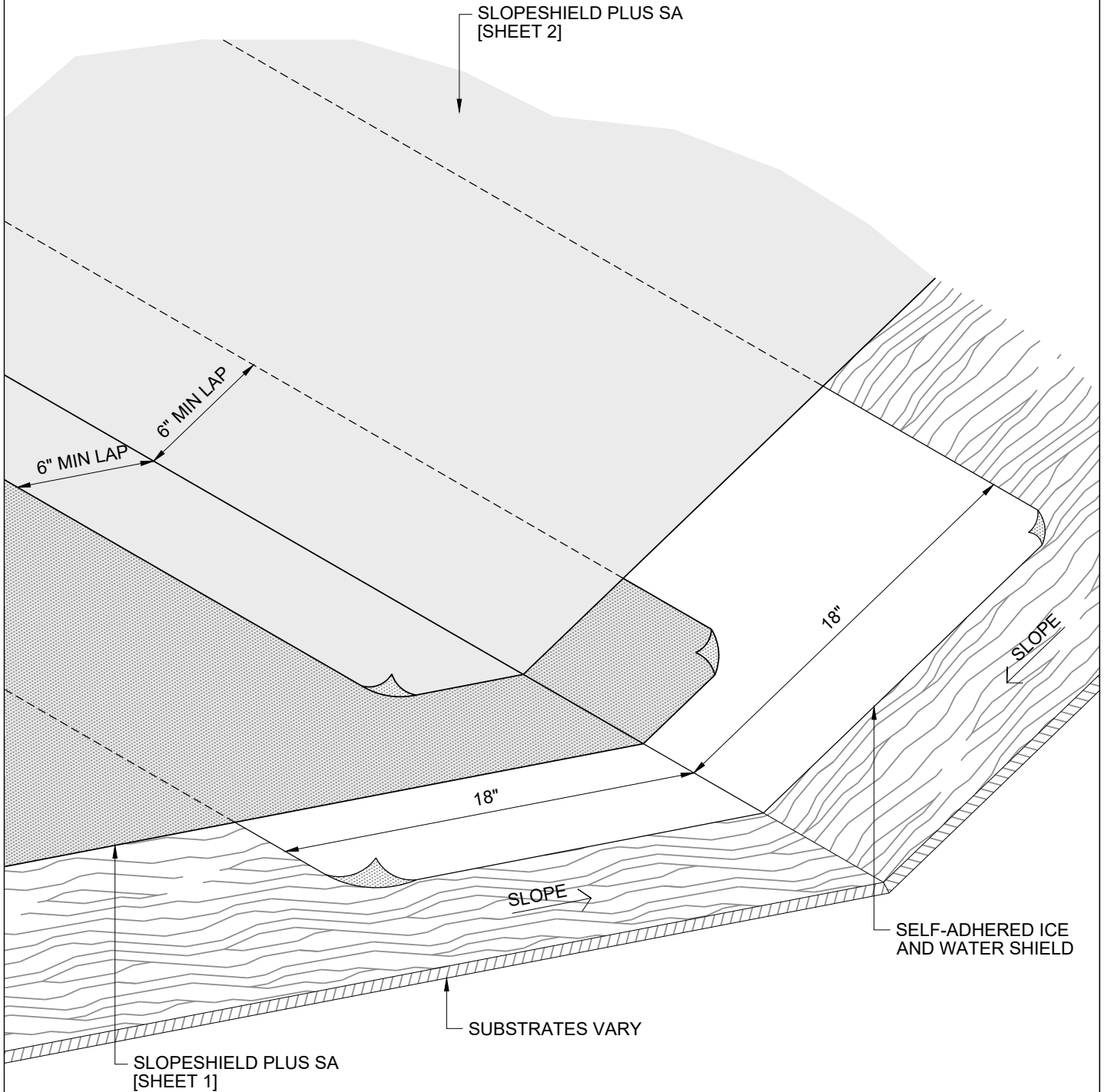

VAPROSHIELD SLOPESHIELD PLUS SA

TITLE: VALLEY DETAIL

DATE: 08.03.2020

SCALE: NONE

STEEP SLOPE
2:12 OR GREATER

FILE:

SS-27

NOTES:

1. FOR ROOF SLOPE LESS THAN 2:12,
CONTACT VAPROSHIELD TECHNICAL
DEPARTMENT FOR INSTALLATION
GUIDANCE
2. SLOPESHIELD PLUS SA MUST BE APPLIED
TO CLEAN AND DRY SURFACE

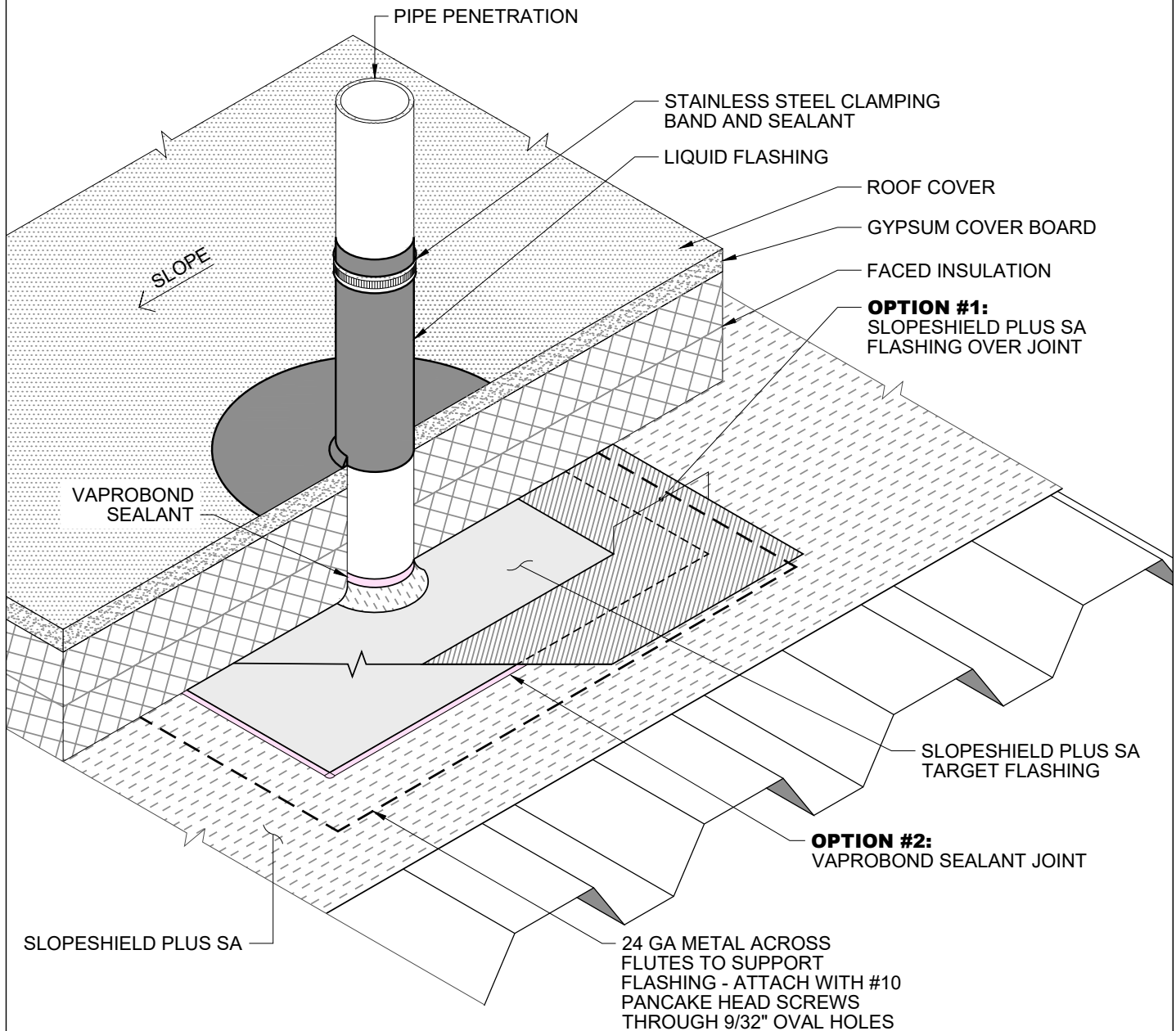

VAPROSHIELD SLOPESHIELD PLUS SA

TITLE: PIPE PENETRATION FLASHING DETAIL

DATE: 08.03.2020

STEEP SLOPE
2:12 OR GREATER

FILE:

SS-28

SCALE: NONE

NOTES:

1. FOR ROOF SLOPE LESS THAN 2:12, CONTACT VAPROSHIELD TECHNICAL DEPARTMENT FOR INSTALLATION GUIDANCE
2. SLOPESHIELD PLUS SA MUST BE APPLIED TO CLEAN AND DRY SURFACE

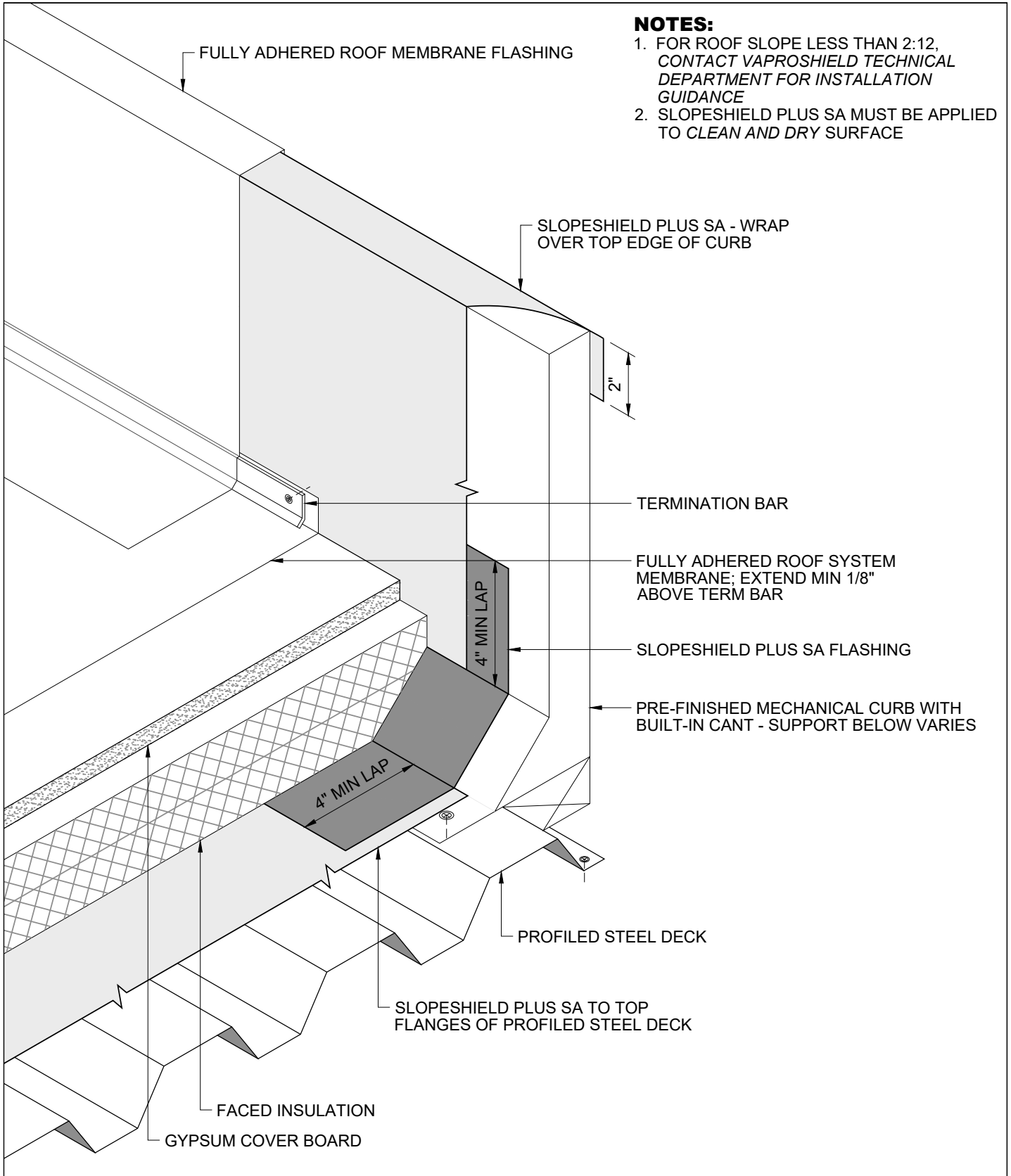

VAPROSHIELD SLOPESHIELD PLUS SA

TITLE: PREFABRICATED CURB FLASHING DETAIL

DATE: 08.03.2020

STEEP SLOPE
2:12 OR GREATER

FILE:

SS-29

SCALE: NONE

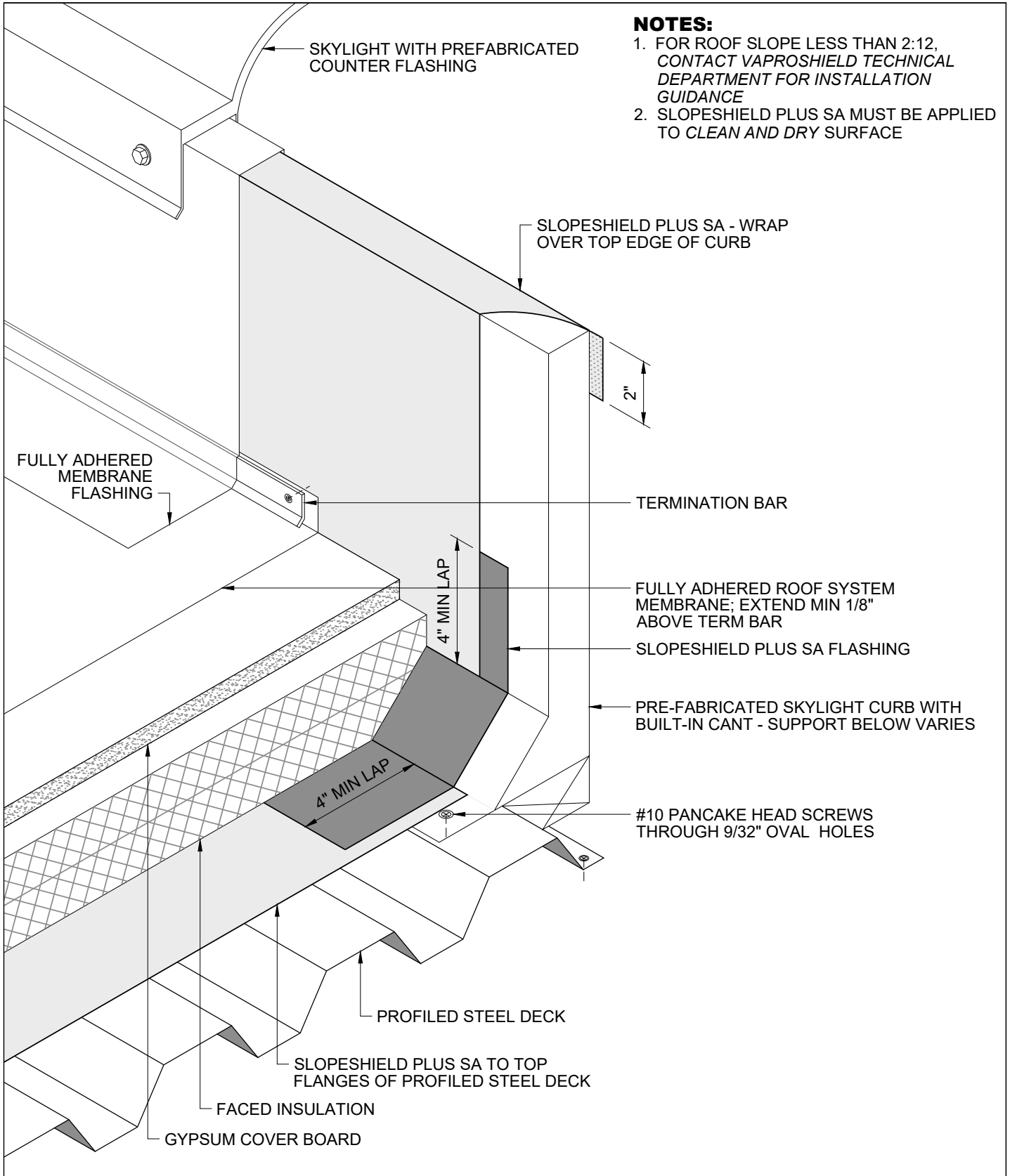

NOTES:

1. FOR ROOF SLOPE LESS THAN 2:12, CONTACT VAPROSHIELD TECHNICAL DEPARTMENT FOR INSTALLATION GUIDANCE
2. SLOPESHIELD PLUS SA MUST BE APPLIED TO CLEAN AND DRY SURFACE



VAPROSHIELD SLOPESHIELD PLUS SA

TITLE: SKYLIGHT FLASHING DETAIL

DATE: 08.03.2020

STEEP SLOPE
2:12 OR GREATER

FILE:

SS-30

SCALE: NONE