

RevealShield SA Self-Adhered over Dow Thermax Sheathing in Rain Screen Design

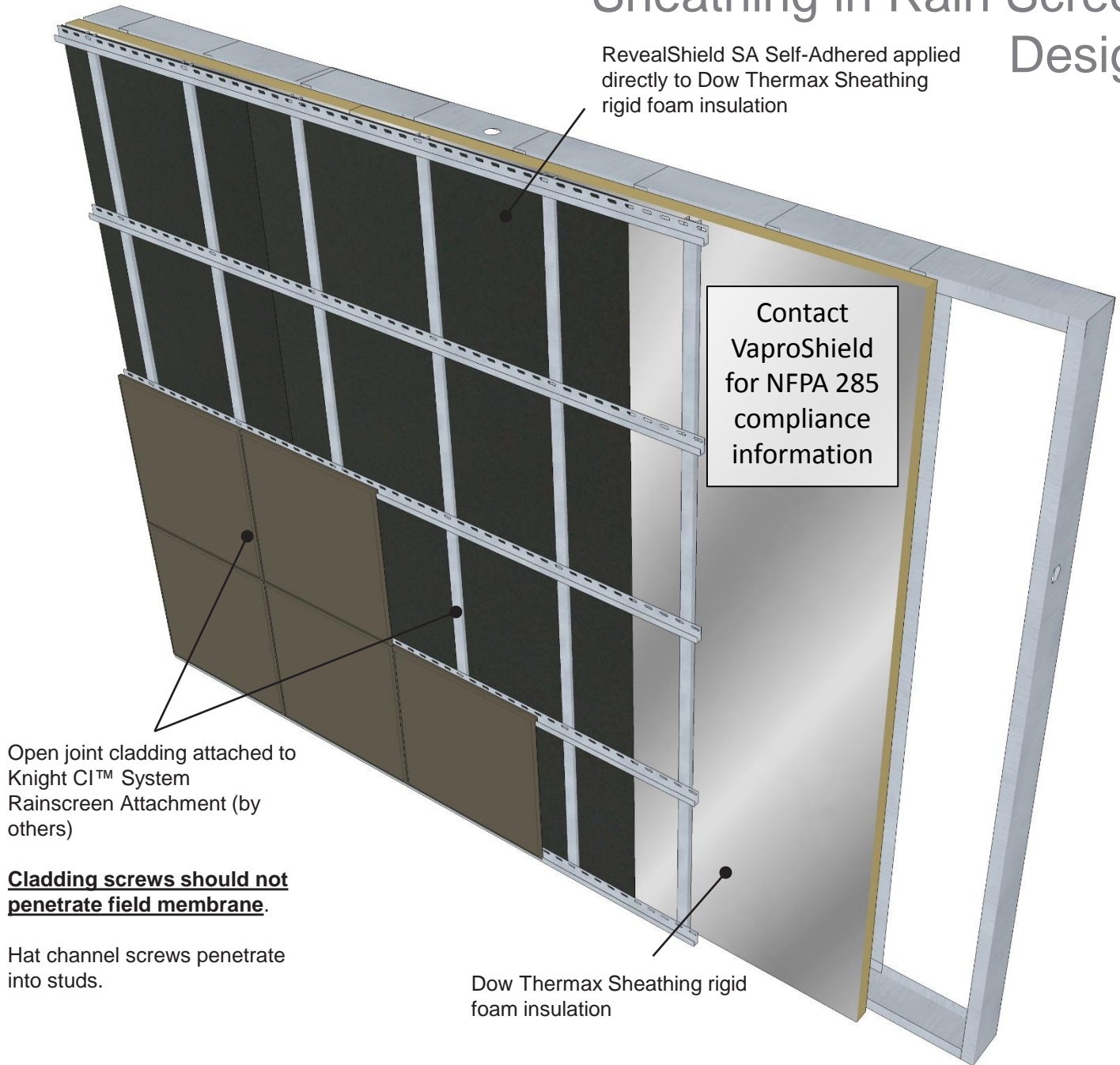

Open joint cladding attached to Knight CI™ System Rainscreen Attachment (by others)

Cladding screws should not penetrate field membrane.

Hat channel screws penetrate into studs.

Contact VaproShield for NFPA 285 compliance information

Dow Thermax Sheathing rigid foam insulation

REVEALSHIELD SA™ SELF-ADHERED

PRODUCT DESCRIPTION

RevealShield SA is a black, UV stable water resistive vapor permeable self-adhered air barrier membrane for open joint rain screen cladding systems

DISCLAIMER

Detail sketch is generic, representing suggested best practices for VaproShield materials, and does not represent a specific job site condition and therefore may not be applicable to certain projects. Detail sketch is designed for use as a reference and must be approved by the designer/consultant of record for each project prior to installation by the subcontractor. Changes and approvals of VaproShield details are the sole responsibility of the designer/consultant of record. VaproShield is **not** the designer of record for building enclosure details and takes no responsibility for the accuracy or interpretation of actual project site conditions.

DRAWN BY: AR

DATE: 09.06.16

REF: 176-E

Always check www.VaproShield.com for the latest details and installation instructions