

# Step 1: Commercial Window RO Flashing System with RevealFlashing SA

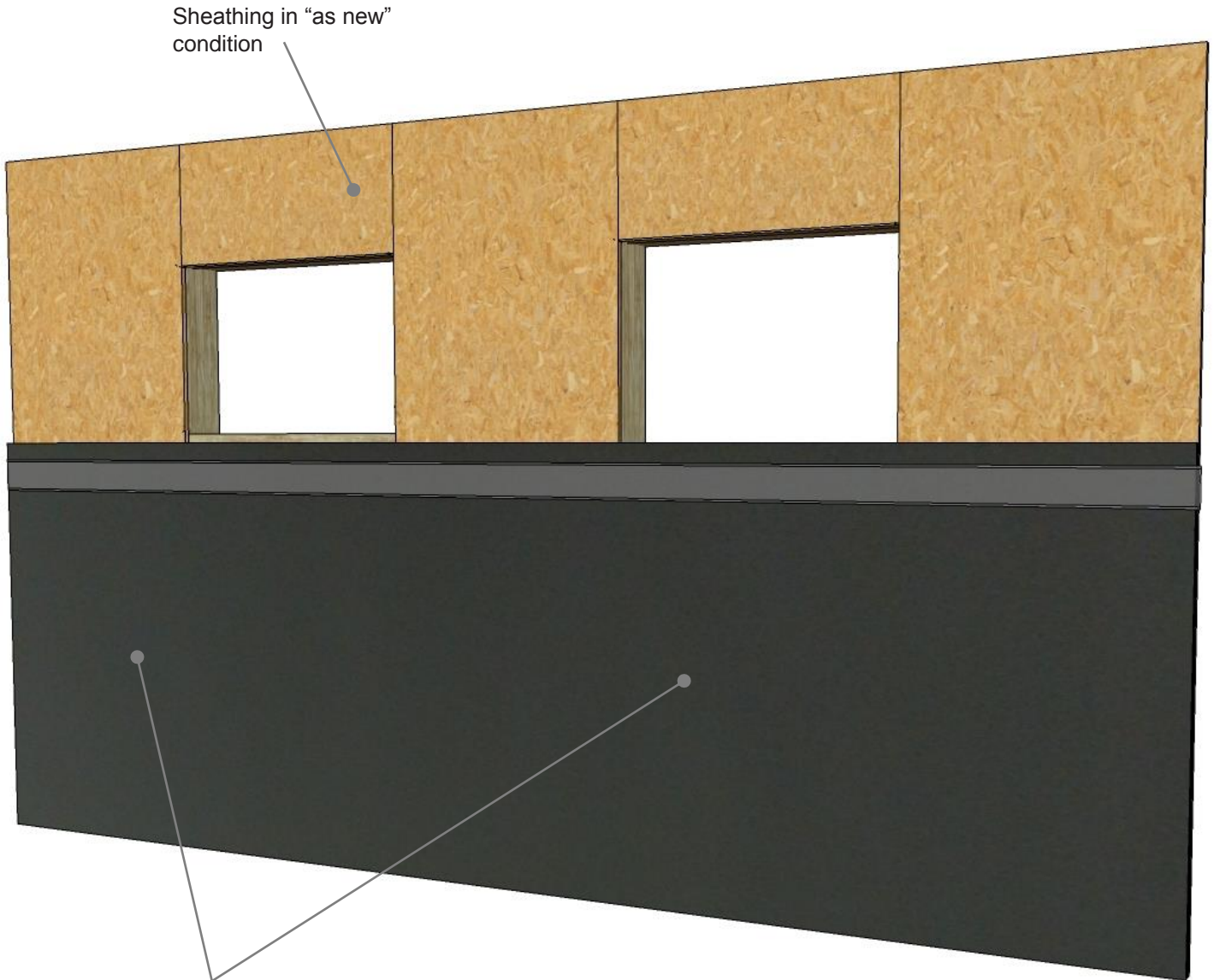

RevealShield IT Integrated Tape installed horizontally  
 - Field membrane spans across R.O. of full length R.O.

## REVEALSHIELD™ IT

Step 1: Install field membrane horizontally, lining up with bottom edge of VaproLiqui-Flash or spanning across rough opening

DRAWN BY: AR

DATE: 06.17.16

### PRODUCT DESCRIPTION

VaproLiqui-Flash is a liquid applied, vapor permeable, waterproof, air barrier flashing system component for window and door rough openings. VaproLiquiFlash is designed to work with VaproFlashing and VaproShield field membranes as a complete system.

RevealShield IT Integrated Tape is a mechanically attached, vapor permeable, water resistive air barrier membrane with integrated tape at the horizontal seams for use in open joint applications.

### DISCLAIMER

Detail sketch is generic, representing suggested best practices for VaproShield materials, and does not represent a specific job site condition and therefore may not be applicable to certain projects. Detail sketch is designed for use as a reference and must be approved by the designer/ consultant of record for each project prior to installation by the subcontractor. Changes and approvals of VaproShield details are the sole responsibility of the designer/consultant of record. VaproShield is **not** the designer of record for building enclosure details and takes no responsibility for the accuracy or interpretation of actual project site conditions.

REF: 174-1

Always check [www.VaproShield.com](http://www.VaproShield.com) for the latest details and installation instructions

# Step 2: Commercial Window RO Flashing System with RevealFlashing SA

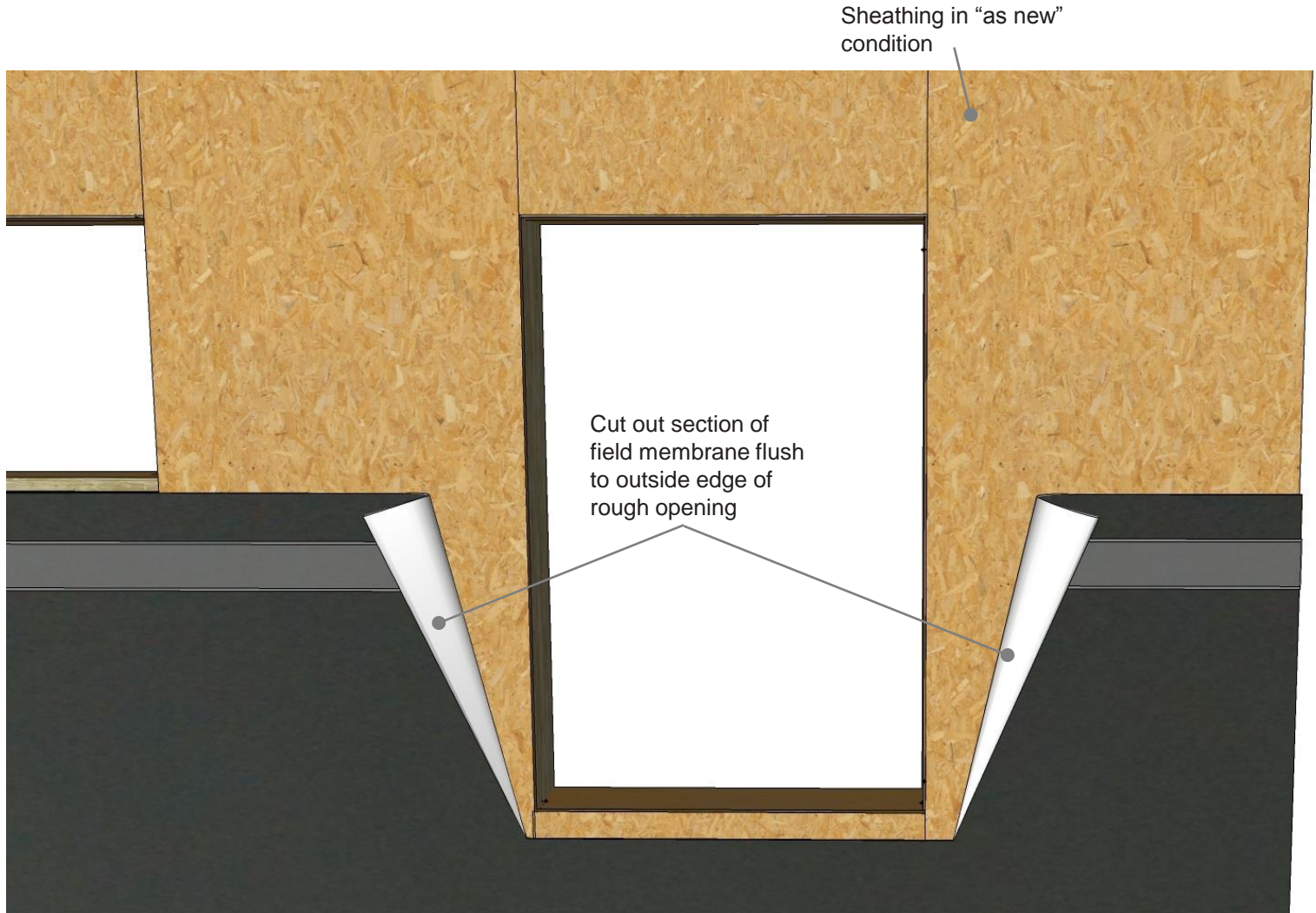

## REVEALSHIELD™ IT

Step 2: Cut out section of field membrane to expose covered rough opening.

### PRODUCT DESCRIPTION

VaproLiqui-Flash is a liquid applied, vapor permeable, waterproof, air barrier flashing system component for window and door rough openings. VaproLiquiFlash is designed to work with VaproFlashing and VaproShield field membranes as a complete system.

RevealShield IT Integrated Tape is a mechanically attached, vapor permeable, water resistive air barrier membrane with integrated tape at the horizontal seams for use in open joint applications.

### DISCLAIMER

Detail sketch is generic, representing suggested best practices for VaproShield materials, and does not represent a specific job site condition and therefore may not be applicable to certain projects. Detail sketch is designed for use as a reference and must be approved by the designer/ consultant of record for each project prior to installation by the subcontractor. Changes and approvals of VaproShield details are the sole responsibility of the designer/consultant of record. VaproShield is **not** the designer of record for building enclosure details and takes no responsibility for the accuracy or interpretation of actual project site conditions.

DRAWN BY: AR

DATE: 06.17.16

REF: 174-2

Always check [www.VaproShield.com](http://www.VaproShield.com) for the latest details and installation instructions

# Step 3: Commercial Window RO Flashing System with RevealFlashing SA

Sheathing in "as new" condition

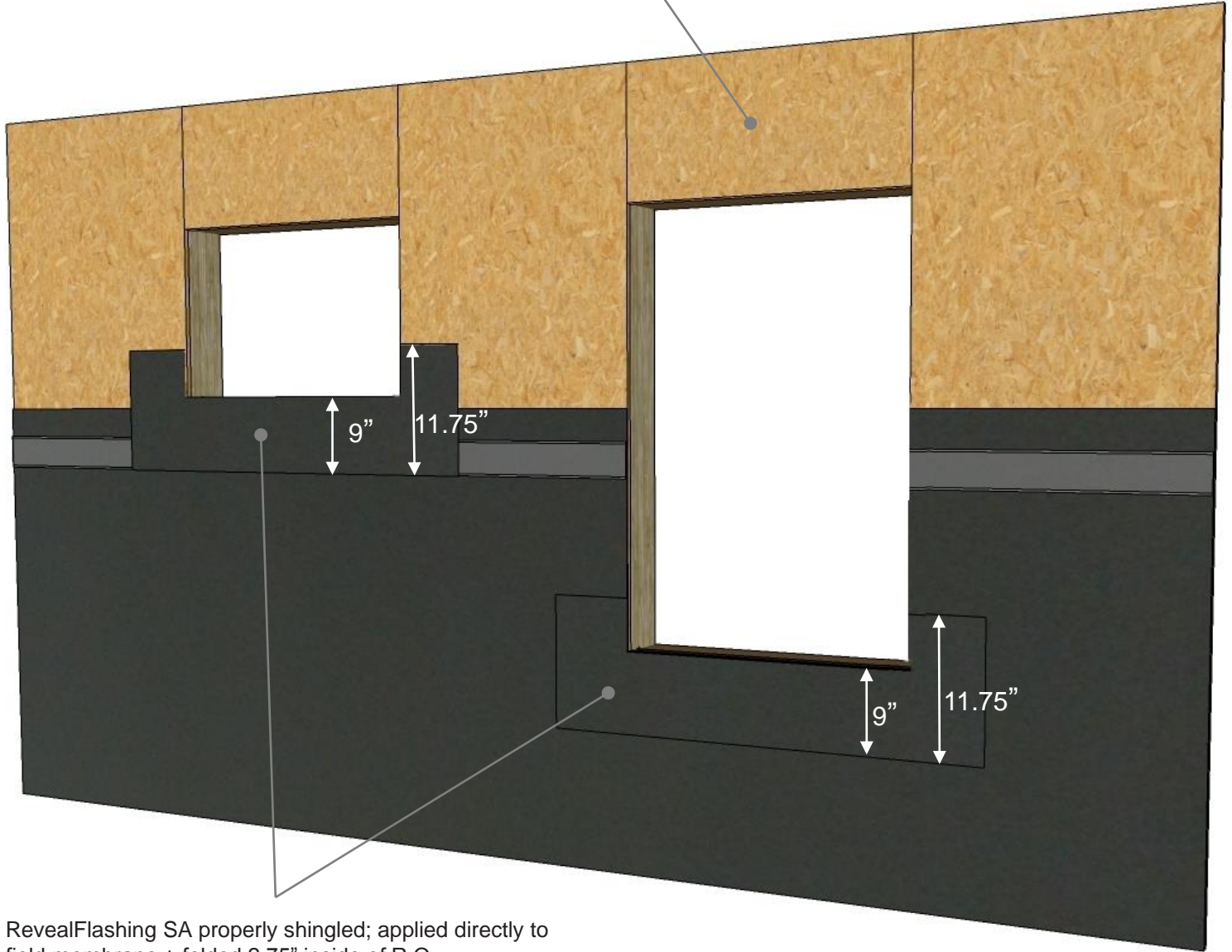

RevealFlashing SA properly shingled; applied directly to field membrane + folded 2.75" inside of R.O.

**Note:** Total of 11.75" of flashing should be used:

- 9" of flashing should shingled over field membrane

## REVEALSHIELD™ IT

### PRODUCT DESCRIPTION

VaproLiqui-Flash is a liquid applied, vapor permeable, waterproof, air barrier flashing system component for window and door rough openings. VaproLiquiFlash is designed to work with VaproFlashing and VaproShield field membranes as a complete system.

RevealShield IT Integrated Tape is a mechanically attached, vapor permeable, water resistive air barrier membrane with integrated tape at the horizontal seams for use in open joint applications.

### DISCLAIMER

Detail sketch is generic, representing suggested best practices for VaproShield materials, and does not represent a specific job site condition and therefore may not be applicable to certain projects. Detail sketch is designed for use as a reference and must be approved by the designer/ consultant of record for each project prior to installation by the subcontractor. Changes and approvals of VaproShield details are the sole responsibility of the designer/consultant of record. VaproShield is **not** the designer of record for building enclosure details and takes no responsibility for the accuracy or interpretation of actual project site conditions.

Step 3: Inspect rough opening, Install RevealFlashing SA to Sill of R.O. with 2.75" folded inside R.O. and 9" left on face.

DRAWN BY: AR

DATE: 06.17.16

REF: 174-3

Always check [www.VaproShield.com](http://www.VaproShield.com) for the latest details and installation instructions

# Step 4: Commercial Window RO Flashing System with RevealFlashing SA

RevealFlashing SA jamb pieces properly shingled, over sill piece and folded 2.75" inside of R.O.

Sheathing in "as new" condition

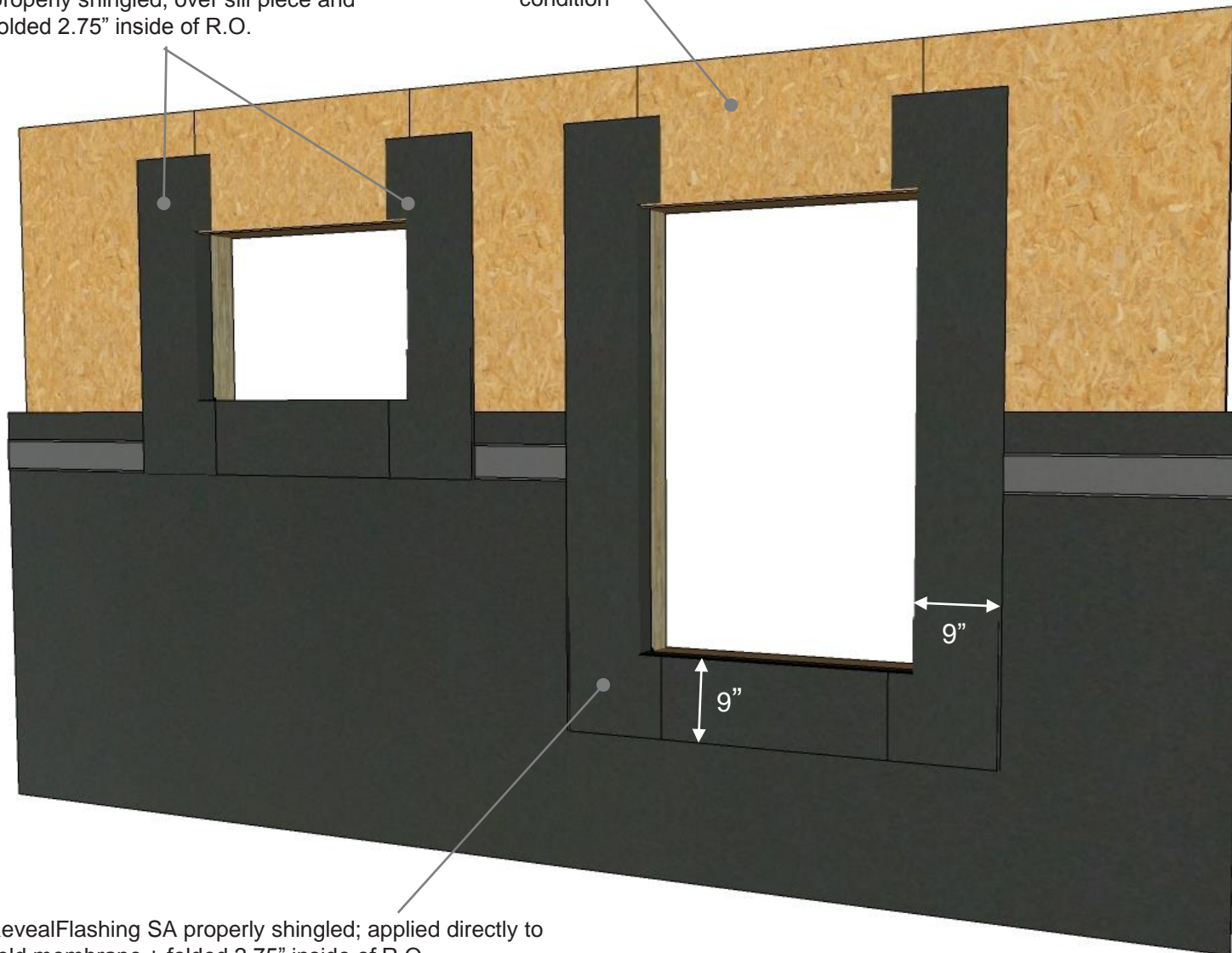

RevealFlashing SA properly shingled; applied directly to field membrane + folded 2.75" inside of R.O.

**Note:** Total of 11.75" of flashing should be used:

- 9" of flashing should be shingled over field membrane

## REVEALSHIELD™ IT

Step 4: Install RevealFlashing SA to Jamb of R.O. with 2.75" folded inside R.O. and 9" left on face, shingled over Sill piece.

DRAWN BY: AR

DATE: 06.17.16

### PRODUCT DESCRIPTION

VaproLiqui-Flash is a liquid applied, vapor permeable, waterproof, air barrier flashing system component for window and door rough openings. VaproLiquiFlash is designed to work with VaproFlashing and VaproShield field membranes as a complete system.

RevealShield IT Integrated Tape is a mechanically attached, vapor permeable, water resistive air barrier membrane with integrated tape at the horizontal seams for use in open joint applications.

### DISCLAIMER

Detail sketch is generic, representing suggested best practices for VaproShield materials, and does not represent a specific job site condition and therefore may not be applicable to certain projects. Detail sketch is designed for use as a reference and must be approved by the designer/consultant of record for each project prior to installation by the subcontractor. Changes and approvals of VaproShield details are the sole responsibility of the designer/consultant of record. VaproShield is **not** the designer of record for building enclosure details and takes no responsibility for the accuracy or interpretation of actual project site conditions.

# Step 5: Commercial Window RO Flashing System with RevealFlashing SA

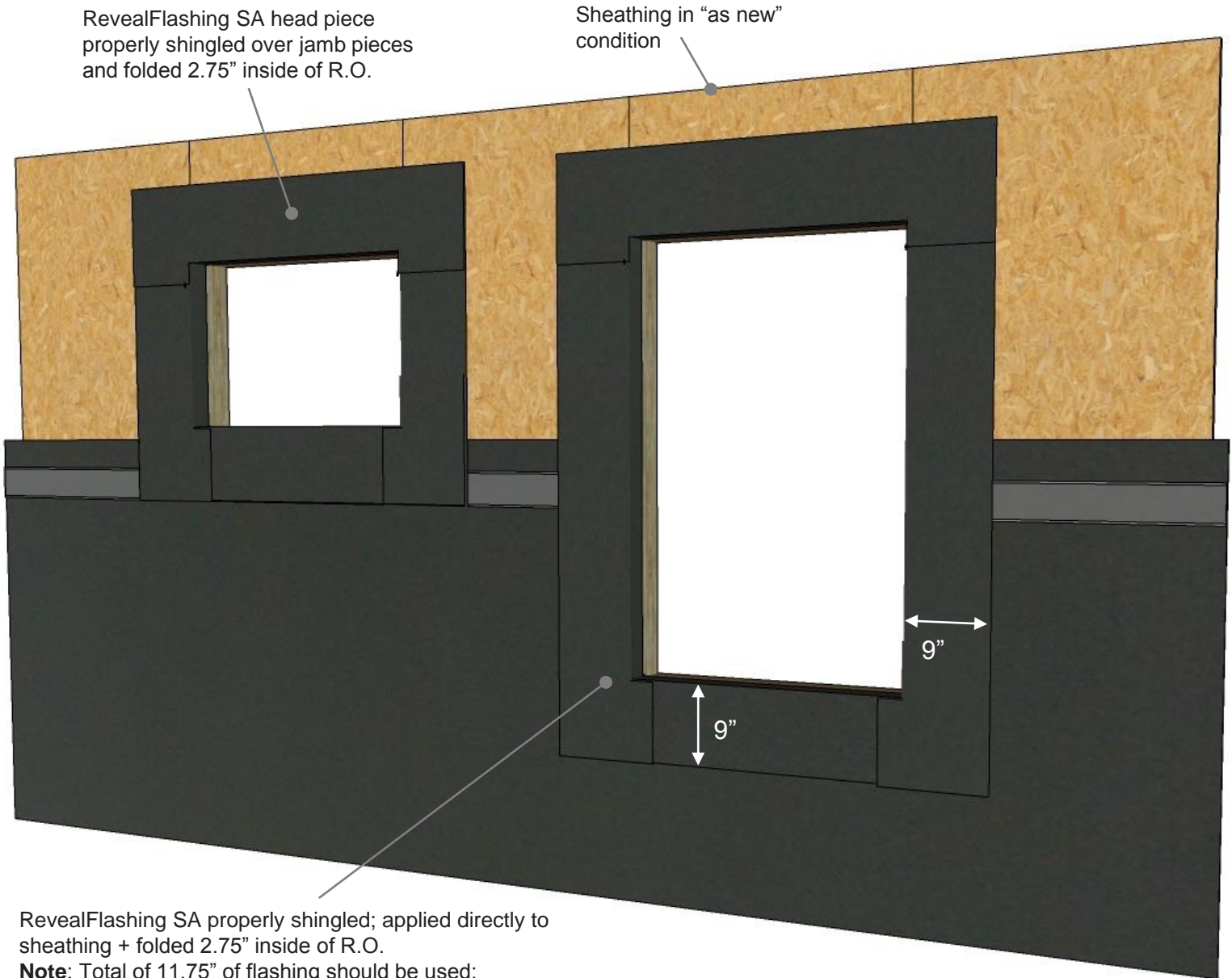

RevealFlashing SA properly shingled; applied directly to sheathing + folded 2.75" inside of R.O.

**Note:** Total of 11.75" of flashing should be used:

- 9" of flashing should be left on the face of the sheathing

## REVEALSHIELD™ IT

### PRODUCT DESCRIPTION

VaproLiqui-Flash is a liquid applied, vapor permeable, waterproof, air barrier flashing system component for window and door rough openings. VaproLiquiFlash is designed to work with VaproFlashing and VaproShield field membranes as a complete system.

RevealShield IT Integrated Tape is a mechanically attached, vapor permeable, water resistive air barrier membrane with integrated tape at the horizontal seams for use in open joint applications.

### DISCLAIMER

Detail sketch is generic, representing suggested best practices for VaproShield materials, and does not represent a specific job site condition and therefore may not be applicable to certain projects. Detail sketch is designed for use as a reference and must be approved by the designer/consultant of record for each project prior to installation by the subcontractor. Changes and approvals of VaproShield details are the sole responsibility of the designer/consultant of record. VaproShield is **not** the designer of record for building enclosure details and takes no responsibility for the accuracy or interpretation of actual project site conditions.

Step 5: Install RevealFlashing SA to Head of R.O. with 2.75" folded inside R.O. and 9" left on face, shingled over Jamb pieces.

DRAWN BY: AR

DATE: 06.17.16

REF: 174-5

Always check [www.VaproShield.com](http://www.VaproShield.com) for the latest details and installation instructions

# Step 6: Commercial Window RO Flashing System with RevealFlashing SA

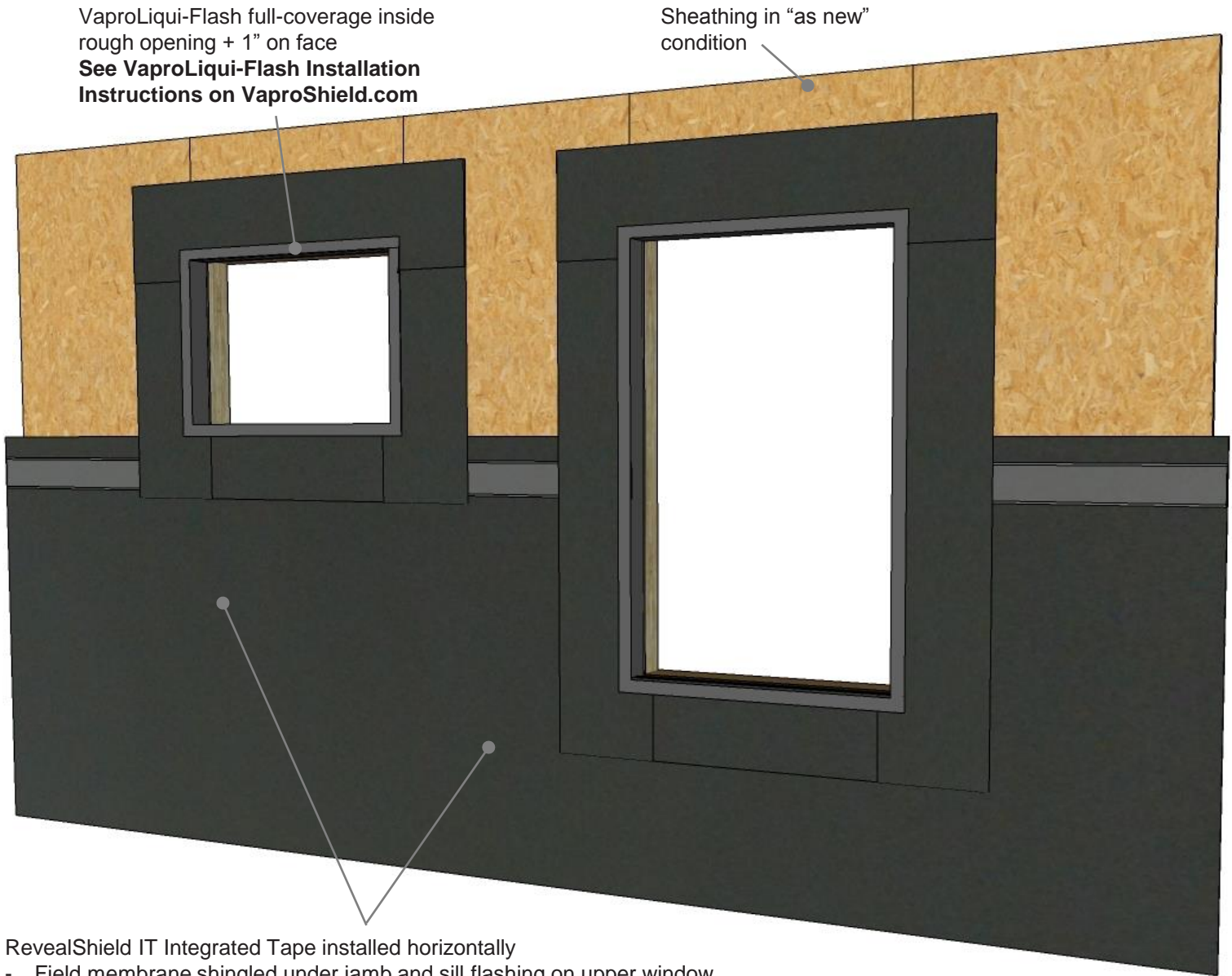

- RevealShield IT Integrated Tape installed horizontally
- Field membrane shingled under jamb and sill flashing on upper window
  - **Field membrane with R.O. section cut out shingled under jamb and sill flashing**

## REVEALSHIELD™ IT

### PRODUCT DESCRIPTION

VaproLiqui-Flash is a liquid applied, vapor permeable, waterproof, air barrier flashing system component for window and door rough openings. VaproLiquiFlash is designed to work with VaproFlashing and VaproShield field membranes as a complete system.

RevealShield IT Integrated Tape is a mechanically attached, vapor permeable, water resistive air barrier membrane with integrated tape at the horizontal seams for use in open joint applications.

### DISCLAIMER

Detail sketch is generic, representing suggested best practices for VaproShield materials, and does not represent a specific job site condition and therefore may not be applicable to certain projects. Detail sketch is designed for use as a reference and must be approved by the designer/ consultant of record for each project prior to installation by the subcontractor. Changes and approvals of VaproShield details are the sole responsibility of the designer/consultant of record. VaproShield is **not** the designer of record for building enclosure details and takes no responsibility for the accuracy or interpretation of actual project site conditions.

Step 6: Apply VaproLiqui-Flash complete coverage inside rough opening + 1" on face.

DRAWN BY: AR

DATE: 06.17.16

REF: 174-6

Always check [www.VaproShield.com](http://www.VaproShield.com) for the latest details and installation instructions

# Step 7: Commercial Window RO Flashing System with RevealFlashing SA

VaproLiqui-Flash full-coverage inside rough opening + 1" on face  
**See VaproLiqui-Flash Installation Instructions on VaproShield.com**

- RevealShield IT Integrated Tape installed horizontally
- Field membrane cut flush with edge of R.O.
  - **Left unattached until window and head flashing are installed**

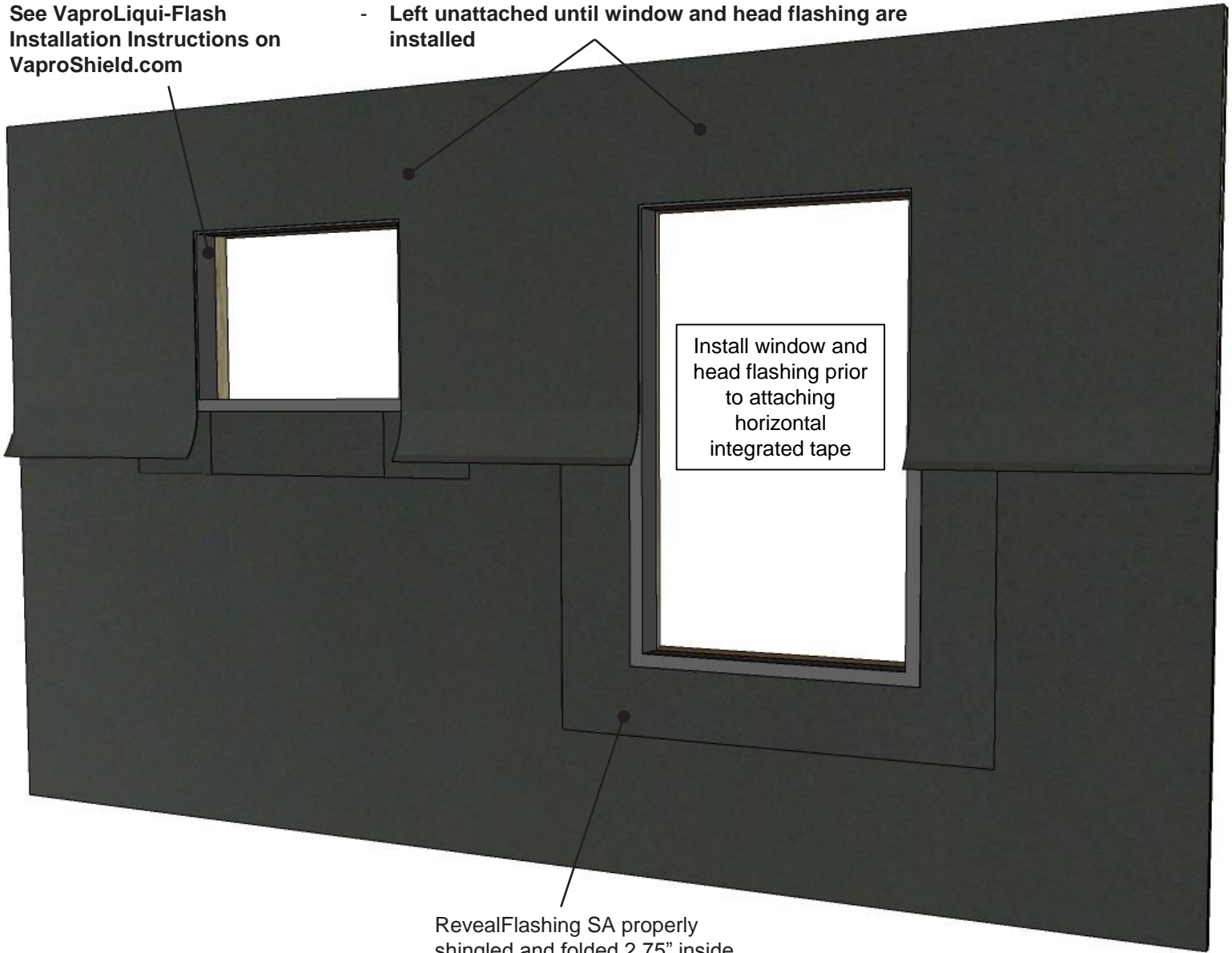

RevealFlashing SA properly shingled and folded 2.75" inside of R.O.

## REVEALSHIELD™ IT

Step 7: Install field membrane horizontally, lining up integrated tape seams. Rough openings should be cut out, with VaproLiqui-Flash covered.

DRAWN BY: AR

DATE: 06.17.16

### PRODUCT DESCRIPTION

VaproLiqui-Flash is a liquid applied, vapor permeable, waterproof, air barrier flashing system component for window and door rough openings. VaproLiquiFlash is designed to work with VaproFlashing and VaproShield field membranes as a complete system.

RevealShield IT Integrated Tape is a mechanically attached, vapor permeable, water resistive air barrier membrane with integrated tape at the horizontal seams for use in open joint applications.

### DISCLAIMER

Detail sketch is generic, representing suggested best practices for VaproShield materials, and does not represent a specific job site condition and therefore may not be applicable to certain projects. Detail sketch is designed for use as a reference and must be approved by the designer/ consultant of record for each project prior to installation by the subcontractor. Changes and approvals of VaproShield details are the sole responsibility of the designer/consultant of record. VaproShield is **not** the designer of record for building enclosure details and takes no responsibility for the accuracy or interpretation of actual project site conditions.