

# Vapro-SS Flashing Window Rough Opening Sequencing Exploded View

1. WrapFlashing SA Self-Adhered sill piece applied directly to sheathing + folded 2.75" inside of R.O. Leave release film on lower 6" to shingle over field membrane.
2. WrapFlashing SA Jamb Pieces applied directly to sheathing + folded 2.75" inside R.O.
3. WrapFlashing SA head piece applied directly to sheathing + folded 2.75" inside of R.O.
4. Vapro-SS Flashing installed in shingle fashion (sill, jambs, head) with 3" up-turned legs at sill and head + 1" on face; jambs are 1" onto the face. **Perimeter of Vapro-SS Flashing on face of wall to be sealed with VaproBond.**
5. VaproBond or VaproLiqui-Flash ½" tooled fillet bead at each corner where inside of R.O. meets face of sheathing. Ref. Figure 1.
6. Window installation and sealant joints + backer rod (by others)
7. Head flashing (by others) over Vapro-SS Flashing + embedded in VaproBond.

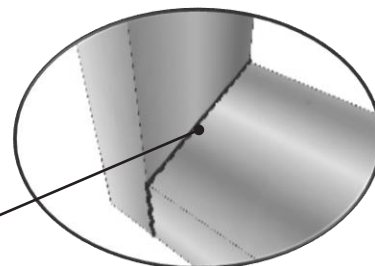
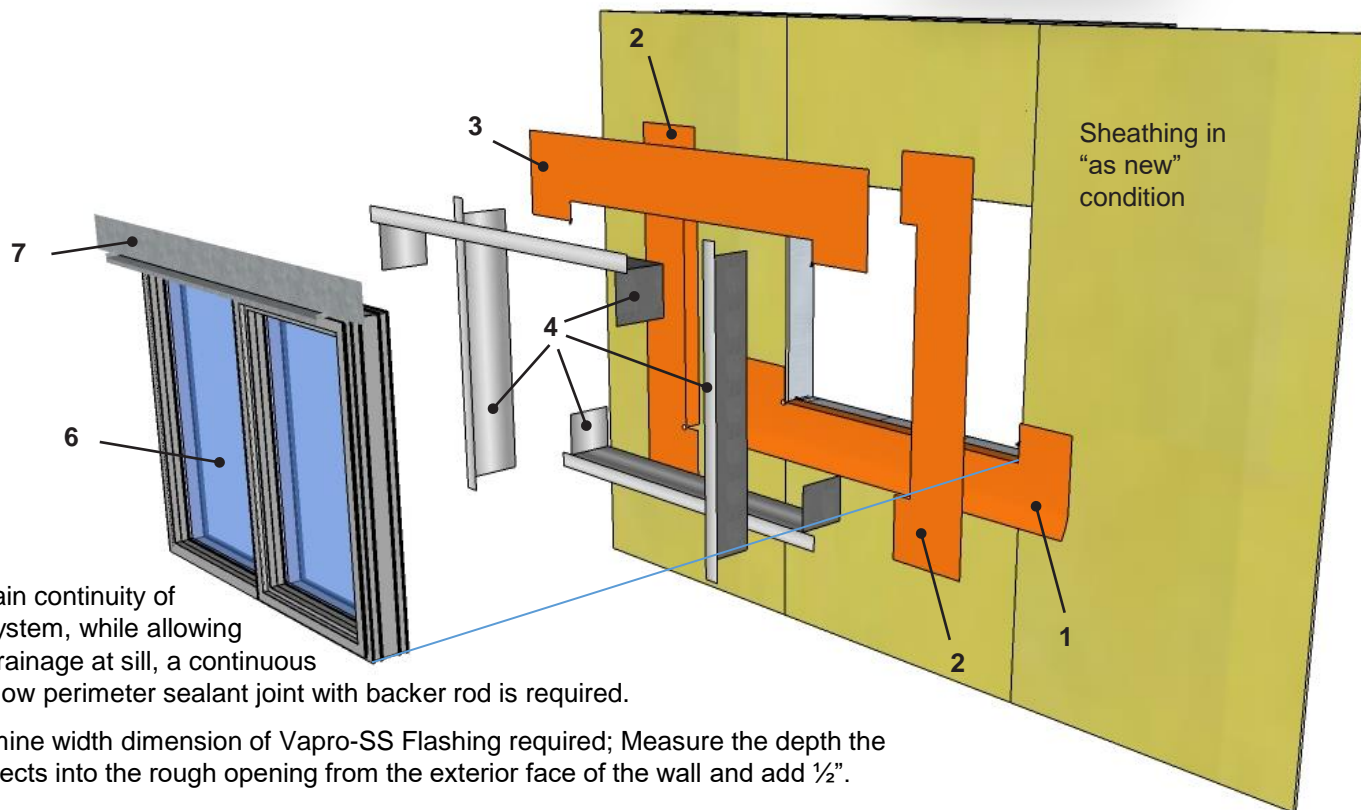

Figure 1, Close-up of corner



## Notes:

- To maintain continuity of air barrier system, while allowing for proper drainage at sill, a continuous interior window perimeter sealant joint with backer rod is required.
- To determine width dimension of Vapro-SS Flashing required; Measure the depth the window projects into the rough opening from the exterior face of the wall and add ½".
- Vapro-SS Flashing available in 4", 6", 9", 12", 18", or 24" widths by 50' length rolls

## VAPRO-SS FLASHING™

### PRODUCT DESCRIPTION

Vapro-SS Flashing is a stainless steel, butyl adhesive backed flexible, waterproof, air barrier flashing system component for window and door rough openings.

### DISCLAIMER

Detail sketch is generic, representing suggested best practices for VaproShield materials, and does not represent a specific job site condition and therefore may not be applicable to certain projects. Detail sketch is designed for use as a reference and must be approved by the designer/ consultant of record for each project prior to installation by the subcontractor. Changes and approvals of VaproShield details are the sole responsibility of the designer/consultant of record. VaproShield is **not** the designer of record for building enclosure details and takes no responsibility for the accuracy or interpretation of actual project site conditions.

DRAWN BY: CAD Detail

DATE: 10/12/2022

REF: 129

Always check [www.VaproShield.com](http://www.VaproShield.com) for the latest details and installation instructions