

RevealShield WRB Membrane Joints

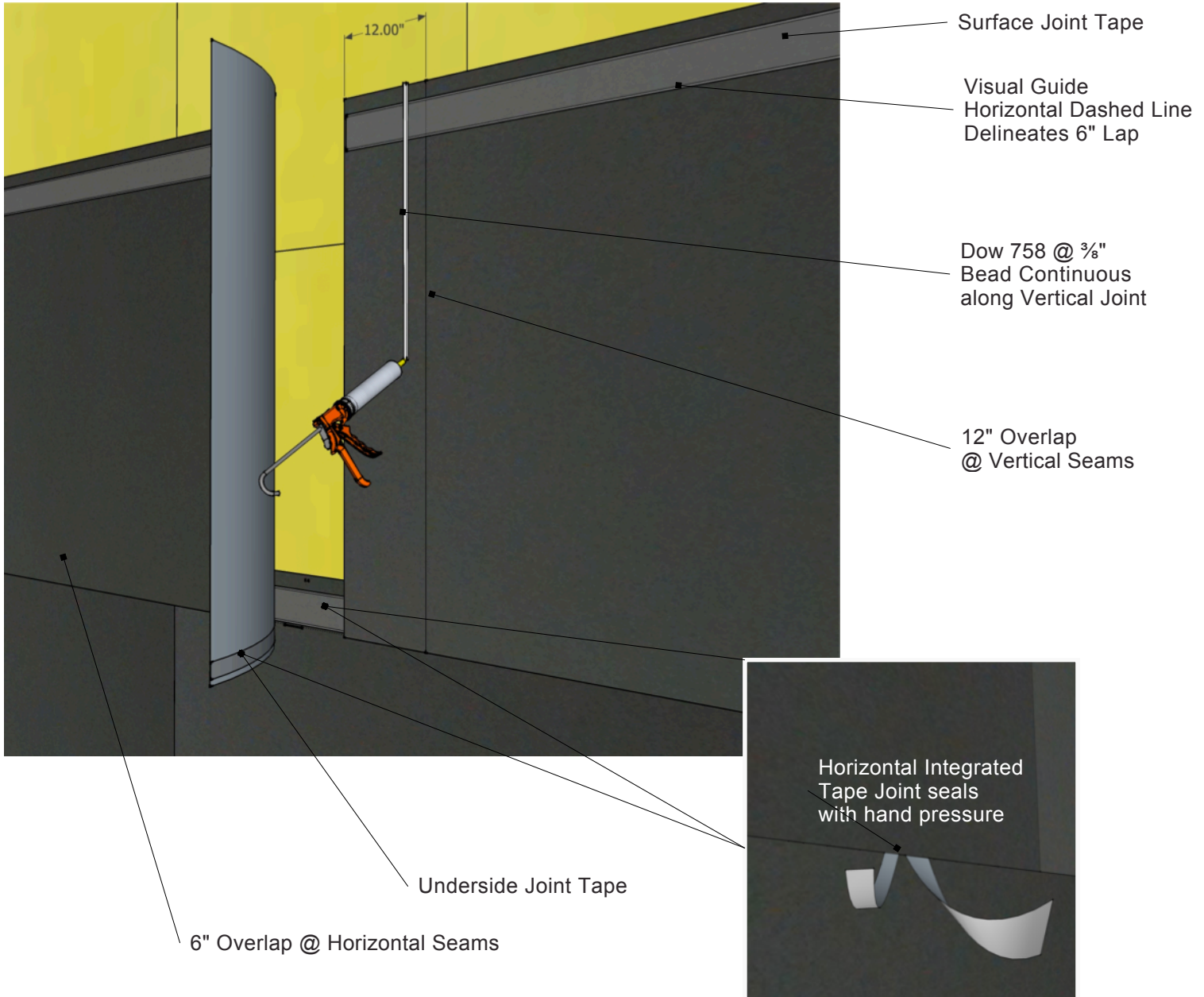

REVEALSHIELD™

ATTRIBUTES:

- Black UV Stable Material
- Integrated Horizontal Joint Tape
- Single Layer Installation
- Air Barrier + Weather-Resistive Barrier
- Highly Vapor Permeable
- Designed for Open Joint Cladding

DESCRIPTION:

RevealShield with VaproLiqui-Flash + RevealFlashing or VaproFlashing SA (Self-Adhered) creates a continuous air barrier membrane over gypsum or plywood sheathing, concrete, and CMU substrates.

DRAWN BY: AFG DATE: 23.09.2012

Always check www.vaproshield.com for the latest details and installation instructions