

**PROJECT PROFILE | BOSGRAAF BUILDERS, PRIVATE HOME, SHORES OF LAKE MICHIGAN, MI**

**BUILDER**

Bosgraaf Companies  
297 Douglas Ave.  
Holland, MI  
www.bosgraaf.com

**VAPROSHIELD REPRESENTATIVES**

Architectural Building Products  
Dirk DeJonge  
7608 Clyde Park S.W.  
Byron Center, MI 49315  
(616) 878-4312  
ddejonge@abp-michigan.com

**PRODUCT(S)**  
**WrapShield HS**

**PROJECT DESCRIPTION**

This year-round, private residence is located on the eastern shore of beautiful Lake Michigan. The home will be subjected to the extremes in weather from heat and humidity to high winds and bitter cold. To ensure the home is well protected, the home owner and builder selected WrapShield HS.

WrapShield HS is state-of-the-art breathable, water resistant membrane comprised of WrapShield bonded with Home Slicker® which is a rolled product that creates the necessary airspace forming a rain screen wall system. Home Slicker's unique three-dimensional matrix allows moisture to escape quickly while protecting the sidewall from the damaging effects of mold, mildew and moisture intrusion.

One unique product combining a rain screen membrane with a water resistive barrier that simultaneously saves on labor and material. Suitable for use in commercial, mixed-use and residential construction.



*WrapShield HS close up around window shows its unique three-dimensional matrix allowing moisture to escape quickly while protecting the sidewall from the damaging effects of mold, mildew and moisture intrusion.*

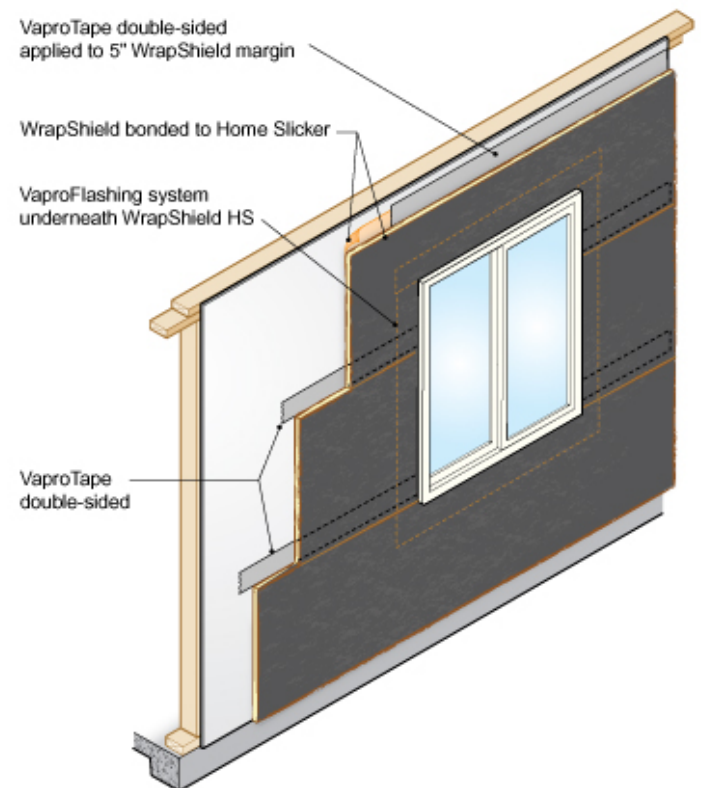

*WrapShield HS detail showing application (above); closeup photo showing tight and "clean" application (left).*



PROJECT PROFILE | BOSGRAAF BUILDERS, PRIVATE HOME, SHORES OF LAKE MICHIGAN, MI



Above: This view is the home faces the Lake Michigan, which will receive the full effects and extremes of Michigan summers and winters.



Above/Below: Completed home with WrapShield HS under multiple veneers.

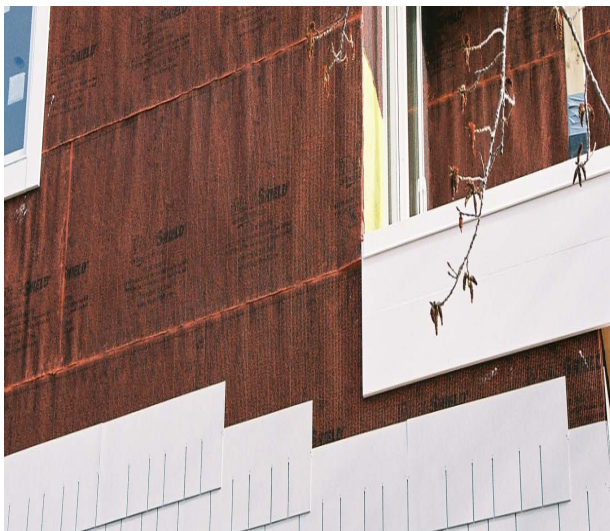

Above: This view is the WrapShield HS application illustrates the coverage, clean application and tight underlayment for trim and siding.

