

Innovative Building Envelope News from VaproShield

# VaproShield Ribbit Review



**NOVEMBER 2015**

**In This Issue:**

- VaproAirBarrier System
- Key Air Barrier Questions
- NFPA 285 Substitutions are Acceptable

**Designated Home for the Original Rules of Basketball**



DeBruce Center's budget was nearly thwarted by a high-priced competitor's building envelope until VaproShield's RevealShield SA Self-Adhered Air Barrier stepped into the game, scoring a win for the DeBruce Center. Over 18,000 sq.ft. of RevealShield SA Self-Adhered saved the project money and kept construction on track.

**An Ode to Oakland's Timeless Mural Art**

WrapShield RS Rain Screen Vapor Permeable Water Resistive Barrier (WRB) and Air Barrier (AB) Membrane was used on the Mural Apartments in Oakland, California to help reduce the occurrence of moisture-related damage behind the stucco. Both energy efficient and easy to install, the air barrier and rain screen  
*Continued on next page*

## VaproAirBarrier System

**CONTRACTOR FRIENDLY**

Contractors and installers only need to manage two components in the field to achieve complete air barrier continuity, drastically reducing training and installation time. And nearly 99% return to reuse the product on the next job.

**COMPETITIVE**

VaproAirBarrier System installed costs average 30-50% less than the typical competitors. Why? We've eliminated the need for any joint/corner treatments, tapes, adhesives, and spray equipment, all equaling reduced costs.

**SUSTAINABLE**

Our system has no VOC's, toxins or red list chemicals and it adheres to the Living Building Challenge's rigorous standards. Installation crews are safe around our products, no respirators or special overalls are required. Scraps and release paper are easily recycled or tossed in on-site refuse containers.

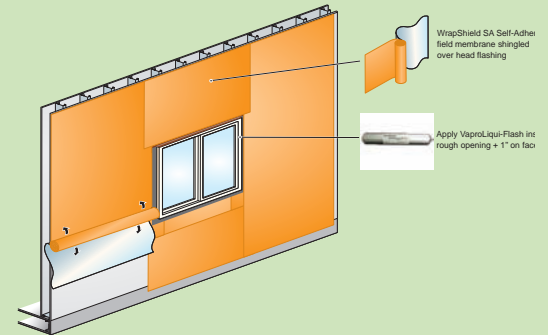

## Key Questions to Ask about an Air Barrier

THE ANSWER IS EASY WITH VAPROSHIELD MEMBRANES!

Q: *What type of joint/corner treatment is required?*

V: **No joint treatment required**

Q: *What type of installation equipment is required?*

V: **Common hand tools**

Q: *What weather restrictions are associated with primer application, spray-on fluid applied and membrane installation?*

V: **Virtually no weather restrictions. Apply VaproShield self-adhered membranes in below freezing temps, mechanically attached in all temps and no primer is ever required.**

Q: *What types of chemicals, VOC's or toxins would the installation team be exposed to during installation?*

V: **None**

Q: *Does your costing model include all the parts and pieces required to install the WRB/Air Barrier, such as primers, flashing, membranes, equipment, tapes, gear, containment screens?*

V: **VaproShield WRB/Air Barrier solutions are on average 30-50%\* less than competitors because there are only 2 components to manage and install.**

\*depends on membrane type, labor rates, job size and number of rough openings.

Innovative Building Envelope News from VaproShield

# VaproShield Ribbit Review



## NOVEMBER 2015

### An Ode to Oakland's Timeless Mural Art

*continued...*



cavities inherent in WrapShield RS Rain Screen work to dry out cementitious building materials through a built-in drainage matrix.

### The Frog from Down Under

Resting in the heart of Christchurch, New Zealand is the Christchurch Bus Interchange, where over 24,800 sq.ft. of VaproShield's durable RevealShield SA Self-Adhered membrane was installed behind three different cladding types and cedar planks.



### Who is VaproShield?

We design and manufacture high performance vapor permeable water resistive barriers (WRB) and air barrier (AB) membranes and accessories, creating a total solution-based approach to protecting the building envelope.

## WrapShield SA Outperforms Competitors

### EASY TO INSTALL EVEN IN COLD WEATHER CLIMATES

The Banks Phase II project switched to WrapShield SA Self-Adhered Water Resistive Vapor Permeable Air Barrier Membrane because of its versatile nature and ability to endure installation in temperatures that proved too cold for its fluid-applied rival.



Banks Phase II | Cincinnati, OH

WrapShield SA Self-Adhered offers:

- High drying capacity, 50 perms
- Ability to bridge joints, gaps and holes
- No expensive installation equipment

## Ribbit Resource

### NFPA 285 SUBSTITUTIONS ARE ACCEPTABLE

Author Richard Keleher notes in an *The National Institute of Building Sciences, Aug 2015* article, that NFPA 285 requires the entire wall assembly to be tested [expensive, impractical and few total assemblies have been tested]. Further he says, "unfortunately, some manufacturers... have taken the opportunity to market their products as meeting NFPA. This is misleading: No single product meets NFPA 285, only assemblies meet the code."

An alternative is to have **"the design reviewed by an engineer who can provide a letter stating the changed products will perform as well as the products actually tested."** He also points out that self-adhered, rubberized asphalt-based WRB assemblies have not been tested.



**Since all VaproShield membranes are non-asphaltic and have a Class A Fire Rating, any VaproShield membrane would be an acceptable WRB/Air Barrier alternative in an NFPA 285 assembly.**

Review the entire article by Keleher at [vaproshield.com/technicallibrary](http://vaproshield.com/technicallibrary) or contact the VaproShield Technical Team for further insights, 866-731-7663 opt. 5.